

SECTIONS NOTES:

- THIS DRAWING MUST NOT BE SCALED
- THIS DRAWING IS TO BE READ IN CONJUNCTION WITH ALL OTHER PROJECT DRAWINGS
- ALL DETAILS AND DRAWINGS MUST BE READ IN CONJUNCTION WITH THE "BELLWAY SPECIFICATION"
- CONSTRUCTION OF STAIR GUARDING MUST BE SUCH THAT A 100mm DIAMETER SPHERE CANNOT PASS THROUGH ANY OPENING AND MUST RESIST A HORIZONTAL FORCE OF 0.36KN PER METRE.
- BALUSTRADE AND STAIRS SHOWN ARE INDICATIVE ONLY EXACT CONSTRUCTION TO MANUFACTURERS DETAILS
- BALUSTERS TO BE MANUFACTURED PREFABRICATED.
- TURNED BALUSTERS AND SQUARE NEWELS ARE TO BE AS STANDARD.
- FOR BULKHEAD DETAILS SEE STANDARD DETAIL REFER TO DET A/SD/S40/A/01
- TIMBER TO COMPLY WITH BS1186: PART 1, CLASS 2 FOR PAINTED FINISH.
- STAIR MUST BE DESIGNED IN ACCORDANCE WITH BS 585 PART 1 1989, BS 5395 PART 1 1977 PART 2 1984 BS 6180 1982 APPROVED DOCUMENT 'K' HANDRAIL HEIGHT 900mm MIN. ABOVE PITCH LINE
- BALUSTRADE HEIGHT 900mm MIN. ABOVE FFL WIDTH 900mm O/A STRINGS

GAS MEMBRANE REQUIRED:

MIN 2000g DPM/REINFORCED DPM REQUIRED TO JETFLOOR SYSTEM WITH JOINTS & PENETRATIONS SEALED AND UNDERFLOOR VENTING. ALL TO BE DESIGNED AND INSTALLED BY A COMPETENT SUBCONTRACTOR IN ACCORDANCE WITH BISON DETAILS, INSTALLATION VERIFICATION PROVIDED.

FLOOR CONSTRUCTION:

REFER TO SEPARATE DRAWING BY JOIST SUPPLIER FOR FLOOR PLAN SETTING OUT & CONSTRUCTION DETAILS

INTERNAL FLOOR CONSTRUCTION FIRST FLOOR:

TO ACHIEVE MIN 40DB RATING
 -22mm EGGER PROTECT T&G PARTICLEBOARD INSTALLED IN ACCORDANCE WITH EGGER ADVANCED FLOORING SYSTEM FITTING METHOD
 -240mm DEEP S4/S60/90 ENGINEERED TIMBER JOISTS AT 600mm CENTRES.
 -15mm PLASTERBOARD (10KG/M2 MIN. MASS PER UNIT AREA).
 FOR EXPOSED CEILING INTEGRAL GARAGE REFER TO DETAIL A/SD/S60/A/01
 220 mm KNAUF EARTHWOOL OMNIFIIT STUD ROLL (THERMAL CONDUCTIVITY 0.34W/mK) LAID BETWEEN JOIST
 70mm CELOTEX GA400PIR INSULATION UNDER THE JOIST
 15 mm BRITISH GYPSUM PLASTERBOARD

PRECAUTIONS IN ACCORDANCE WITH BRE BR 262: THERMAL INSULATION: AVOIDING RISKS SECTION 2.3 TO BE ADOPTED WHERE INSTALLING INSULATION AROUND ELECTRICAL FITTINGS OR OTHER SOURCES OF HEAT

TIMBER STAIR

GROUND FLOOR TO FIRST FLOOR:
 13 No. RISERS - 204.7mm
 TOTAL RISE - 2662mm
 GOING - 228mm
 OVERALL STRINGS - 900mm
 PITCH 41.55 degrees

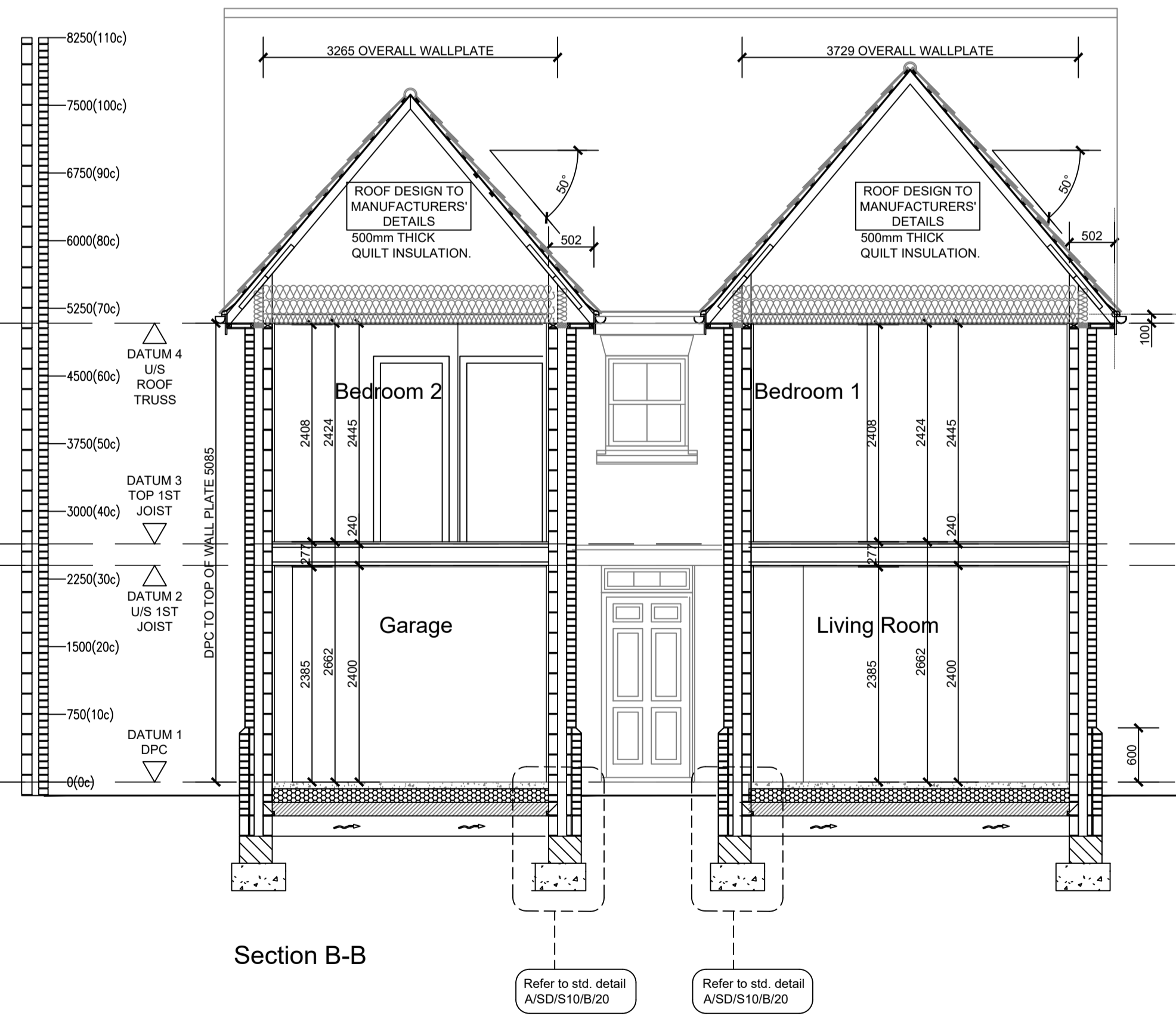
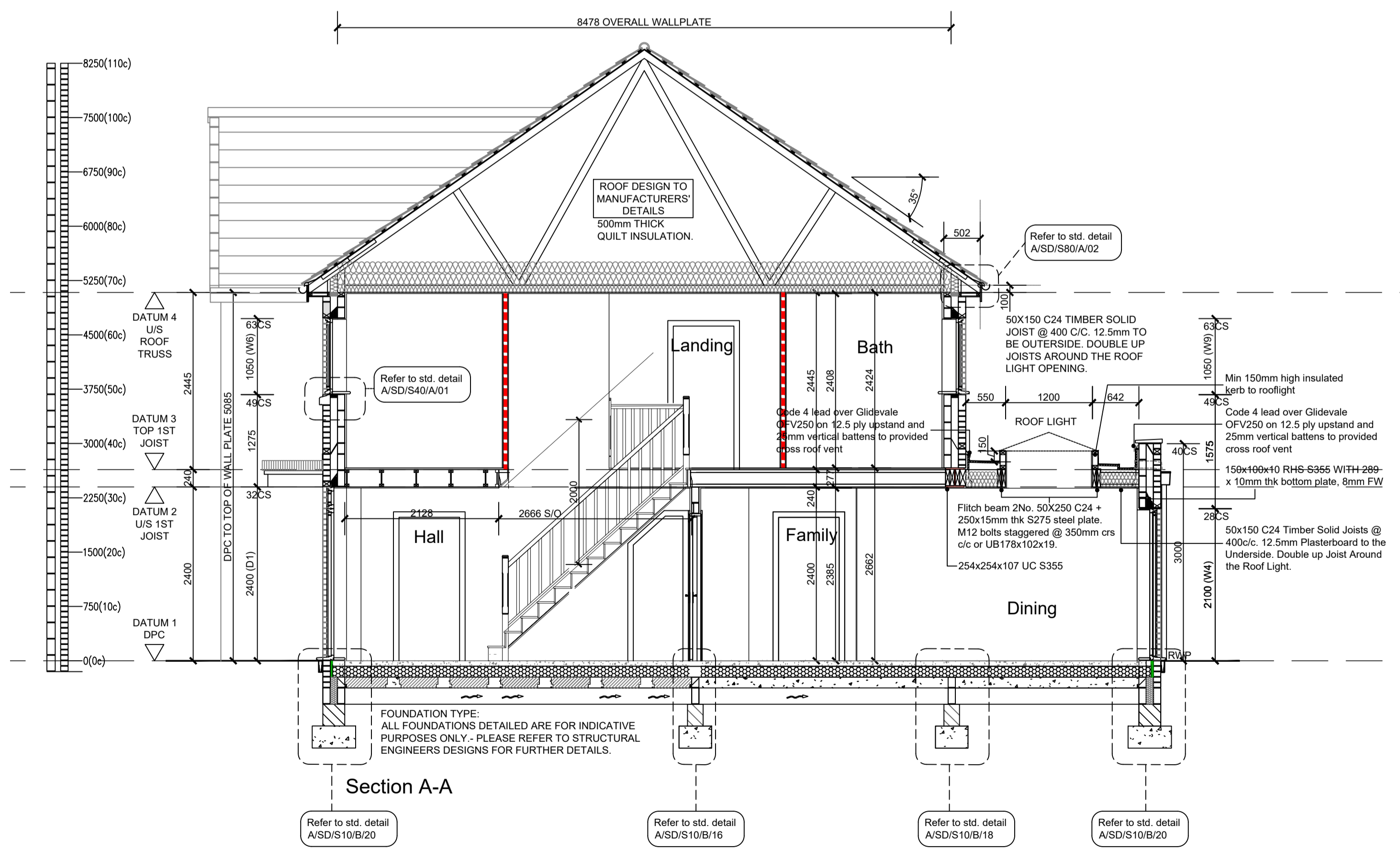

WADP Limited Registered in England No. 4564928
 Registered office: Station House, Connaught Road, Brookwood, GU24 0ER

RIBA CHARTERED PRACTICE
 NUMBER 20000159

Drawings not to be scaled.
 Work to figured dimensions only.
 All dimensions to be checked on site, and any discrepancies reported to the Architect immediately

All drawings are to be read in conjunction the BELLWAY Company Specification and Project Specifications, Company Standard Details and with the current Building Regulations and Codes of Practice.

It is the Contractor's responsibility to ensure that all works are carried out in accordance with the same.

All concrete work to be carried out in accordance with BS EN 1992-1-1:2004.

All brickwork and blockwork to be carried out in accordance with BS EN 1996-1-2:2005.

All structural steelwork to be carried out in accordance with BS EN 1993-1-1:2005 Steelwork to be Grade S275.

All structural timber to be used in accordance with BS EN 1995-1-1:2004 and is to be preservative treated in accordance with BS4072.

All plumbing to be in accordance with BS6700, BS EN 12056, BS6465:Part 1 and BS6367.

All glass falling within critical zones as defined by Part N of the Building Regulations is to be toughened or safety glass in accordance with BS EN 12600

All building works to be undertaken in accordance with Robust Enhanced Accredited Details.



62 Well Lane
 Horsell
 Woking
 Surrey
 GU21 4PS

Telephone: 01483 763028
 e-mail info@wadp.co.uk



REGENT'S GATE
 VIRGINIA WATER SOUTH

THE OAKMONT
 Sections

1:50 @ A1
 MAY 2024
 DK
 WADP-126_THE OAKMONT C1