

- 13 AMP TWIN SWITCHED SOCKET OUTLET
- 13 AMP UNSWITCHED SOCKET OUTLET
- 13 AMP UNSWITCHED SOCKET OUTLET WITH
- HAND WIRED 13 AMP UNSWITCHED SPUR
- 13 AMP UNSWITCHED SPUR
- 13 AMP SINGLE POLE SWITCHED FUSED SPUR CONNECTION
- 13 AMP SINGLE SOCKET OUTLET ABOVE WORKTOP
- 13 AMP TWIN SWITCHED SOCKET & 3x USB OUTLET ABOVE WORKTOP (1x Type C + 2x Type A)
- 13 AMP TWIN SWITCHED SOCKET & USB
- ONE WAY SWITCH
- TWO WAY SWITCH
- LIGHT SWITCH INTERMEDIATE
- COOKER SWITCH
- MULTI SWITCH PANEL (TO ALL APPLIANCES)
- 12VDC MEDIA PLATE (COAXIAL, SERIAL, 2X CAT5, DATA, 2X SATELLITE & 2X 13A DOUBLE SOCKET OUTLETS)
- D = CATE side 2 MODULE (4 MODULE)
- A = Co-axial serial
- Hot Water Cylinder Connection Box (BLANK FACEPLATE)
- 25A DP SWITCH FUSED OUTLET W/ NEON INDICATOR (FOR AMERICAN HEATERS)
- SHOWER POINT AS SITE SPEC
- CEILING LIGHTING POINT - PENDANT TYPE
- CEILING LIGHTING POINT - BATTEN HOLDER FITTING
- IP65 RECESSED SPOTLIGHT
- EXTERNAL WALL MOUNTED LIGHT FITTING
- CONTINUOUS RUNNING EXTRACT FAN
- CM = CEILING MOUNTED EXTRACT FAN
- WM = WALL MOUNTED EXTRACT FAN
- REGULATING COOKER HOOD
- 3 POLE ISOLATOR SWITCH FOR EXTRACT MARKED WITH FAN SYMBOL
- PROGRAMMABLE ROOM THERMOSTAT
- RADIATORS - REFER TO HEATING DESIGNS
- HEATED TOWEL RAIL - REFER TO HEATING DESIGNS
- SMOKE DETECTOR MIN. 300mm BETWEEN LIGHT & HD
- HEAT DETECTOR MIN. 300mm BETWEEN LIGHT & HD
- CO DETECTOR WALL MOUNTED CO DETECTOR (INSTALLED @ 2000MM ABOVE FFL)
- GENERAL NOTE: - HAZD REQUIRES ALL ELECTRICAL ITEMS TO HAVE A MIN CLEAR ACCESS

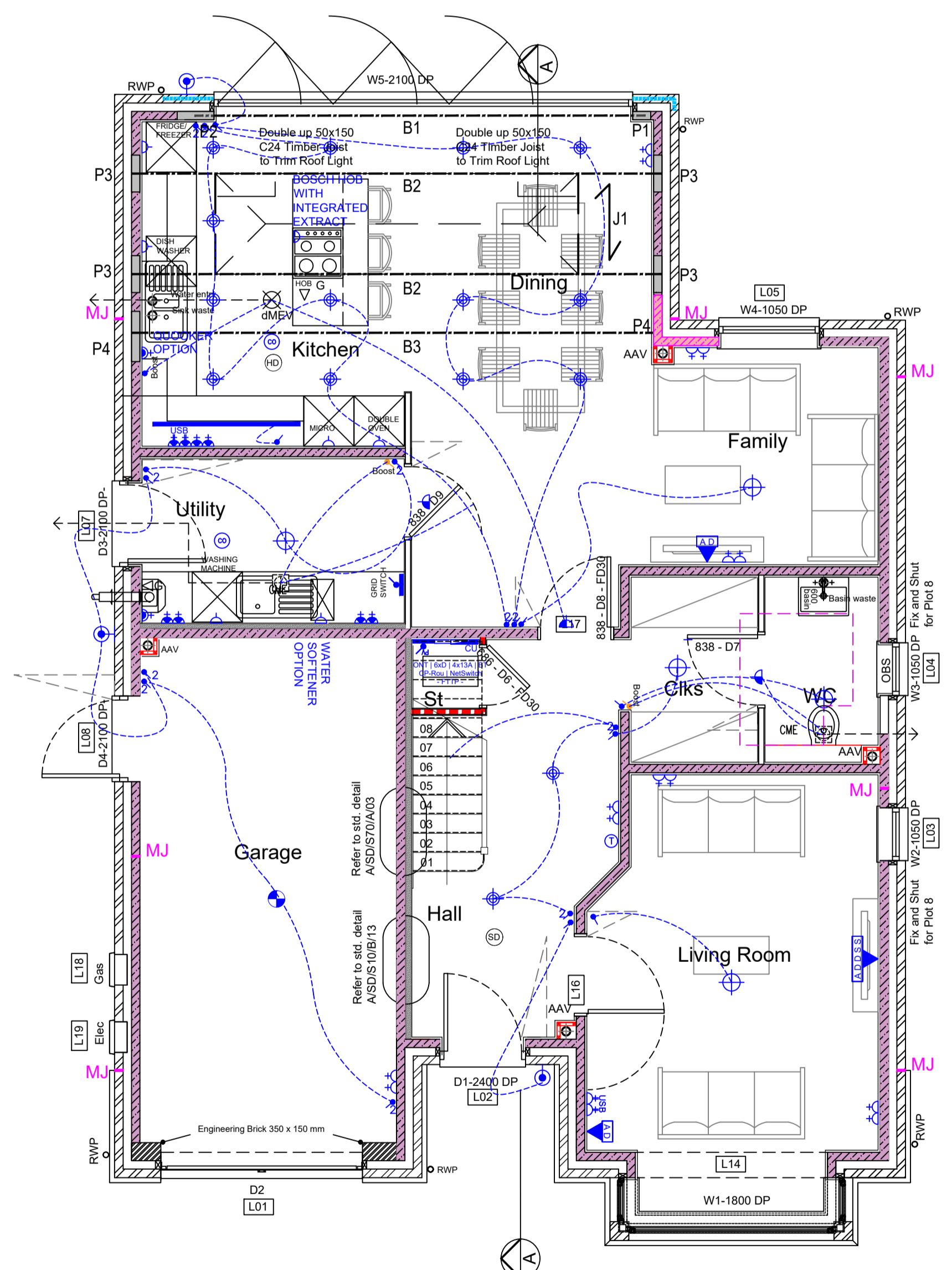

Ground Floor Plan Plot 9

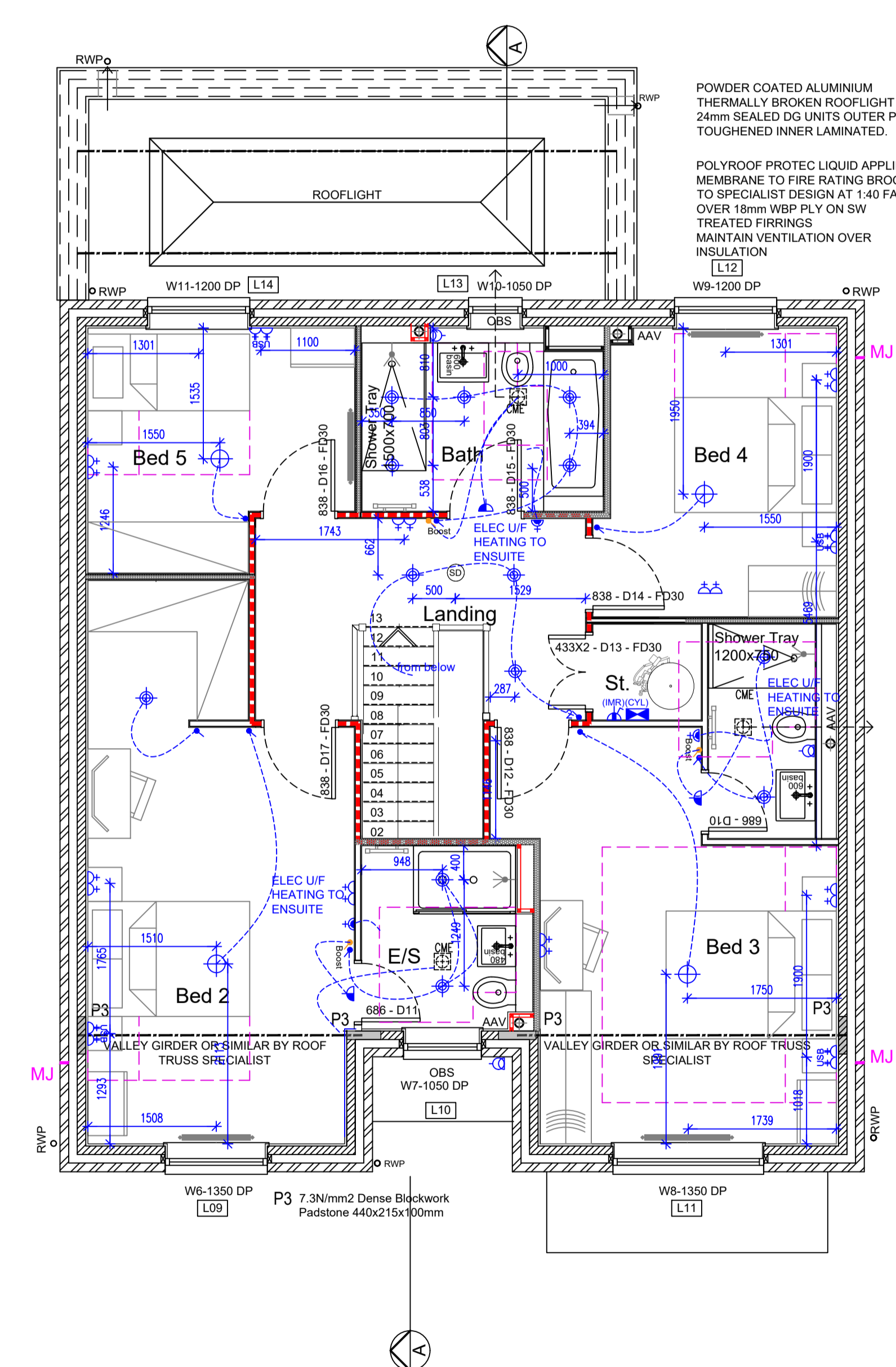

First Floor Plan Plot 9

WADP Limited Registered in England No. 4564928
 Registered office: Station House, Cornaught Road, Brookwood, GU24 0ER

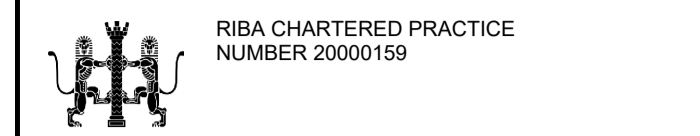

RIBA CHARTERED PRACTICE
 NUMBER 20000159

Drawings not to be scaled.
 Work to figured dimensions only.
 All dimensions to be checked on site, and any discrepancies reported to the Architect immediately

All drawings are to be read in conjunction with the BELLWAY Company Specification and Project Specifications, Company Standard Details and with the current Building Regulations and Codes of Practice.

It is the Contractor's responsibility to ensure that all works are carried out in accordance with the same.

All concrete work to be carried out in accordance with BS EN 1992-1-1:2004.

All brickwork and blockwork to be carried out in accordance with BS EN 1996-1-2:2005.

All structural steelwork to be carried out in accordance with BS EN 1993-1-1:2005 Steelwork to be Grade S275.

All structural timber to be used in accordance with BS EN 1995-1-1:2004 and is to be preservative treated in accordance with BS4072.

All plumbing to be in accordance with BS6700, BS EN 12056, BS6465:Part 1 and BS6367.

All glass falling within critical zones as defined by Part N of the Building Regulations is to be toughened or safety glass in accordance with BS EN 12600

All building works to be undertaken in accordance with Robust Enhanced Accredited Details.



62 Well Lane
 Horsell
 Woking
 Surrey
 GU21 4PS

Telephone: 01483 763028
 e-mail info@wadp.co.uk



REGENT'S GATE
 VIRGINIA WATER SOUTH

THE OAKMONT
 Ground & First Floor Plan
 Services

1:50 @ A1

MARCH 2024

CB

WADP-124_THE OAKMONT C1