

WALL MATERIAL LEGEND:	
<b>EXTERNAL &amp; LOADBEARING WALLS</b> STRENGTH AND DENSITY TO STRUCTURAL ENG. SPEC.	
	INDICATES FACE BRICKWORK
	INDICATES 100mm BLOCKWORK WITH 7.3N/mm <sup>2</sup> STRENGTH AND MAXIMUM 1600 KG/M <sup>3</sup> DENSITY O.N.O.
	INDICATES 100mm BLOCKWORK WITH 3.6N/mm <sup>2</sup> STRENGTH AND MAXIMUM 1600 KG/M <sup>3</sup> DENSITY O.N.O.
	INDICATES 100mm BLOCKWORK WITH 17.5N/mm <sup>2</sup> STRENGTH AND MAXIMUM 1600 KG/M <sup>3</sup> DENSITY O.N.O.
	BED JOINT REINFORCEMENT - EXPAMET LADDER REINFORCEMENT SBSF3560 @ 225 VERTICAL CRS, SPANNING 600mm PAST OPENING
<b>PARTY WALLS</b>	
	INDICATES 100mm LIGHTWEIGHT AGGREGATE BLOCKWORK WITH 3.6N/mm <sup>2</sup> STRENGTH AND MAXIMUM 1600 KG/M <sup>3</sup> DENSITY O.N.O. & BED JOINT REINFORCEMENT FOR ROBUST STANDARD DETAIL: E-WM-30
<b>INTERNAL WALLS</b>	
	INDICATES 100mm BLOCKWORK WITH 7.3N/mm <sup>2</sup> STRENGTH AND MAXIMUM 1600 KG/M <sup>3</sup> DENSITY O.N.O.
	INTERNAL BLOCKWORK PARTITION BETWEEN DWELLING AND GARAGE. 100mm AERATED CONCRETE STRENGTH TO STRUCTURAL ENG. SPEC. 63mm BRITISH GYPSUM THERMALINE FIR PLASTERBOARD ON ADHESIVE DABS. REFER TO A/SD/S10B/13
	INDICATES O/A 88mm STRUCTURAL TIMBER PARTITION COMPRISING 12.5mm PLASTERBOARD 11mm OSB2 SHEATHING ON BOTH SIDES OF 63x38 mm TIMBER STUD (STUDS AND NOGGINGS ROTATED THROUGH 90°). REFER TO A/AS/S50/B/01 TO 05
	INDICATES 88mm OVERALL THICKNESS COMPRISING 63x38mm TIMBER STUD WITH 12.5mm PLASTERBOARD EITHER SIDE.
	INDICATES O/A 88 mm TIMBER ACOUSTIC STUDWORK PARTITION 63 X 38mm TIMBER STUDS, WITH 65mm THICK ISOVER APR 1200 ACOUSTIC INSULATION PACKED BETWEEN
	INDICATES HALF HOUR FIRE RESISTANCE TO STUD PARTITION 88mm OVERALL THICKNESS COMPRISING 63x38 mm TIMBER STUD WITH 12.5mm WALLBOARD EITHER SIDE.

- J1 50x150 C24 Timber Solid Joists @ 400c/c. 12.5mm Plasterboard to the Underside. Double up Joist Around the Roof Light.
- P1 215x215x100 C50 concrete padstone
- P2 440x215x100 C50 concrete padstone
- P3 7.3N/mm<sup>2</sup> Dense Blockwork Padstone 440x215x100mm
- P4 600x215x100 C50 Concrete Padstone or 600x215x102.5mm or Class A 125N/mm<sup>2</sup> Engineering Blue Solid Brck Class II (M6) Mortar
- B1 150x100x10 RHS S355 WITH 289 x 10mm thk bottom plate, 8mm FW
- B2 Fitch beam 2No. 50x250 C24 + 250x15mm thk S275 steel plate. M12 bolts staggered @ 350mm crs c/c or UB178x102x19.
- B3 254x254x107 UC S355

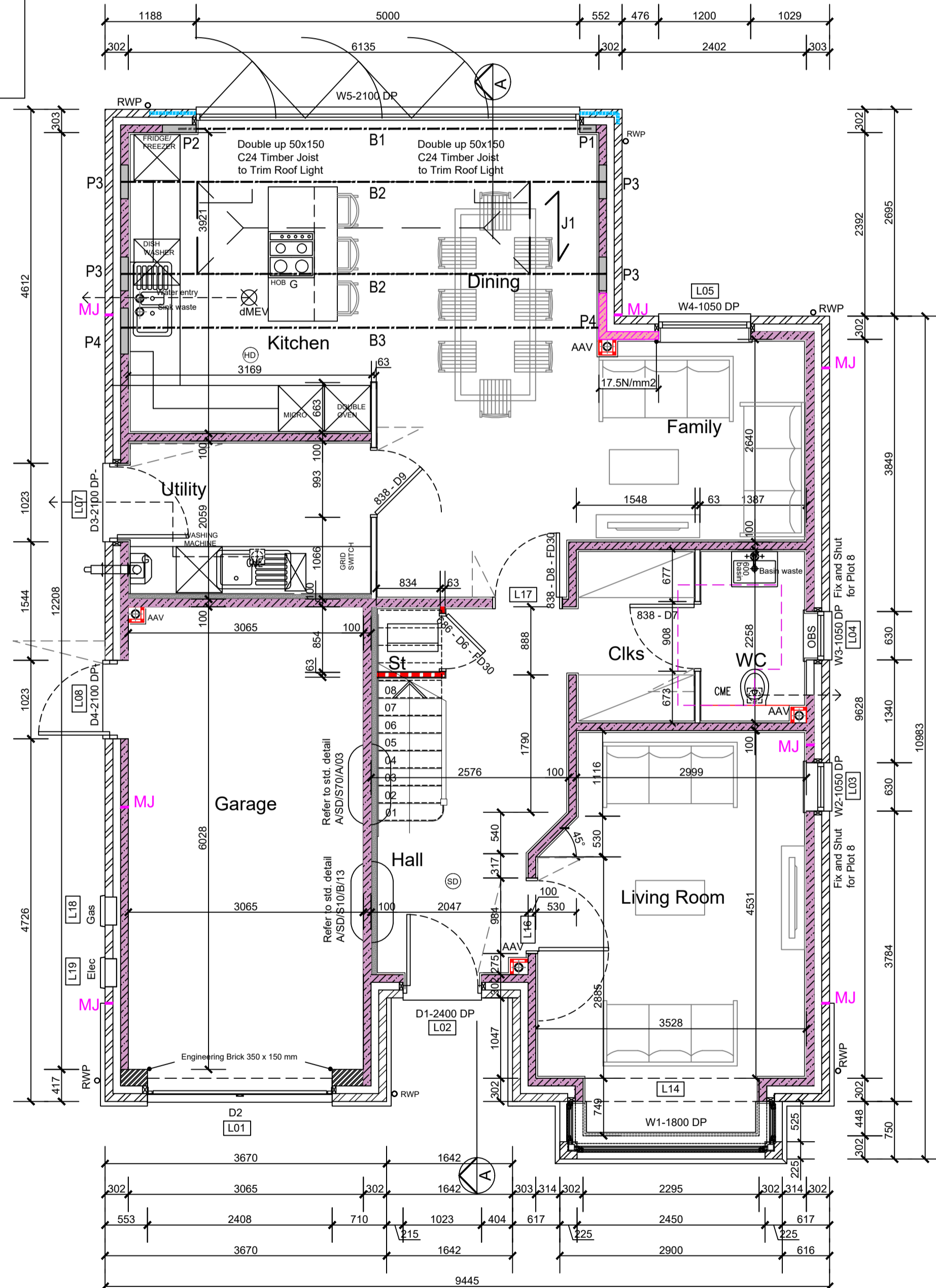

Ground Floor Plan Plot 9

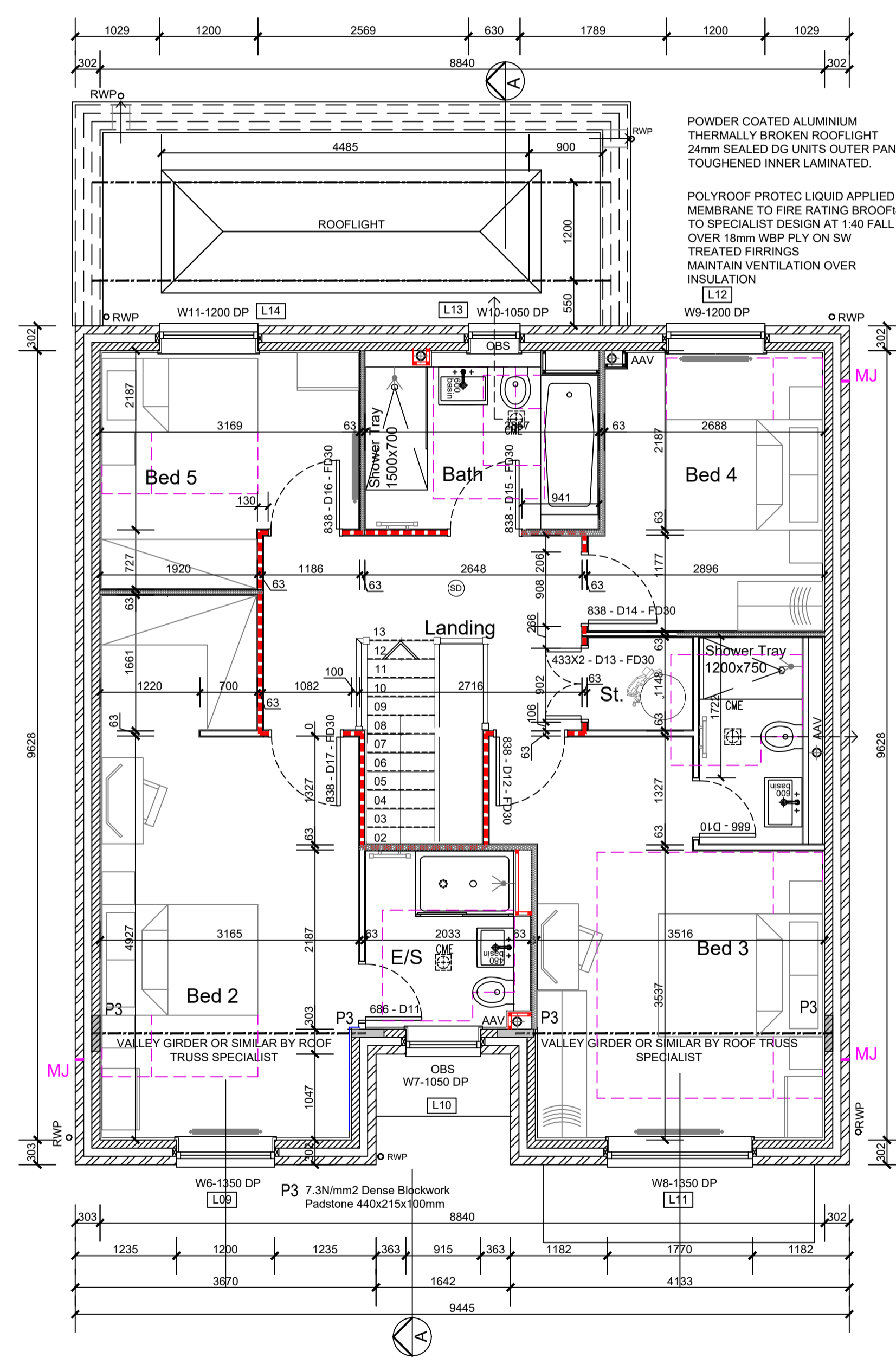

First Floor Plan Plot 9

WADP Limited Registered in England No. 4564928  
Registered office: Station House, Cornnaught Road, Brookwood, GU24 0ER

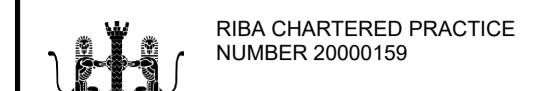

RIBA CHARTERED PRACTICE  
NUMBER 20000159

Drawings not to be scaled.  
Work to figured dimensions only.  
All dimensions to be checked on site, and any discrepancies reported to the Architect immediately

All drawings are to be read in conjunction the BELLWAY Company Specification and Project Specifications, Company Standard Details and with the current Building Regulations and Codes of Practice.

It is the Contractor's responsibility to ensure that all works are carried out in accordance with the same.

All concrete work to be carried out in accordance with BS EN 1992-1-1:2004.

All brickwork and blockwork to be carried out in accordance with BS EN 1996-1-2:2005.

All structural steelwork to be carried out in accordance with BS EN 1993-1-1:2005 Steelwork to be Grade S275.

All structural timber to be used in accordance with BS EN 1995-1-1:2004 and is to be preservative treated in accordance with BS4072.

All plumbing to be in accordance with BS6700, BS EN 12056, BS6465:Part 1 and BS6367.

All glass falling within critical zones as defined by Part N of the Building Regulations is to be toughened or safety glass in accordance with BS EN 12600

All building works to be undertaken in accordance with Robust Enhanced Accredited Details.



62 Well Lane  
Horsell  
Woking  
Surrey  
GU21 4PS

Telephone: 01483 763028  
e-mail info@wadp.co.uk



REGENT'S GATE  
VIRGINIA WATER SOUTH

THE OAKMONT  
Ground & First Floor Plan

1:50 @ A1

MARCH 2024

DK

WADP-123\_THE OAKMONT C1