

- 13 AMP TWIN SWITCHED SOCKET OUTLET
 - 13 AMP UN SWITCHED SOCKET OUTLET - (BY REQUEST) (SEE SPECIFICATION FOR DETAILS)
 - HARD WIRED 13 AMP UN SWITCHED SPUR CONNECTION
 - 13A SINGLE DOUBLE POLE SWITCHED FUSED SPUR CONNECTION
 - 13 AMP SINGLE SOCKET OUTLET ABOVE WORKTOP
 - 13 AMP TWIN SWITCHED SOCKET OUTLET ABOVE WORKTOP
 - 13 AMP TWIN SWITCHED SOCKET & 3A USB OUTLET ABOVE WORKTOP (1x Type C - 2x Type A)
 - 13 AMP TWIN SWITCHED SOCKET & USB
 - ONE WAY SWITCH
 - TWO WAY SWITCH
 - LIGHT SWITCH INTERMEDIATE
 - COOKER SWITCH
 - MULTI SWITCH PANEL (TO ALL APPLIANCES)
 - LOW VOLT MEDIA PLATE COAXIAL AERIAL, 2X CAT5E DATA, 2X SATELLITE & 2X 13A DOUBLE SOCKET OUTLETS
 - D = CAT5 wire
 - 2 MODULE 1/4 MODULE
 - A = Co-axial aerial
 - = Blank
 - HOT WATER CYLINDER CONNECTION BOX (BLANK FACEPLATE)
 - 20A DP SWITCH FLEX OUTLET W/ NEON INDICATOR FOR IMMERSION HEATER
 - SHOWER POINT AS SITE SPEC
 - CEILING LIGHTING POINT - PENDANT TYPE
 - CEILING LIGHTING POINT - BATTEN HOLDER FITTING
 - IP65 RECESSED SPOTLIGHT
 - EXTERNAL WALL MOUNTED LIGHT FITTING
 - CONTINUOUS RUNNING EXTRACT FAN
 - CM+ CEILING MOUNTED EXTRACT FAN
 - VM+ WALL MOUNTED EXTRACT FAN
 - RECIRCULATING COOKER HOOD
 - 3 POLE ISOLATOR SWITCH FOR EXTRACT MARKED WITH FAN SYMBOL
 - PROGRAMMABLE ROOM THERMOSTAT
 - RADIATORS (R) - REFER TO HEATING DESIGNS
 - HEATED TOWEL RAIL - REFER TO HEATING DESIGNS
 - SMOKE DETECTOR (MND) 300mm BETWEEN LIGHT & SDI
 - HEAT DETECTOR (MND) 300mm BETWEEN LIGHT & HDI
 - CO DETECTOR WALL MOUNTED CO DETECTOR (INSTALLED @ 2000MM ABOVE FFL)
 - ETIP K&L: OPTICAL NETWORK TERMINATION UNIT - COMPLETE WITH BATTERY BACKUP UNIT (BBU)
 - CM+Roof: CUSTOMER PROVIDED ROOFER
 - NetSwitch: CUSTOMER PROVIDED UNMANAGED GIGABIT NETWORK SWITCH
- GENERAL NOTE: MNDI REQUIRES ALL ELECTRICAL ITEMS TO HAVE A MIN CLEAR ACCESS

BED JOINT REINFORCEMENT TO THE INNER BLOCKWORK LEAF FOR THE FULL HEIGHT OF THE GF WALL: EXPAMET SBSF 3560 (OR SIMILAR APPROVED) @ 225mm VERTICAL C/C

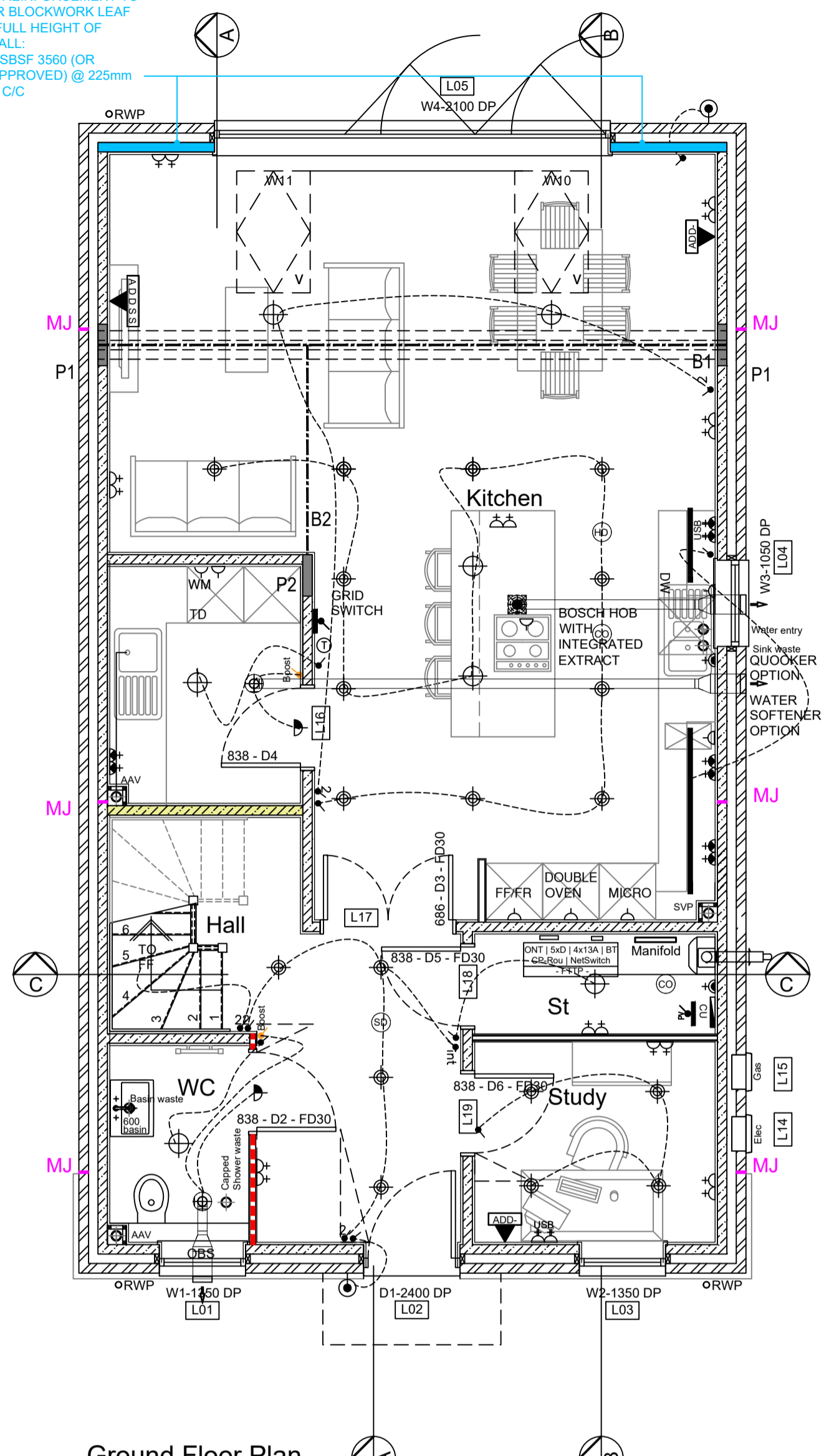

Ground Floor Plan
Plots: 6, 7 & 12 As
Plot: 11 Handed

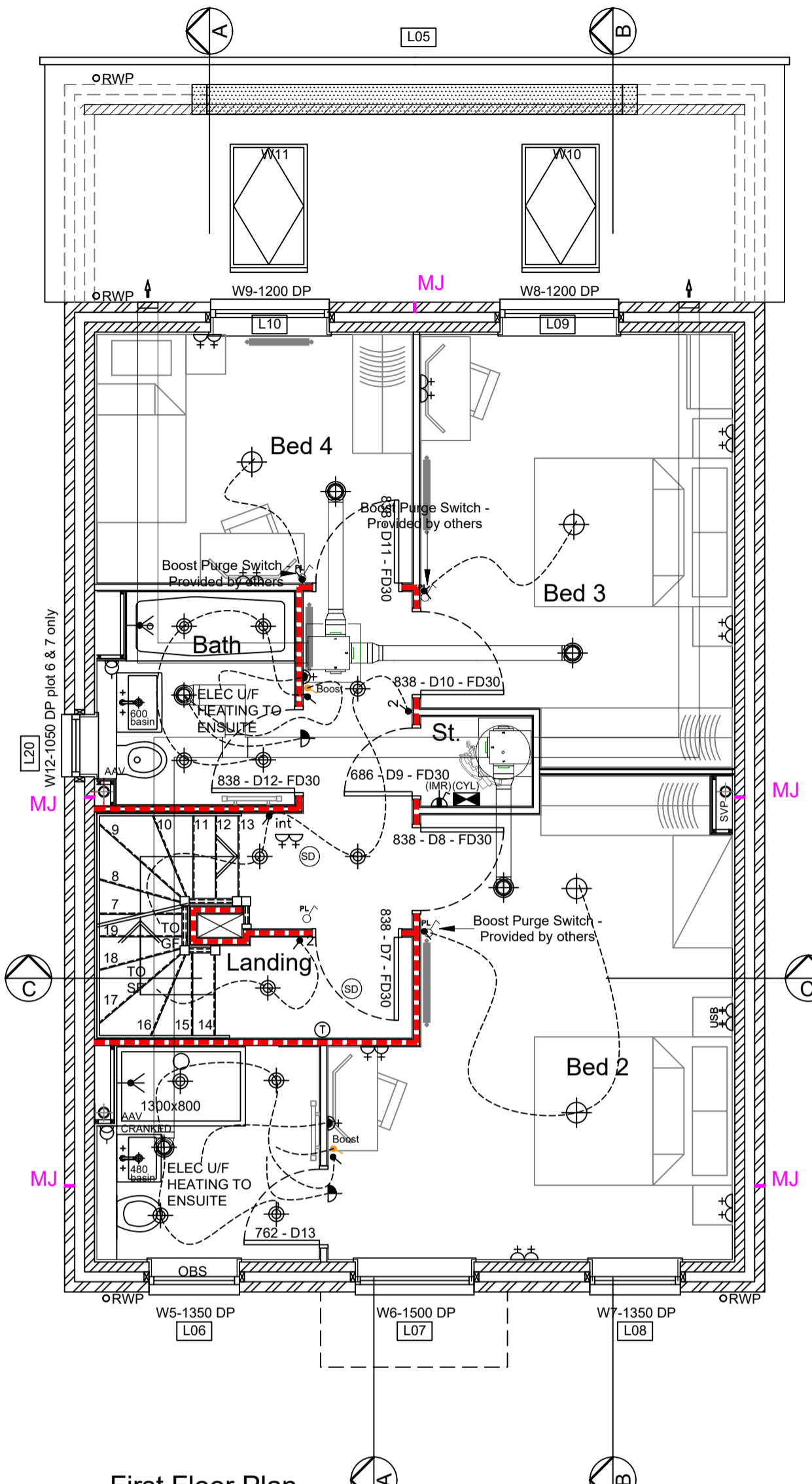

First Floor Plan
Plots: 6, 7 & 12 As
Plot: 11 Handed

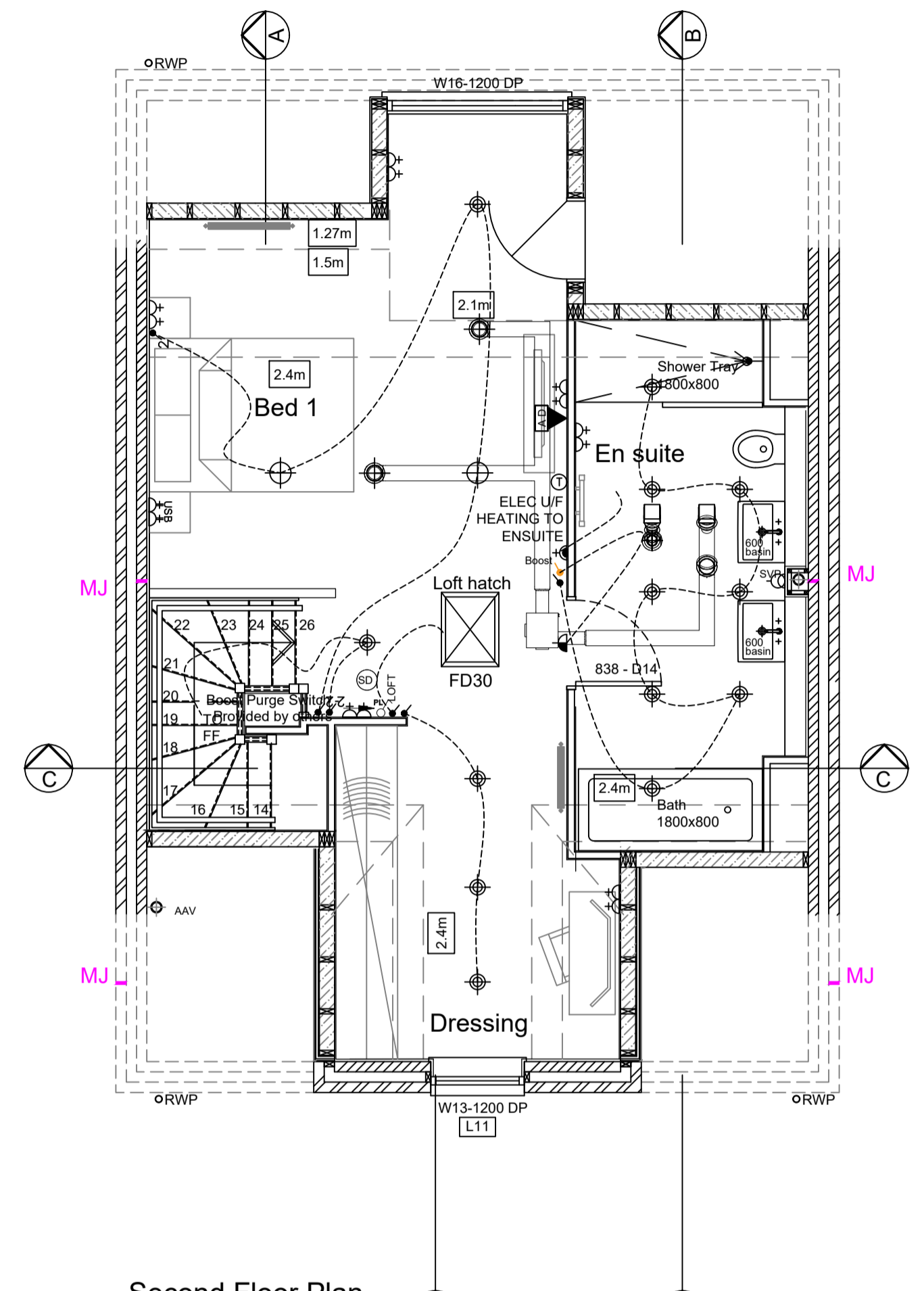

Second Floor Plan
Plots: 6, 7 & 12 As
Plot: 11 Handed

WADP Limited Registered in England No. 4564928
Registered office: Station House, Connaught Road, Brookwood,
GU24 0ER

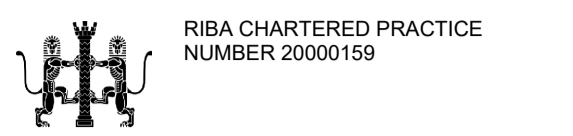

Drawings not to be scaled.
Work to figured dimensions only.
All dimensions to be checked on site, and any discrepancies reported to the Architect immediately

All drawings are to be read in conjunction the BELLWAY Company Specification and Project Specifications, Company Standard Details and with the current Building Regulations and Codes of Practice.

It is the Contractor's responsibility to ensure that all works are carried out in accordance with the same.

All concrete work to be carried out in accordance with BS EN 1992-1-1:2004.

All brickwork and blockwork to be carried out in accordance with BS EN 1996-1-2:2005.

All structural steelwork to be carried out in accordance with BS EN 1993-1-1:2005 Steelwork to be Grade S275.

All structural timber to be used in accordance with BS EN 1995-1-1:2004 and is to be preservative treated in accordance with BS 4072.

All plumbing to be in accordance with BS6700, BS EN 12056, BS6465:Part 1 and BS6367.

All glass falling within critical zones as defined by Part N of the Building Regulations is to be toughened or safety glass in accordance with BS EN 12600

All building works to be undertaken in accordance with Robust Enhanced Accredited Details.

WADP

ARCHITECTS

62 Well Lane
Horsell
Woking
Surrey
GU21 4PS

Telephone: 01483 763028
e-mail info@wadp.co.uk



VIRGINIA WATER SOUTH
REGENT'S GATE

THE TURNBERRY
Floor Plans Services

1:50 @ A1 ← 60mm @ A1 →

May 2024

CB

WADP-226_THE TURNBERRY C2