

WALL MATERIAL LEGEND:	
<b>EXTERNAL &amp; LOADBEARING WALLS</b> STRENGTH AND DENSITY TO STRUCTURAL ENG. SPEC.	
	INDICATES FACE BRICKWORK.
	INDICATES 100mm BLOCKWORK WITH 7.3N/mm² STRENGTH AND MAXIMUM 1600 KG/M³ DENSITY O.N.O.
	INDICATES 100mm BLOCKWORK WITH 3.6N/mm² STRENGTH AND MAXIMUM 1600 KG/M³ DENSITY O.N.O.
<b>PARTY WALLS</b>	
	INDICATES 100mm AIRCRETE BLOCKWORK WITH 7.3N/mm² STRENGTH AND 600-800 KG/M³ DENSITY O.N.O. & BED JOINT REINFORCEMENT FOR ROBUST STANDARD DETAIL : E-WM-30
	INDICATES 100mm AIRCRETE BLOCKWORK WITH 3.6N/mm² STRENGTH AND 600-800 KG/M³ DENSITY O.N.O. & BED JOINT REINFORCEMENT FOR ROBUST STANDARD DETAIL : E-WM-30
<b>INTERNAL WALLS</b>	
	INDICATES 100mm BLOCKWORK WITH 7.3N/mm² STRENGTH AND MAXIMUM 1600 KG/M³ DENSITY O.N.O.
	INDICATES 100mm BLOCKWORK WITH 7.3N/mm² STRENGTH AND MAXIMUM 850 KG/M³ DENSITY O.N.O.
	INDICATES O/A 88mm STRUCTURAL TIMBER PARTITION COMPRISING 12.5mm PLASTERBOARD 11mm OSB2 SHEATHING ON BOTH SIDES OF 63X38 mm TIMBER STUD (STUDS AND NOGGINGS ROTATED THROUGH 90°). REFER TO A/SD/ISO/B/01 TO 05
	INDICATES 88mm OVERALL THICKNESS COMPRISING 63X38mm TIMBER STUD WITH 12.5mm PLASTERBOARD EITHER SIDE.
	INDICATES O/A 88 mm TIMBER ACOUSTIC STUDWORK PARTITION 63 X 38mm TIMBER STUDS, WITH 65mm THICK ISOVER APR 1200 ACOUSTIC INSULATION PACKED BETWEEN
	INDICATES HALF HOUR FIRE RESISTANCE TO STUD PARTITION 88mm OVERALL THICKNESS COMPRISING 63X38 mm TIMBER STUD WITH 12.5mm WALLBOARD EITHER SIDE.
	MJ MOVEMENT JOINTS TO STRUCTURAL ENG DETAIL AND BELLWAY DETAILS A/S/S20/A/02&03
	INNER LEAF MJ - 10mm JOINT FORMED WITHIN THE LONGER BLOCKWORK ELEVATIONS WITH BITUMEN IMPREGNATED FLEXIBLE BOARD WITH A 20mm DEEP POLYSULFIDE SEALANT, TIED ACROSS JOINT AT 225mm VERTICAL C/C WITH FLAT-STRIP DEBONDED TIES, GYPROC OR SIMILAR APPROVED CONTROL JOINT FOR PLASTERBOARD

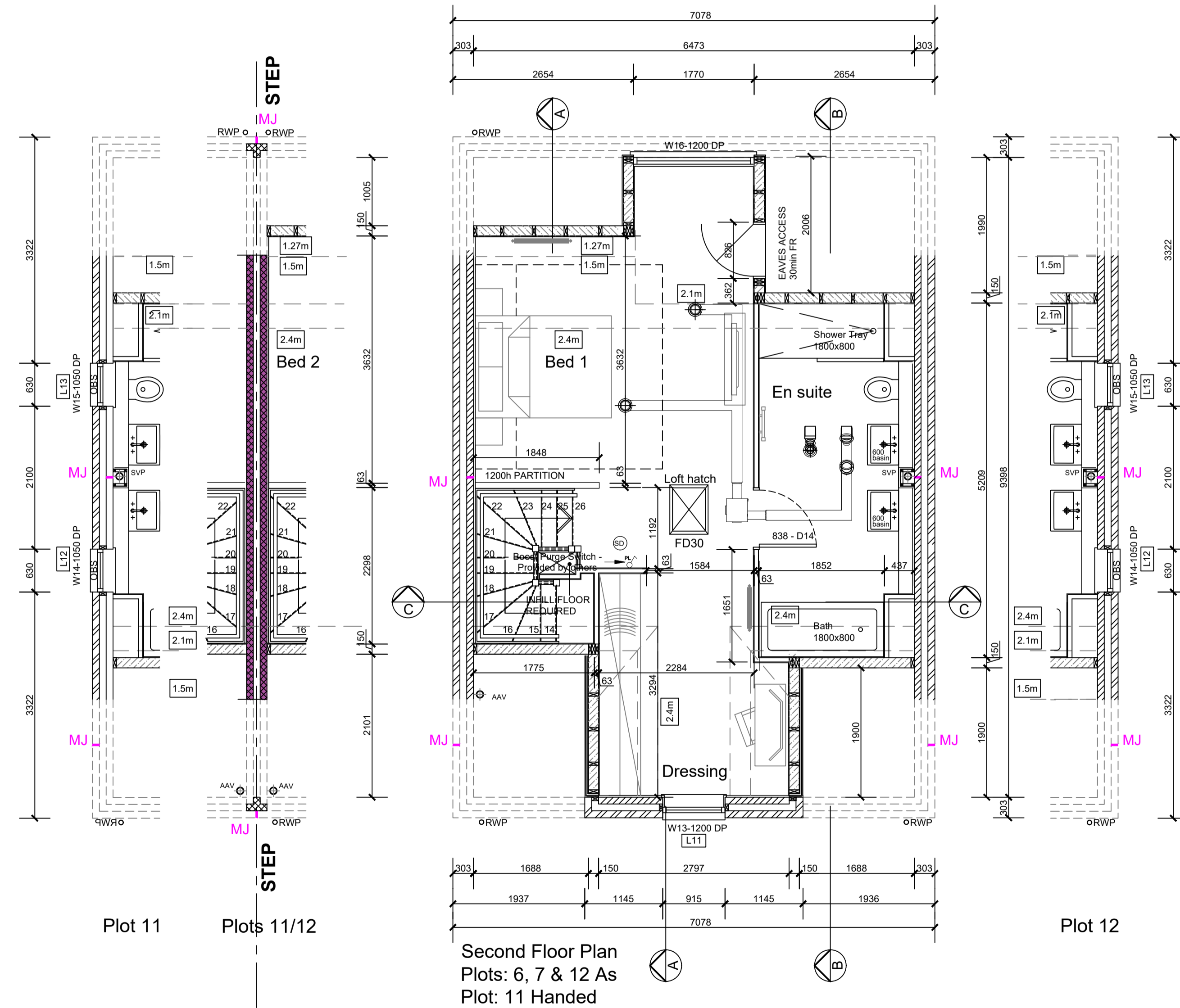

WADP Limited Registered in England No. 4564928  
Registered office: Station House, Connaught Road, Brookwood,  
GU24 0ER



Drawings not to be scaled.  
Work to figured dimensions only.  
All dimensions to be checked on site, and any discrepancies reported to the Architect immediately

All drawings are to be read in conjunction the BELLWAY Company Specification and Project Specifications, Company Standard Details and with the current Building Regulations and Codes of Practice.

It is the Contractor's responsibility to ensure that all works are carried out in accordance with the same.

All concrete work to be carried out in accordance with BS EN 1992-1-1:2004.

All brickwork and blockwork to be carried out in accordance with BS EN 1996-1-2:2005.

All structural steelwork to be carried out in accordance with BS EN 1993-1-1:2005 Steelwork to be Grade S275.

All structural timber to be used in accordance with BS EN 1995-1-1:2004 and is to be preservative treated in accordance with BS4072.

All plumbing to be in accordance with BS6700, BS EN 12056, BS6465:Part 1 and BS6367.

All glass falling within critical zones as defined by Part N of the Building Regulations is to be toughened or safety glass in accordance with BS EN 12600

All building works to be undertaken in accordance with Robust Enhanced Accredited Details.

# WADP

ARCHITECTS

62 Well Lane  
Horsell  
Woking  
Surrey  
GU21 4PS

Telephone: 01483 763028  
e-mail info@wadp.co.uk

www.bellway.co.uk

REGENT'S GATE  
VIRGINIA WATER SOUTH

THE TURNBERRY  
Second Floor Plans

1:50 @ A1

March 2024

CB

WADP-225\_THE TURNBERRY C2