

Drainage Legend (Dimensions are approx. internal sizes).

- Site boundary
- FFL XX.XXX Plot finished floor level DPC level, refer to architects details
- XX.XX Garage finished floor level DPC level, refer to architects details
- Exposed brickwork refer to External Levels Drawing
- Raised damp proof course / water proofing refer to External Levels Drawing
- Gravel board refer to External Levels Drawing
- Retaining Wall refer to External Levels Drawing
- Existing public foul sewer
- New adoptable foul sewer to be constructed in accordance with SSG Appendix C, DCG.
- New adoptable foul manhole (size and construction may vary), to be built in accordance with SSG Appendix C, DCG.
- New private foul drain
- New private foul inspection chamber 225mm dia. polypropylene or vitrified clay up to 600mm deep. Max pipe diameter 150mm
- New private foul inspection chamber 450mm dia. polypropylene up to 3000mm deep. Max pipe dia. 150mm
- New adoptable surface water sewer to be constructed in accordance with SSG Appendix C, DCG

- New adoptable surface water manhole (size and construction may vary), to be built in accordance with SSG Appendix C, DCG
- New private surface water inspection chamber 225mm dia. polypropylene or vitrified clay up to 600mm deep
- New private surface water inspection chamber 450mm dia. polypropylene up to 3000mm deep. Max pipe diameter 150mm
- New private surface water inspection chamber either 1200mm dia. precast concrete, or 1200 x 750mm precast concrete, or 1200 x 750mm class B engineering brickwork over 1500mm deep.
- Perforated pipe
- Private road gully
- New private yard gully
- New private channel drain
- Proposed land drain
- New private rodding eye
- Public sewer maintenance margin

THE DETAILS ON THIS DRAWING ARE INDICATIVE ONLY. INSTALLATION TO BE IN STRICT ACCORDANCE WITH MANUFACTURERS DESIGN AND DETAILS. REFER TO MANUFACTURERS DESIGN PACK AND INSTALLATION DETAILS

Sheet Layout
Scale 1:1250

Cellular Tank Notes

- This drawing shall be read in conjunction with the S104 Adoptable Drainage Layout & Private Drainage Layout.
- The design of the tank shall be undertaken by the specialist manufacturer in accordance with CIRIA 737 to include but not limited to lateral and vertical loadings and flotation. Full consideration shall be given to the site specific ground conditions and groundwater levels.
- Geocellular tank to be fully sealed, ie. tanked attenuation system
- Minimum cellular tank void ratio to be 95%.
- Minimum 487.35 m³ net attenuation volume (95% void ratio). Minimum height of storage units to be 1.2m. Approximate minimum plan area 427.5 m².
- Tank dimensions shown are the minimum required, refer to manufacturers details for actual dimensions.
- Tank to be laid at 1:300 falls to outlet.
- Minimum cover 0.38 m, maximum cover 2.38m.
- Access tunnels to be provided at all four corners and one centrally as indicated
- Ventilation to be provided as required by manufacturer.
- No trees shall be planted within 5m of attenuation tank.
- The contractor shall undertake flotation calculations for construction stage works and provide all necessary mitigation to counter flotation of tank

Important Drainage Notes:

Prior to installation of any new drainage the contractor shall:

- Confirm line and level of all outfall manholes and outfalls prior to the works. Where the depths of these manholes are insufficiently deep for any new connection from the site, the engineer shall be informed immediately. Level of connection subject to confirmation that no clashing occurs with any of the existing sewers or services, contractor to re-level if necessary.
- Ensure all relevant consents for sewer connections are in place :
 - Thames Water S106 sewer connections
 - Essex County Council S278
 - Essex County Council Ordinary Water Consent

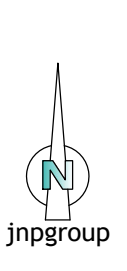
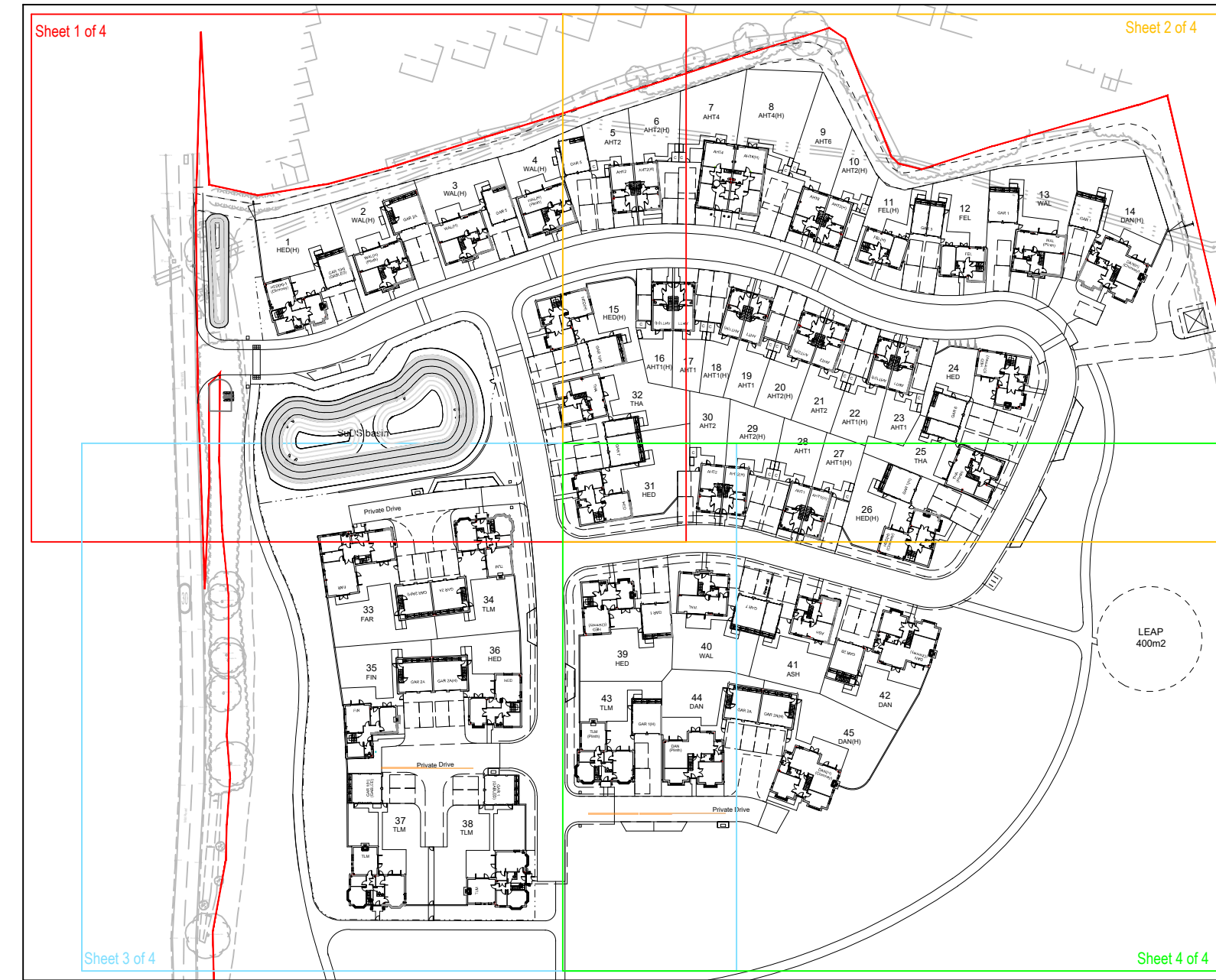

General Notes

- Where this drawing has been issued in electronic .dwg format, it has been done so in good faith. JNP Group do not take any responsibility for any inaccuracies in the electronic data, which should be checked against the paper (or .pdf) drawing issue. Any apparent discrepancies should be immediately reported to JNP Group. The electronic .dwg file should not be assumed to be to scale and should not be used for 'overlaying', setting out or checking of any third party information. All dimensions should be taken from the paper (or .pdf) version of the drawing. Electronic drawings may contain third party information. JNP Group take no responsibility for this information, which should be checked against the originators paper drawing(s).
- All dimensions are millimetres (mm), and levels are in metres (m) unless noted otherwise and should be checked on site prior to construction/fabrication.
- Do not scale from this drawing. Only figured dimensions are to be relied upon. Don't hesitate to get in touch with JNP Group if additional information is required.
- Any discrepancies between drawings of different scales and between drawings and specifications, where appropriate, to be reported to JNP Group for decision.
- Copyright reserved. This drawing may only be used for The Client and location specified in the title block. It may not be copied or disclosed to any third party without the prior written consent of JNP Group.
- This drawing should only be used for construction if the drawing status is "A4 - Approved/Stage Complete". JNP Group takes no responsibility for construction works undertaken to drawings that are not marked with this status.

Health & Safety Note

The details on this drawing have been prepared on the assumption that a competent contractor will be carrying out the works. If the contractor(s) considers that there is insufficient Health and Safety information on this drawing, this should immediately be brought to the attention of the designer.

HAZARD IDENTIFICATION BOX			
This table is provided to assist the Principal Contractor to fulfill their obligations under the CDM Regulations 2015			
Hazard Ref	Hazard Type	Hazard Description	Mitigation Measures/Residual Risk

Drawing References

- Site Layout by Manor House Architecture, Drawing ref 24403-1000
- Topographical Survey by Survey Solutions, Drawing ref 45403PLS-01 - 04
- Tree protection plan by SJA Trees, Drawing ref SJA TPP 23332-041
- S278 Design by Conisbee, Drawing ref 220741-CON-XX-00-DR-C-3100
- Site Investigation by Gemco. Report ref 2147 R02: Issue 3

Rev	Date	Description	Drawn/Checked/Approved
P05	28/01/2025	Site layout updates, perpendicular path removed from all plots apart from plot 6 & 8.	CP/RS/HRSH
P04	10/12/2024	Updates to garages FFLs & plot 25 FFL	JQ/CP/RS/HRSH
P03	16/10/2024	Updates to plot drainage to keep drainage runs within plots curtilage. Water proofing and exposed brick greyed out.	AU/CP/RS/HRSH
P02	14/08/2024	Basin headwall position updated, update to FW16 IL, FW1, 2, 10 & 19 and SW1 & 2 have been removed	CP/RS/HRSH
P01	19/07/2024	Draft issue for tender	CP/RS/HRSH
Subsidiary			
S4 - Suitable for Stage Approval			

Client Logo:



JNP GROUP
CONSULTING ENGINEERS

Amersham • Brighouse • Bristol • Glasgow
Hartlepool • Sheffield • Warwick

www.jnpgroup.co.uk

Client:	Bellway Homes Ltd (North London)		
Job:	Hares Leap, Henham, Essex		
Title:	Private Drainage Layout Sheet 4 of 4		
Classification:	FL_60_20		
Scale @ A1:	1:200		
Project - Originator - Volume/System - Level/Location - Type - Discipline - Number	C86840-JNP-92-XX-DR-C-2014		
Revision:	P05		