

NOTES:

- DO NOT SCALE FROM THIS DRAWING. THE CONTRACTOR IS RESPONSIBLE FOR SITE MEASURING ALL REQUIRED MATERIALS PRIOR TO ORDERING.
- THIS DRAWING SHALL BE READ IN CONJUNCTION WITH ALL MECHANICAL, ELECTRICAL AND PUBLIC HEALTH DRAWINGS & SPECIFICATIONS AND WITH ALL ARCHITECTURAL & STRUCTURAL DRAWINGS & SPECIFICATIONS. ANY DISCREPANCIES TO BE REPORTED TO RHB PARTNERSHIP LLP.
- THIS DRAWING OUTLINES THE DESIGN FOR THE MECHANICAL, PUBLIC HEALTH AND ELECTRICAL SERVICES AND HAS BEEN PRODUCED TO ASSIST THE CONTRACTOR WITH TENDER. THE DRAWING DOES NOT INDICATE ALL EQUIPMENT, ACCESSORIES, DEVICES ETC WHICH MAY BE REQUIRED FOR THE SATISFACTORY INSTALLATION AND COMPLETION OF THE PROJECT AND SHALL THEREFORE BE USED FOR GUIDANCE PURPOSES ONLY. THE CONTRACTOR SHALL BE RESPONSIBLE FOR INCLUDING EVERYTHING WITHIN HIS TENDER NECESSARY FOR SATISFACTORY COMPLETION.
- ALL INTERNAL ELECTRICAL SERVICES SHALL BE INSTALLED IN ACCORDANCE WITH BS: 7671-REQUIREMENTS FOR ELECTRICAL INSTALLATIONS, CIBSE RECOMMENDATIONS & OTHER RELEVANT STANDARDS & CODES OF PRACTICE.
- THE CONTRACTOR SHALL CONFIRM THE ENTRY POSITIONS OF ALL SERVICES TO THE BUILDING PRIOR COMMENCEMENT OF THE WORKS.
- THE INDIVIDUAL MDPE MAINS COLD WATER SUPPLIES SHALL RISE FROM THE RIGI DUCT SLEEVES (FORMED INTO A SLOW BEND) TO A LOW LEVEL STOPCOCK TYPE ISOLATION VALVE AND DRAIN-OFF VALVE IN THE LOCATIONS SHOWN HERE. IT SHALL THEN CONVERT TO COPPER.
- ALL WATER SERVICES SHALL BE INSTALLED TO COMPLY WITH LOCAL AND NATIONAL WATER REGULATIONS AND THE BELOW GROUND PIPEWORK SHALL REMAIN EXPOSED UNTIL INSPECTED AND SIGNED OFF BY THE LOCAL WATER INSPECTOR.
- ALL PIPED SERVICES SHALL BE IDENTIFIED IN ACCORDANCE WITH BS 1710. EVERY SERVICE SHALL BE MARKED WITH A VISIBLE, DIRECTLY APPLIED SERVICE IDENTIFIER. IN ADDITION TO IDENTIFYING THE CONTENTS ADDITIONAL INFORMATION ABOUT THE TYPE OF SERVICE eg. DETAILS ABOUT THE CONTENTS, DIRECTION OF FLOW OR OPERATIONAL PARAMETERS, SHOULD BE PROVIDED.
- ALL INCOMING ELECTRICAL SERVICES SHALL BE INSTALLED IN COMPLIANCE WITH THE DNO/IDNO REQUIREMENTS.
- ALL SERVICES PENETRATING FIRE COMPARTMENTS SHALL BE SUITABLY FIRE STOPPED WITH PROPRIETARY MATERIALS.
- INCOMING SERVICES WITHIN APARTMENT CUPBOARDS TO BE COORDINATED WITH SERVICES IDENTIFIED ON THE ARCHITECTS DRAWINGS & SHALL BE TO THE REQUIREMENTS OF THE UTILITY PROVIDERS.
- REFER TO THE SEPARATE RISER DRAWINGS FOR LAYOUT OF THE SERVICES.

RISK SCHEDULE	
ITEM	DESCRIPTION OF RISK
1	SPECIFIC HEALTH AND SAFETY RISKS ASSOCIATED WITH THIS DRAWING ARE HIGHLIGHTED WITH THE CAUTION SYMBOL ADJACENT TO THE ITEM OF RISK. PLEASE REFER TO RISK SCHEDULE CONTAINED ON INDIVIDUAL DRAWINGS.
	UNLESS HIGHLIGHTED THERE ARE NO SPECIFIC HEALTH AND SAFETY RISKS ASSOCIATED WITH THIS DRAWING, AS A DIRECT RESULT OF OUR DESIGN, APART FROM THE COMMON ISSUES ASSOCIATED WITH CONSTRUCTION THAT WILL NEED TO BE ASSESSED BY A COMPETENT CONTRACTOR PRIOR TO THE UNDERTAKING OF ANY WORK.

C1	12.12.25	ISSUED FOR CONTRACT	KC
REV	DATE	DESCRIPTION	NAME



CLIENT:
**TAYLOR WIMPEY
(NORTH THAMES)**

ARCHITECT:
MARK REEVES

PROJECT:
GRANGE FARM, PHASE 2

TITLE:
**BLOCK N1 - PLOTS 84-91
SUBSTRUCTURE
COORDINATED SERVICES LAYOUT**

DESIGNED BY:	DRAWN BY:	CHECKED:
KC	AAG	JG
RHB REF:	DATE:	SCALE:
4611	MAR 2025	1:50 (A1)

DRAWING No:
22242-RHB-N1-B1-DR-C-4010-C1

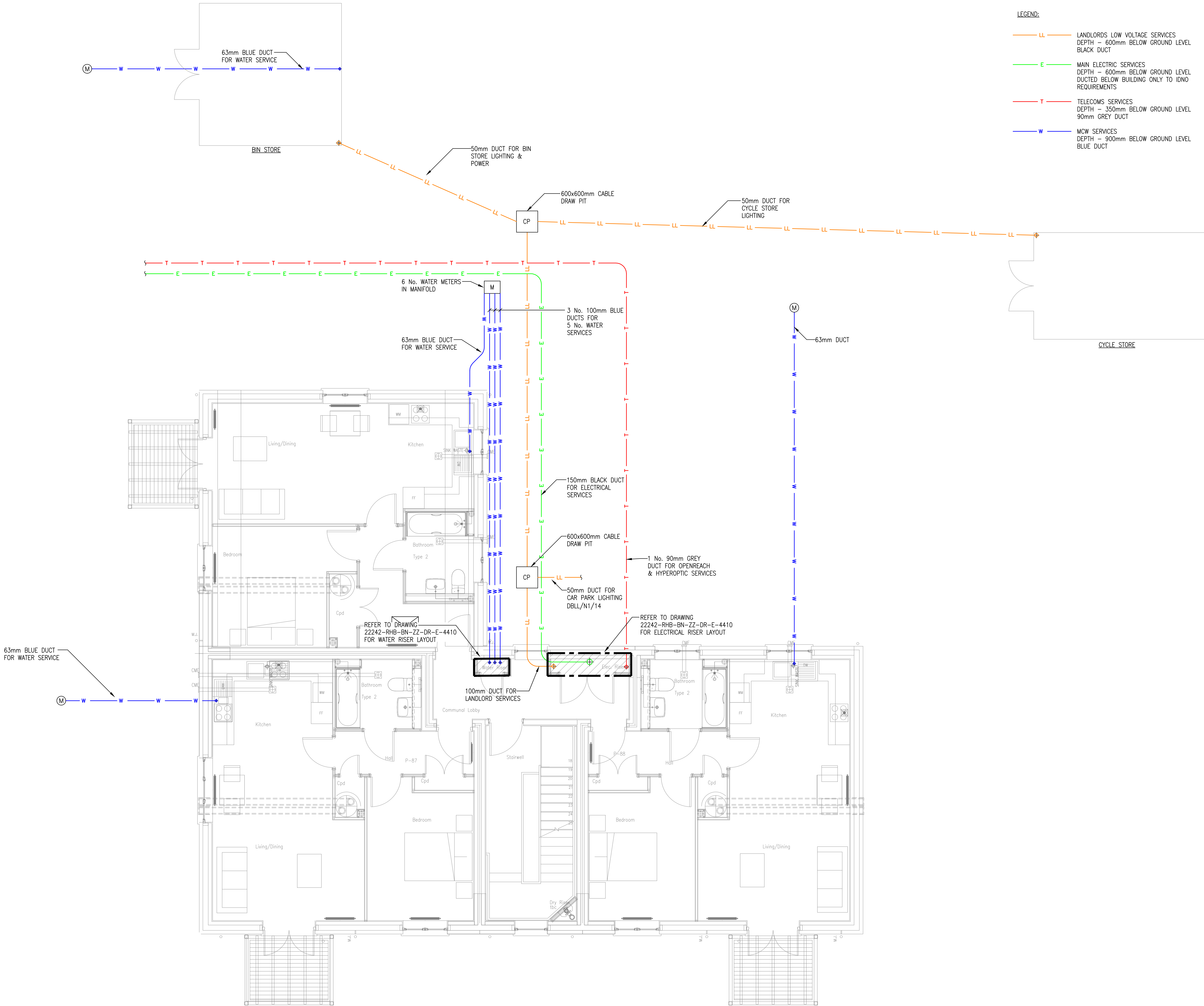

LEGEND:

- LL LANDLORDS LOW VOLTAGE SERVICES
DEPTH - 600mm BELOW GROUND LEVEL
BLACK DUCT
- E MAIN ELECTRIC SERVICES
DEPTH - 600mm BELOW GROUND LEVEL
DUCTED BELOW BUILDING ONLY TO IDNO
REQUIREMENTS
- T TELECOMS SERVICES
DEPTH - 350mm BELOW GROUND LEVEL
90mm GREY DUCT
- W MCW SERVICES
DEPTH - 900mm BELOW GROUND LEVEL
BLUE DUCT