

SEE SITE LAYOUT FOR
CHARACTER AREAS,
MATERIALS AND ORNAMENT;
REFER TO ELEVATION AND
SCHEDULE FOR WINDOW
PANE CONFIGURATION.

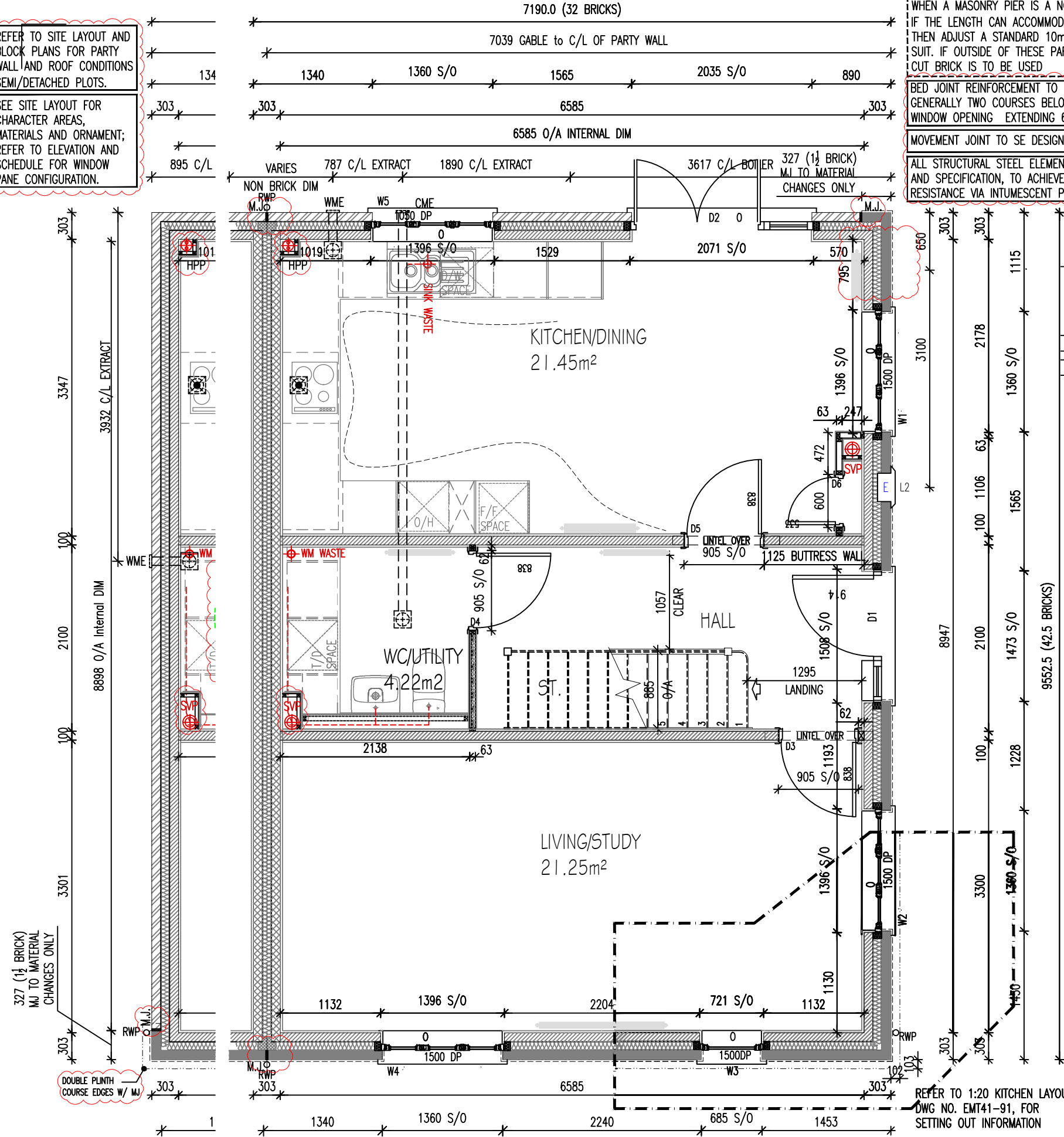

ALL STRUCTURAL STEEL ELEMENTS TO SE DESIGN
AND SPECIFICATION, TO ACHIEVE MIN.1HR FIRE
RESISTANCE VIA INTUMESCENT PAINT

PLOTS - 128, 129, 158

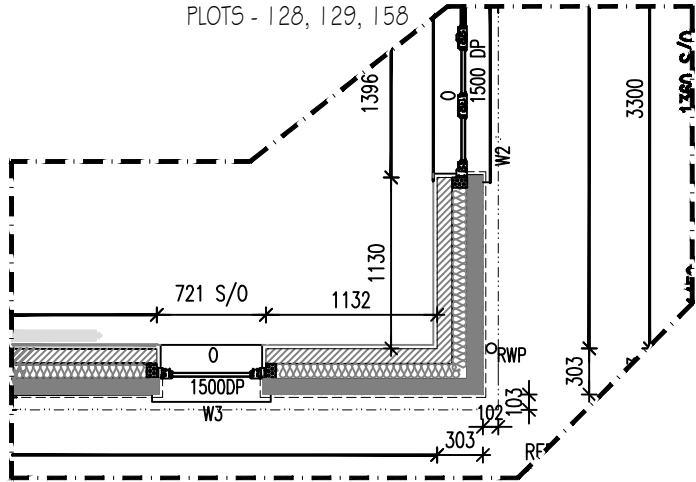

C02	05.12.25	Compliance amended to M4(1/2)	MS	SN
P01	13.10.25	STATUS TO CONSTRUCTION	SN	LE
T03	24.09.25	Double plinth course call out added	SN	LE
T02	20.06.25	Studwork legend updated	CC	LE
T01	22.04.25	STATUS TO TENDER	SN	LE
P02	19.03.25	HPP added; WHH removed; Change of plot numbers	CC	LE
REV	DATE	DESCRIPTION OF REVISION	DRAWN	CHECKED

Taylor Wimpey UK Ltd
Gate House, Turnpike Road,
High Wycombe, Bucks HP12 3NR
Tel 01494 558323 Fax 01494 885663
www.taylorwimpey.com

0 - PART 0 COMPLIANCE
DOORSETS AND WINDOWS AS TO BE DESIGNED
IN ACCORDANCE WITH APPROVED DOCUMENT O
SECTIONS 3.6 to 3.11: 2021

GROUND FLOOR PLAN - OPP (END/SEMI-DETACHED)

GUTTER SIZE & RWP POSITIONS TO BE DESIGNED BY SITE ENGINEER WITH DOWNPIPES LOCATIONS IN ACCORDANCE WITH DEVELOPMENT DRAINAGE LAYOUT, SITE CONDITIONS AND EXPANSION JOINT LOCATIONS.

REFER TO 1:20 KITCHEN LAYOUT,
DWG NO. EMT41-91, FOR
SETTING OUT INFORMATION

REFER TO 1:20 WC/UTILITY
LAYOUT, DWG NO.
EMT41-92, FOR SETTING
OUT INFORMATION