

STAIRCASE - GRD-1st			
14 equal risers of 205.14mm; Going = 234mm; Pitch 41.82°; Width over strings - 860mm			
STAIRCASE - 1st-2nd			
13 equal risers of 219.23mm; Going = 234mm; Pitch 41.82°; Width over strings - 860mm			

ROOF VENTILATION (TYPE 1)			
An impermeable roofing underlay (Type 1F / HR) is to be draped over all roof pitches, with Rytons OFV1000 (or similar approved) over fascia ventilator providing ventilation equivalent to a continuous 10mm opening at eaves level, and Glidevale Fulmetal Rediroll ventilated dry ridge system (or similar approved) providing ventilation equivalent to a continuous 5mm opening at ridge level.			
PADSTONE SCHEDULE			
REF	LENGTH	DEPTH	WIDTH
P1	215	215	100
P2	330	215	100
P3	440	215	100
P5	215	215	100

Padstones and steel beam sizes as per SE Drawings

Refer to specialist for joist sizes

Refer to M&E Drawings for Underfloor heating details

GENERAL ARRANGEMENT PLANS - WALL LEGEND	
	Frost resistant quality facing brickwork 20N Brickwork laid in minimum class ii (M4) mortar.
	Celcon Standard blockwork to inner leaf only. Medium dense blockwork to outer leaf to be laid in minimum class iii (M4) mortar. Compressive strength 7.3N/mm² to the Ground Floor, minimum class iii (M6) mortar (unless otherwise noted) & 3.5N/mm² minimum class iii (M4) mortar (unless noted otherwise noted) to first,second floor& roof level.
	Note:All external wall cavities to be 125mm unless otherwise specified.
	70mm British Gypsum Gyplframe 70S50 °C stud system, with studs at 600mm centres. 12.5mm Gyproc Soundbloc plasterboard each side with tapered edges, finished as per internal spec. Moisture-resistant plasterboard to bathroom with studs at 400mm centres.
	70mm Butressing Wall with 12mm Ply Sheathing as per SD/3022. 12.5mm Gyproc Soundbloc plasterboard each side with tapered edges, finished as per internal spec. Moisture-resistant plasterboard to bathroom with studs at 400mm centres.
	63x38mm timber studs @ max 600mm centres. 50mm Isover acoustic partition roll (APR 1200) to be installed between studwork for the entire wall panel.
	Movement Joints
	Denotes the position of the external cavity fire Soc.
	Dashed line indicates extent of secondary DPC stepped up to accommodate level threshold to front door.
<b>IMPORTANT NOTE:</b> ALL EXTERNAL WALLS TO INCORPORATE BRICKFORCE SBF30W60 BED-JOINT REINFORCEMENT TO INNER LEAF OF BLOCKWORK 2x COURSES ABOVE & BELOW ALL OPENINGS & TO PROJECT A MIN. 600mm BEYOND OPENING.	

ELECTRICAL KEY	
This electrical legend is to be read in conjunction with the internal specification & M&E consultants details if applicable with any discrepancies being reported to the site manager. Doorbells, light switches, entryphones, etc. should be fixed no higher than 1200mm above FFL. TV, BT & power sockets should be fixed no lower than 450mm above FFL. All wall lights to be fitted at 2100mm above FFL.	
Symbol	Description
	Flush double switch socket.
	Flush rocker light switch, 1/2 or 3 way switched.
	Ceiling rose light point.
	LED down lighter light fitting.
	Under-stair oval bulkhead wall mounted light.
	External Wall light.
	Batten holder light fitting.
	External socket.
	13A flush unswitched spur.
Where switches are located all in the same wall, use 2/3/4 gang switches.	

Symbol	Description
	Flush double switched socket 200mm above kitchen work top.
	13A Flush unswitched outlet 300mm below kitchen work top.
	Flush 30A cooker switch 200mm above kitchen work top.
	Gas point.
	Shower head & control position.
	Ceiling mounted extract fan.
	Isolator switch.
	Shaver socket.

Symbol	Description
	Dual TV/ FM point 1xCT100 cabling (diplexer).
	Single slave phone socket 1xCAT 6 cabling.
	RJ45 data point
	HDMI port (4 & 5 beds only)
	Immersion heater switch, located in AC.
	Rad/Rail.
	Heating control programming switch.
	Grid switch.
	Thermostat.

Symbol	Description
	Carbon Monoxide Detector.
	Smoke Detector.
	Heat Detector.
	For sites with FTTP refer to SD/1002. For sites with FTTC refer to SD/1003.
	For full lounge plate specification refer to CALA Group Internal Specification.
	Intruder Alarm unit to Nacoss Standard
	Alarm Panel
For sites where virgin is to be provided, Virgin Media blanking plates are to be provided adjacent to the low level Lounge Plate in the lounge, and next to the TV/FM socket within the Family Room and Master Bedroom.	
	External wall mounted Electric Meter
	British Telecom Point
	Hyper Optic Point
	Underfloor Heating Manifold

Notes	All dimensions to be checked on site prior to the commencement of construction and any discrepancy should be reported to the Site Manager.
	This drawing may not be reproduced in any part or form without written consent.
	All copyrights reserved.
	Sub-Contractors MUST ensure that they have the latest issue drawing before they commence work on site.
	This drawing is to be read in conjunction with all relevant Specifications, schedules and Engineers details.

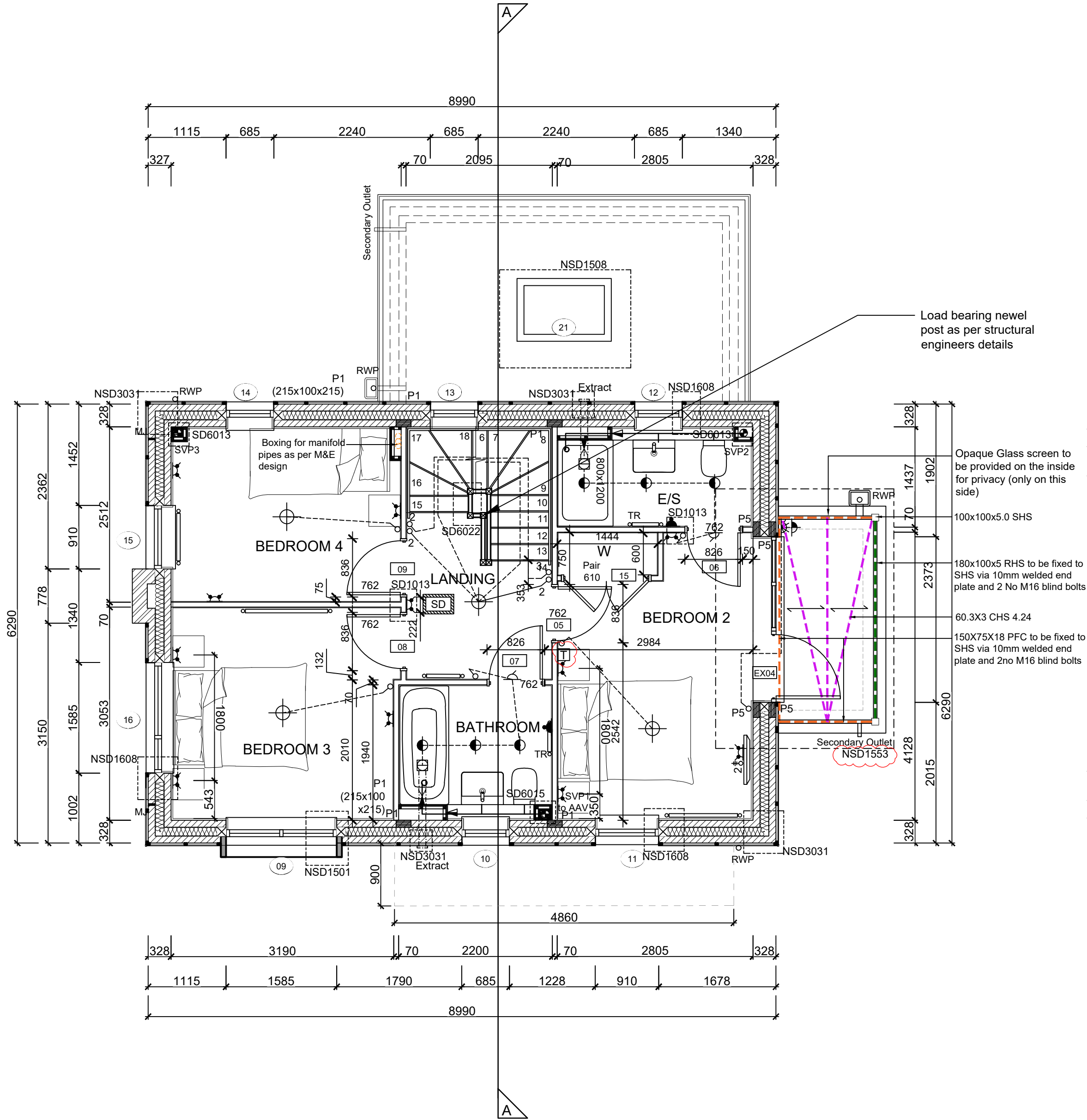

FIRST FLOOR LAYOUT  
SCALE 1:50

R	15.12.25	Updated balcony floor structure / detail ref.	DF
Q	07.10.25	Thermostat relocated	ZJ
P	05.08.25	Basin updated as per spec. Thermostat moved to landing. Added balcony drainage.	SK
O	15.04.25	Structural opening amended to doors 5,8,&9	SK
N	25.03.25	Removed balcony rear posts, amended terrace door size.	DF
M	06.02.25	Double doors added to W/drobe. Dims amended	SK
L	10.01.25	W/drobe added to Bed 2, M&E coordinated	DF
K	15.10.24	Detail Ref tags co-ordinated.	
J	24.09.24	Wall key amended	ZJ
I	16.09.24	Note amended	ZJ
H	22.07.24	RWP location amended. SE note added.	SK
G	28.06.24	Boxing amended M&E note added.	SK
F	24.06.24	Door Leaf Size changed to 762mm.	YS
E	19.04.24	Legend revised, details refs added. Wardrobes omitted from bed 3 & 4. Privacy screen note added.	SK
		Thermostat added to landing.	
Rev	Date	Description	Init.

Job title	
Brooklands College Weybridge	
Drawing title	
House Type HT9A Everglade (Type 3) Plots: 186 First Floor Plan	
Scale	1:50 @ A1
Date	May 2023
Rev.	R
Drawn	SK
Dwg No. SA00394-0097-A-HT9A-GA	