

FOUNDATION LAYOUT HT BAYBERRY (2NO):
PLOTS: AS: 14, 22, 33, 101, OPP: 15, 21, 32, 100

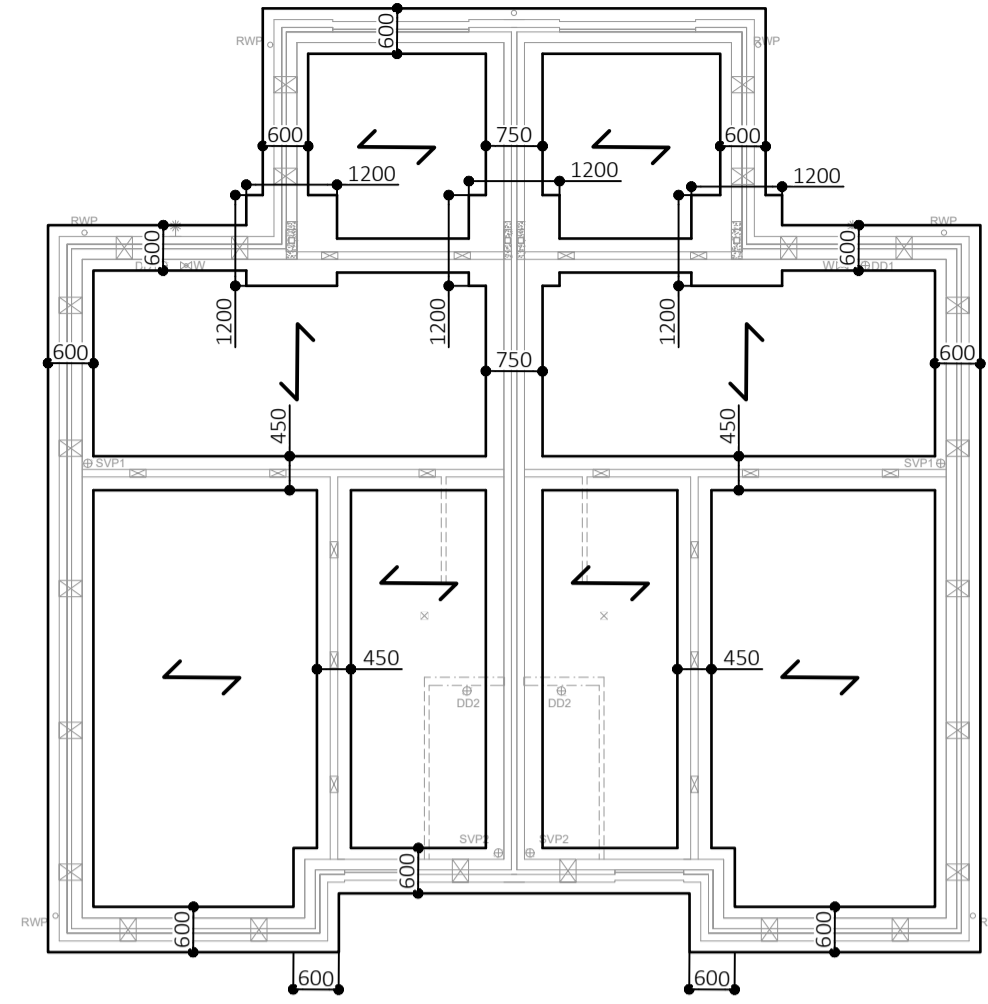

FOUNDATION LAYOUT HT FIR (2NO):
PLOTS AS: 67, 69, 115, OPP: 68, 70, 114

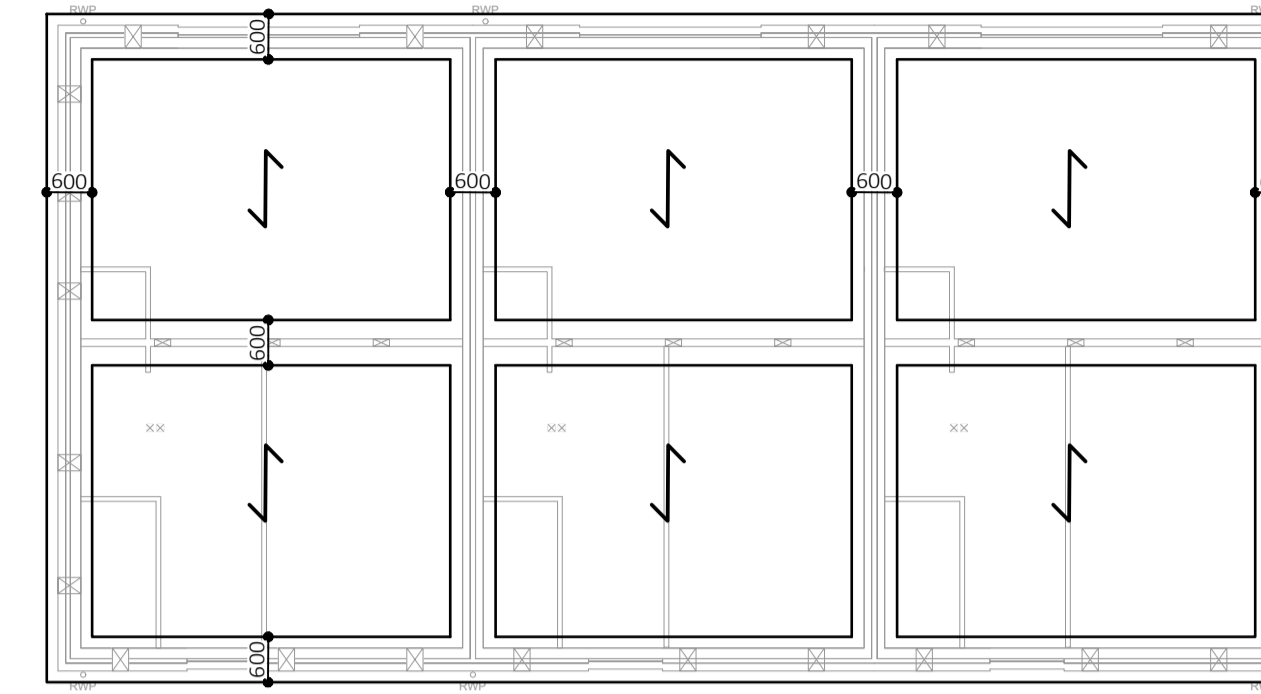

FOUNDATION LAYOUT HT BAYBERRY (3NO):
PLOTS: AS: 49, OPP: 16, 17, 18, 47, 48

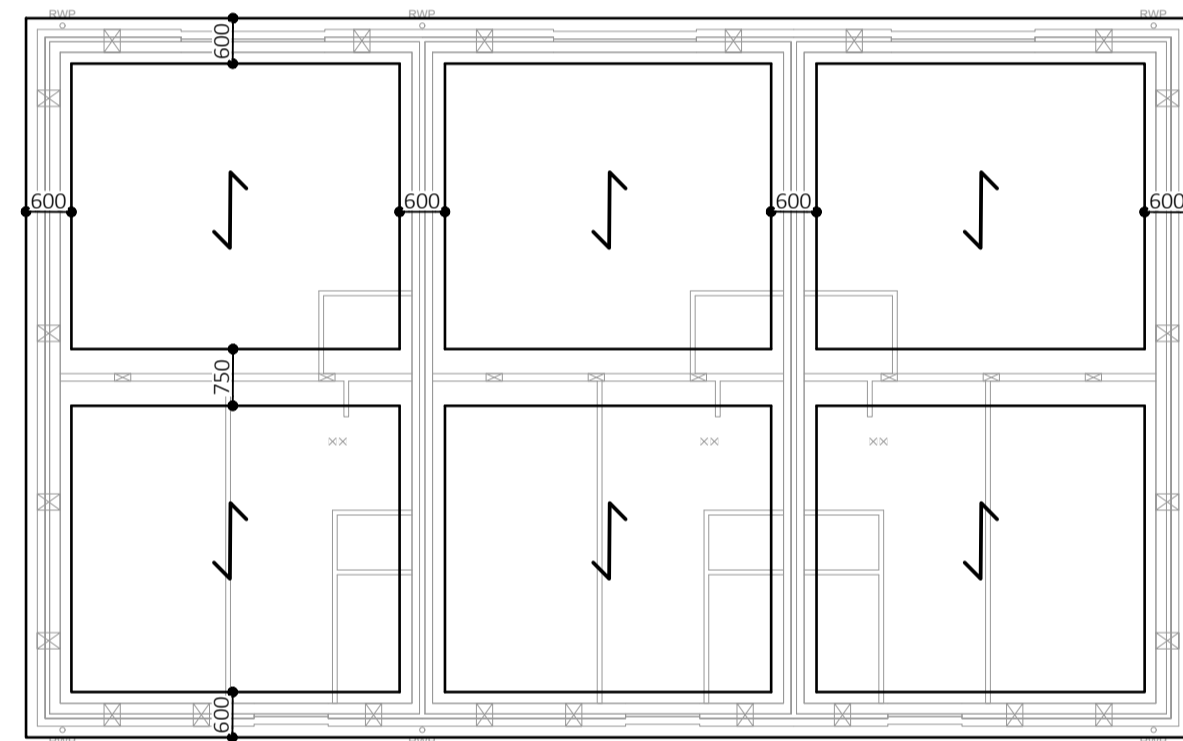

FOUNDATION LAYOUT HT BELLFLOWER (3NO):
PLOTS AS: 24, 25, 45, 46, OPP: 23, 44

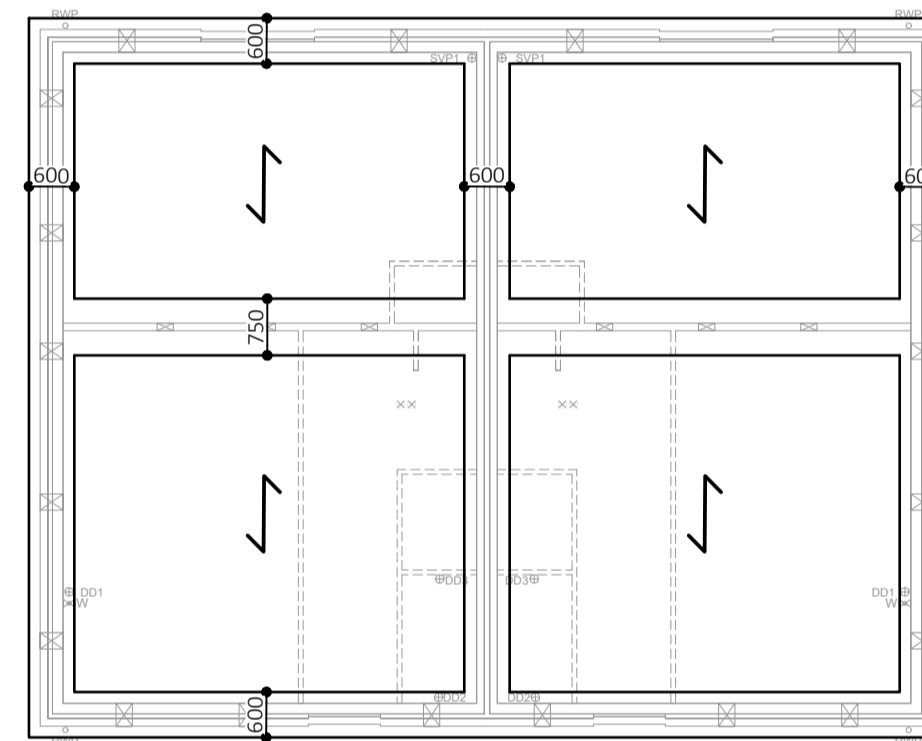

FOUNDATION LAYOUT HT CLOVER (2NO):
PLOTS AS: 53, 71, 120, OPP: 52, 72, 119

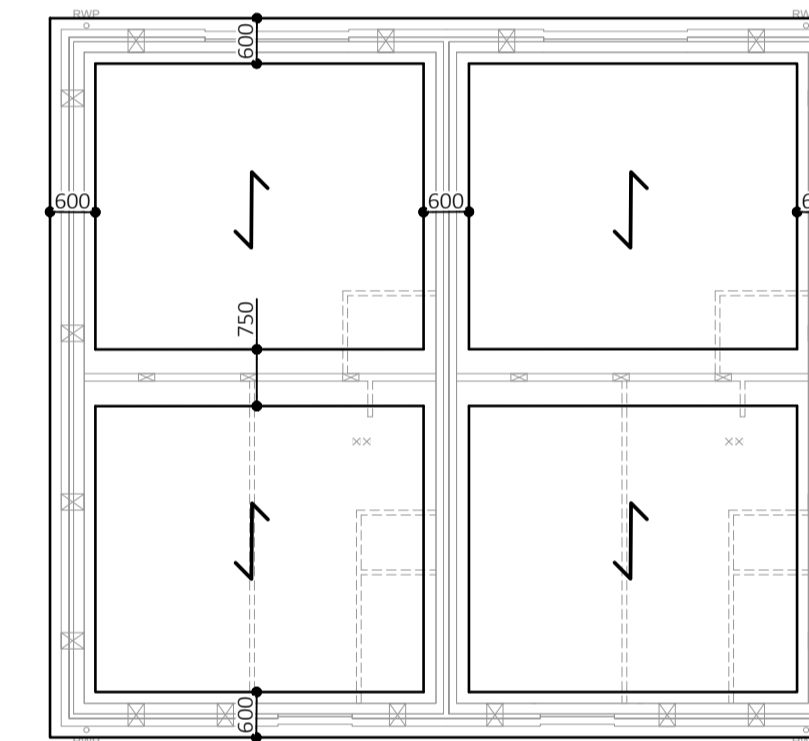

FOUNDATION LAYOUT HT BELLFLOWER (2NO):
PLOTS AS: 58, 60, 99, 103, OPP: 57, 59, 98, 102

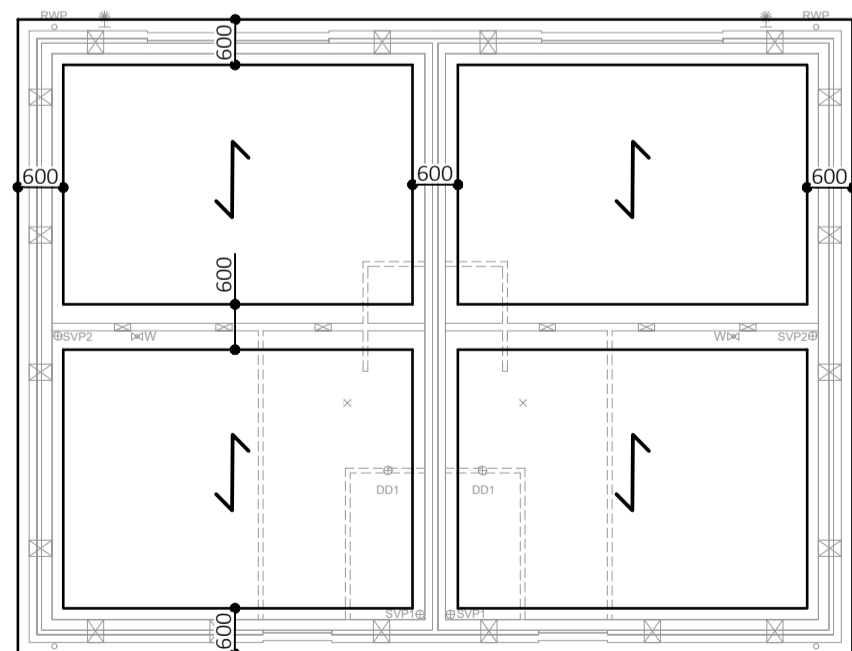

FOUNDATION LAYOUT HT ASPEN (2NO):
PLOTS AS: 56, OPP: 55

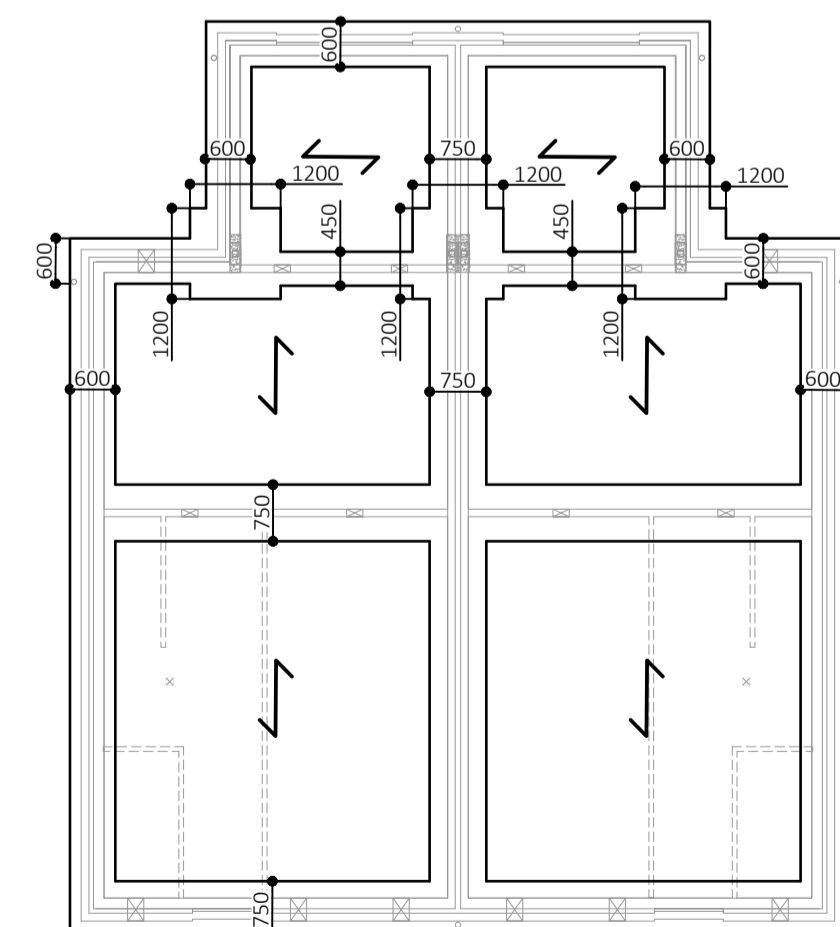

FOUNDATION LAYOUT HT ROSE (2NO)
(FORMERLY FOXGLOVE 2NO):
PLOTS AS: 63, 65, 74
OPP: 62, 64, 75

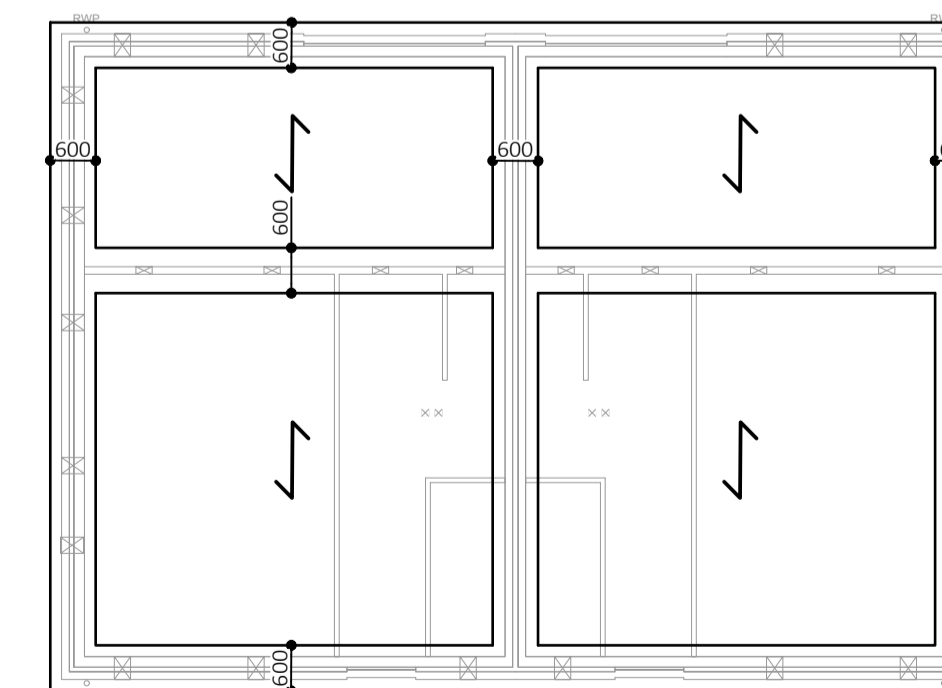

FOUNDATION LAYOUT HT BLACKTHORN (2NO):
PLOTS AS: 19, OPP: 20

- NOTES
- All dimensions are to be checked on site before the commencement of works. Any discrepancies are to be reported to the Architect & Engineer for verification.
 - Figured dimensions only are to be taken from this drawing.
 - This drawing is to be read in conjunction with all relevant Architects', Engineers', and Service Engineers' drawings and specifications.
 - This drawing is copyright.
 - Refer to 27141-HYD-2A-F1-DR-S-1001 to -1005 for trench fill foundation layouts, 27141-HYD-2A-F1-DR-S-1006 to -1010 for tree influence and drawing 27141-HYD-2A-ZZ-DR-S-1100 for typical sections and project notes.

REVISIONS

Rev.	Date	Description	By	Chk.	App.
P04	01.12.2025	Updates to HT names and foundation widths.	CC/OL	DW	AK
P03	07.01.2025	Updated plot numbers and HT's from updated planning layout. HT's Bayberry (3no) and Bellflower (2no) updated.	OL	JB	JB
P02	05.07.2024	Updated plot numbers and HT's from updated planning layout.	OL	JB	JB
P01	02.02.2024	Tender issue.	OL	PW	JB

Hydrock MERCHANTS' HOUSE NORTH
WAPPING ROAD
BRISTOL
BS1 4RW
t: 0117 945 9225
e: bristolcentral@hydrock.com

CLIENT
Cala Homes Cotswolds

PROJECT
Himley Village, Bicester

TITLE
FOUNDATION WIDTHS: SHEET 1

HYDROCK PROJECT NO. 27141	SCALE @ A1 1:100
STATUS DESCRIPTION TENDER	STATUS D2
DRAWING NO. 27141-HYD-2A-F1-DR-S-1050	REVISION P4