

Abnormal or unusual residual risks associated with the design outcomes shown on this drawing are:-

RSK LDE LTD has followed its Design Risk Management process for Hazard Elimination and Risk reduction in developing the designs shown on this drawing. Abnormal or unusual residual risks may be shown above where it is considered that such risk may not normally be expected by competent persons engaged on work of this nature or type.

Notes:

1. This drawing presents the proposed temporary signage to be to be installed for the construction site access.
2. All signs shall be compliant with the Traffic Signs Regulations and General Directions along with the requirements as defined in the relevant Chapters of the Traffic Signs Manual.
3. All temporary signage as shown on this drawing shall remain insitu until the access is no longer utilized for construction traffic.
4. The signs locations as shown are approximate. The exact location shall be agreed on site with Essex Highways based on their proximity to existing highway features to ensure the sign are adequate visible whilst not obstructing the visibility of exiting roadside signage.
5. This drawing should be printed in COLOUR.

P01	04.04.2026	For Approval S278 Submission	YP	GT	-
Rev.	Date	Amendment	Drawn	Chkd.	Appd.

LDE
 CIVILS | STRUCTURES | HYDROLOGY
 an RSK company

18 Frogmore Road
 Hemel Hempstead
 Hertfordshire
 HP3 9RT
 United Kingdom

Tel: +44 (0) 1442 437500
 Fax: +44 (0) 1442 437550
 Email: info@rsk.co.uk
 Web: www.rsk.co.uk

Client

Bellway

Project Title
**RADWINTER ROAD, SAFFRON WALDEN
 S278 HIGHWAY IMPROVEMENT WORKS
 TEMPORARY ACCESS**

Status **APPROVAL**

Drawing Title
**CONSTRUCTION SITE ACCESS
 SIGNAGE**

Drawn	Date	Checked	Date	Approved	Date
YP	15.10.2025	GT	16.10.2025		
Scale	As Shown	Orig Site	A1	Dimensions	As Shown
Project No.	891015		Drawing File	891015-RSK-ZZ-XX-DR-C-7058 P01 - Roadmarking & Signage.dwg	
Drawing No.	891015	RSK	ZZ	XX	DR C 7058 P01
Project	Orig.	Vol./Sys.	Lev./Loc.	Type	Role

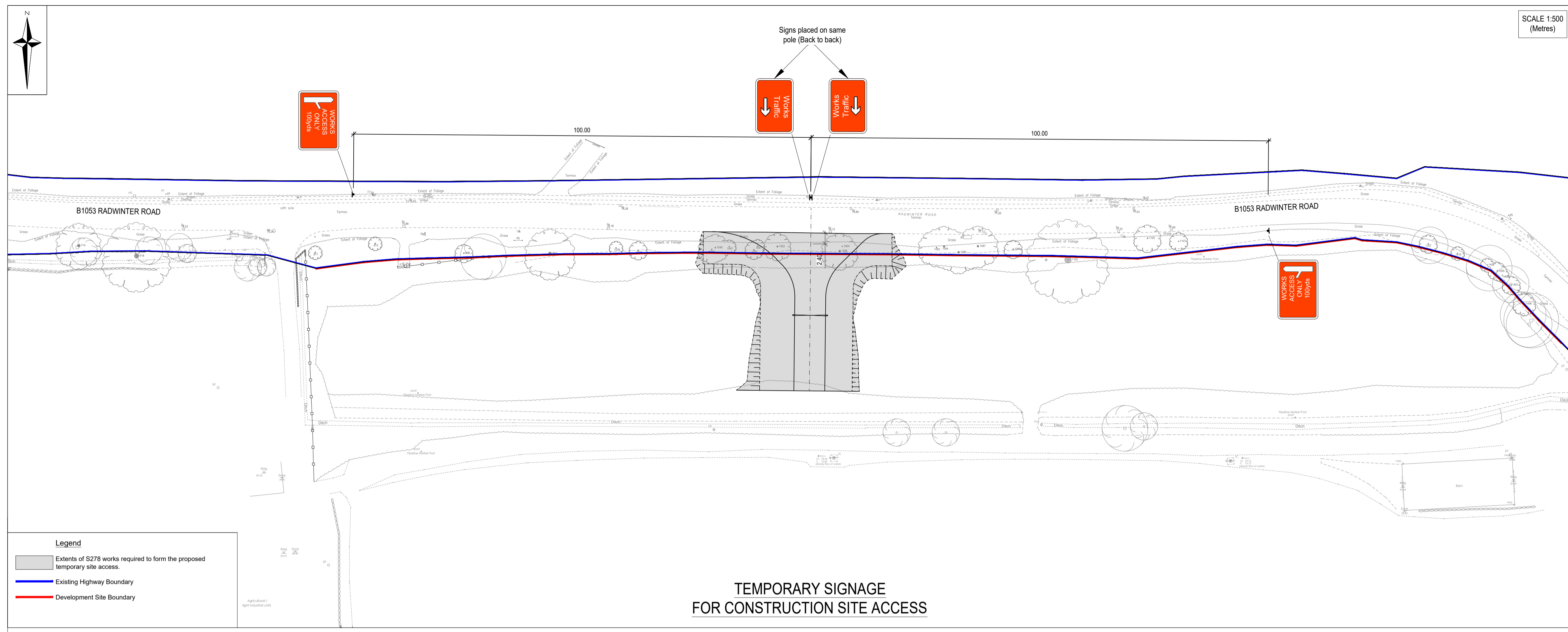

**TEMPORARY SIGNAGE
 FOR CONSTRUCTION SITE ACCESS**

