

Ground Floor Plan
1 : 50@A1

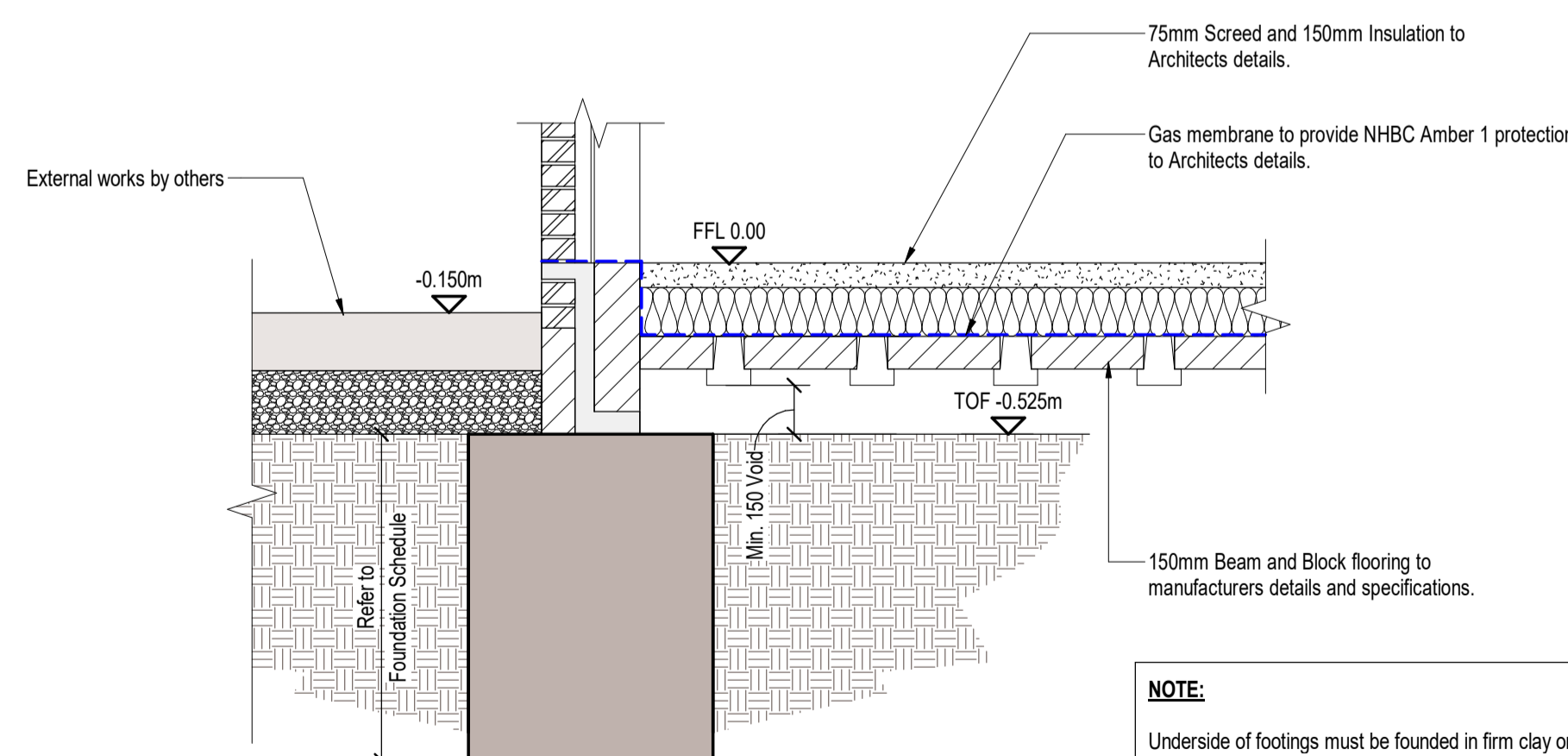

NOTE:
Underside of footings must be founded in firm clay or mudstone rockhead. Min bearing capacity = 115kN/m². Refer to foundation schedule for further details. Allowance to be made for over digging to ensure footings bear onto uniform weathered rock head. Building control inspector to approve foundation depths. If in doubt contact DICE Engineer.

Section 1-1
1 : 20@A1

Notes:

- This drawing is copyright and property of DICE. This drawing must not be reproduced in part or in whole without prior written Authority.
- This drawing must not be scaled from; any dimensional discrepancies to be reported to DICE prior to commencing construction and/or fabrication.
- This drawing must be read in conjunction with all other relevant specification and information prepared by DICE and all Architects and services setting out.
- All temporary works design and implementation are the responsibility of the Principal Contractor.
- All foundations to be set out centrally on walls U.N.O.
- Concrete for foundations to be grade FND2.
- All blockwork to be 7.3N/mm² aggregate concrete blockwork.
- All brickwork below DPC to be class B engineering brick.
- All brickwork above DPC to Architect's specification with min. 20N/mm² compressive strength.
- Mortar below DPC to be M6 (iii).
- Mortar above DPC level to be M4 (ii).
- Contractor to allow for prestressed concrete lintels where services enter and exit through sub-floor walls.
- Sub-floor to be ventilated to achieve whichever gives the greater opening area of -
- 1500mm² per metre run of external wall
- 500mm² per m² of floor area
- Timber frame to be designed by specialist supplier. Soleplate fixing details to timber frame designer's specification.
- DPM, DPC and cavity tray details to Architect's specification.
- All substructure setting out and ground floor/soleplate fixing details to be approved by Timber Frame designer prior to construction.

Key:

B&B 150mm Beam and Block Flooring by Specialist Manufacturers. Finishes and Insulation to Architects Details and Specification.

Plot 152, 153, 157, 158, 161, 162, 163, 164, 165, 166

CS1	Construction Issue	SP	JSK/SdJ	19/03/24
Rev:	Amendments:	Drawn by:	CHK/ Apr	Date:
Project: Abbeville Park, Burgess Hill				
Client: Places for People Ltd				
Drawing Title: Semi Dall AS_OPP - Foundation Plan				
Drawing Number: Project/Originator/Volume/Level/Type/Revision/Date FBW-DCE-DA-FN-DR-S-1936				
Revision:	Status Code:	DICE Project Number:	Scale (s)	
C01	S4	101101	1:50@A1; U.N.O	
Drawn By:	Checked By:	Approved By:	Date:	
SP	JSK	SdJ	March 2024	
Status: CONSTRUCTION				
		0115 302 8752 info@diceconsult.co.uk diceconsult.co.uk Third Floor The Courtyard, 35-37 St Mary's Gate, Nottingham NG1 1PU Design Infrastructure Consulting Engineers		
© Crown Copyright 2023 All Rights Reserved				