

- Drawing Legend (Where Applicable)**
- ▶ Joist Start Layout Point    ▶ Poly Start Layout Point
- ▣ All Closure Blocks Must Be Bedded
- ▣ Void Vent Position - see Architects plans for cross venting
- ⊕ Service Hole Position
- 150mm Floor Joists At 588mm Centres Unless Otherwise Stated (Poly)
- 318 150mm Floor Joists With 270mm Poly Panel Between (Poly)
- Beam weight = 24kg/m Manufactured in 25mm Increments
- Oversheet not required on these bays (if oversheet design)
- All Internal load bearing walls must be built through before topping is applied. Additional shuttering may be required.
- ▣ Non loadbearing walls can be filled with poly (hatched).

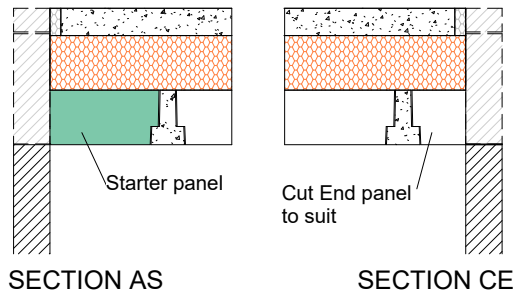
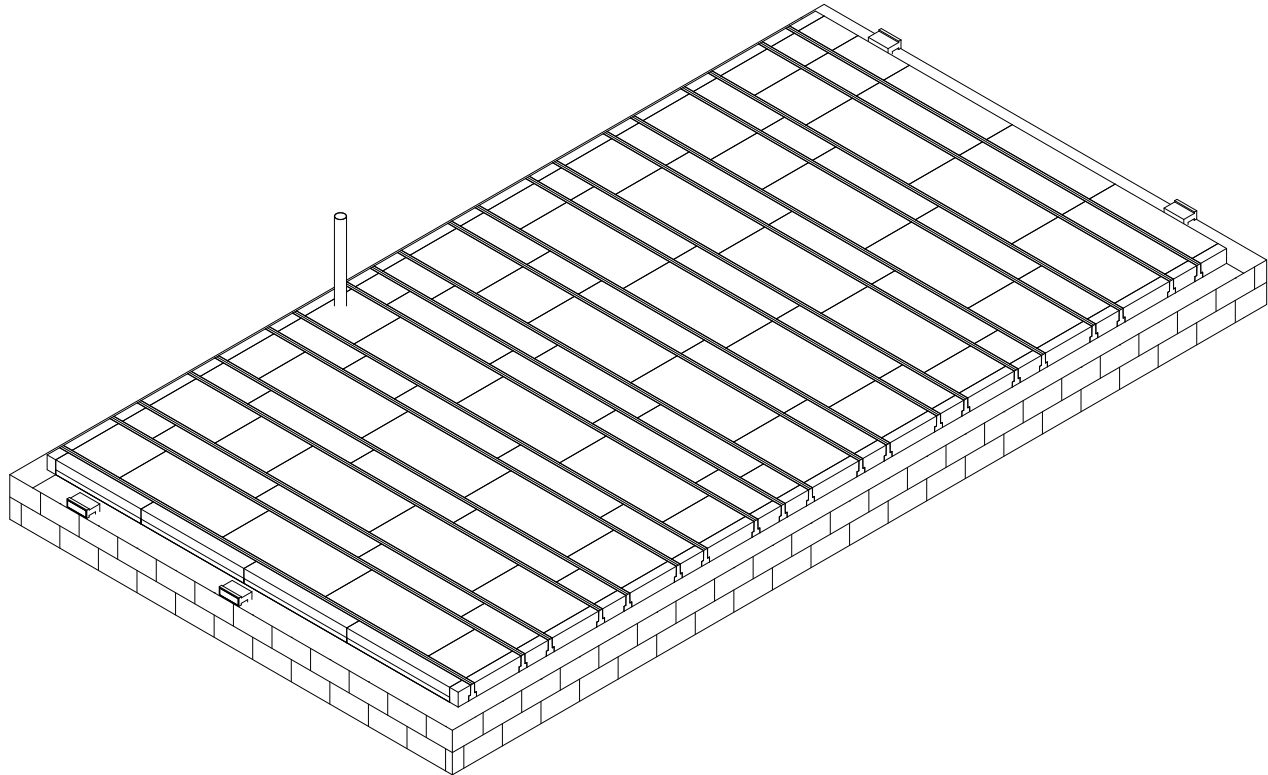
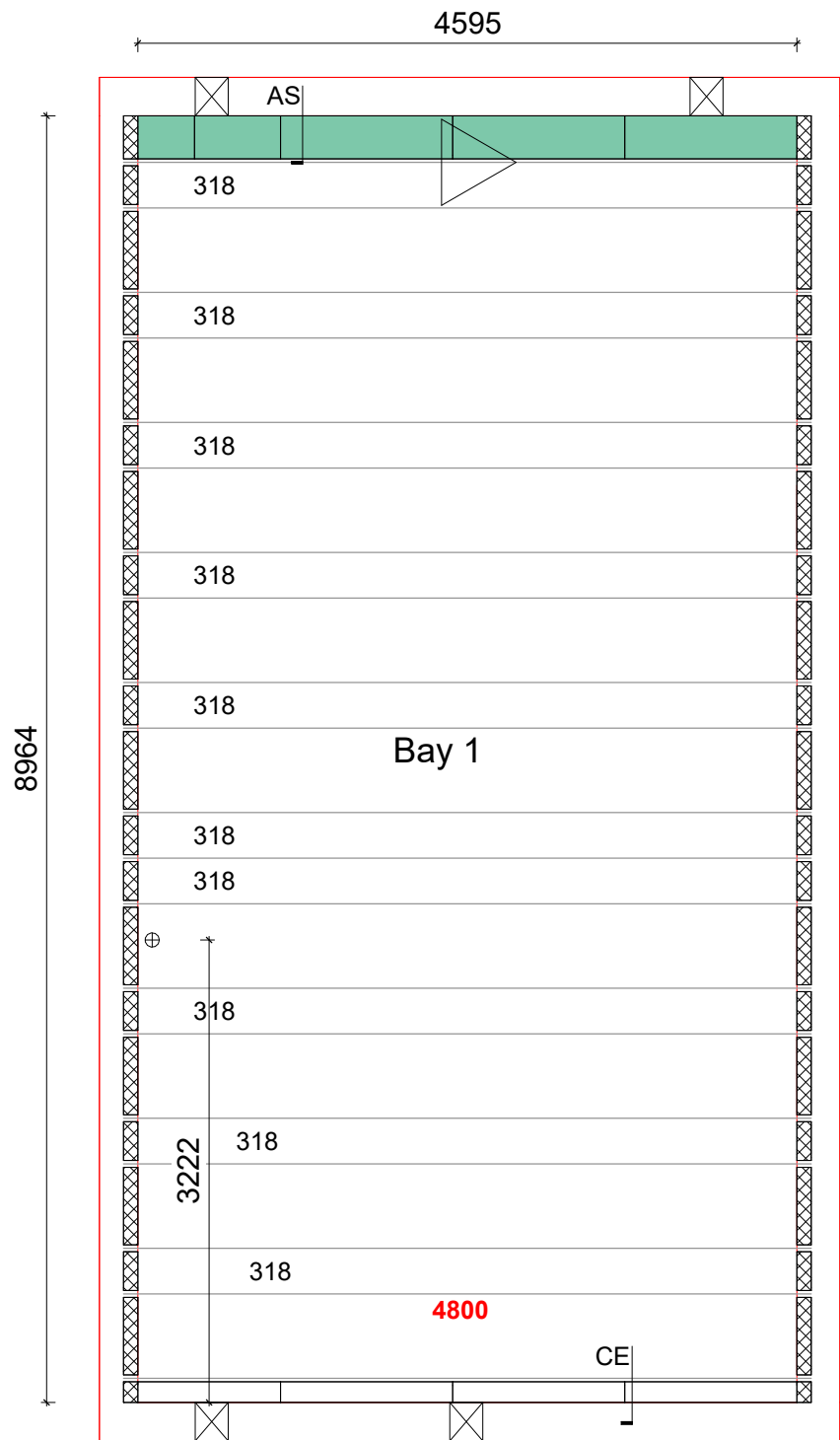

DESIGN CRITERIA  
Design does not allow for Underfloor Heating Systems to be installed within the floor, please contact CUBE6 to discuss options.  
PARTITIONS - 0.5kN/m² Non Load Bearing Stud  
FINISHES - 1.725kN/m² 75mm Structural Topping  
OTHER INFILLS - EPS Panel

Imposed Loads KN/m2  
BayImposed LoadPartition Type  
11.5Part Stud Partition

Ancillaries Schedule - With Panels  
Prod. CodeDescriptionCount  
ANC-OS15WFOS15 540mm Infill Panel (White)35  
ANC-OS15WHOS15 270mm Infill Panel (White)39  
ANC-OS15WSOS15 300mm End Panel (White)8  
ANC-PES75P75mm Poly Edge Strip (Platinum)25  
ANC-LCB100mm Large Closure Block - 7.3N21  
ANC-SCB100mm Small Closure Block - 7.3N20  
ANC-AB31201 Air Brick4  
ANC-UV1201 Telescopic Vent - 5-7 Courses4

Beam Schedule  
DescriptionWiresLengthBay NoQty  
150mm Floor Joist44800120

Product - W150 Panel combined with P150mm Oversheet

THERMAL VALUES  
PERIMETER/AREA VALUE - 0.222  
TARGET U VALUE - 0.12 ACTUAL U VALUE - 0.11

a amended to suit latest drawingsEH29/05/24  
REVDESCRIPTIONINI DATE  
(Area\*10=Approx Quantity Required)  
TOTAL LENGTHS AND AREA  
150mm - Length OversheetsInternal Floor Area  
96.000 m14.3 no. OS150P41 m²

HOUSE TYPE  
Holt Mid

SITE  
Fairbridge Way, Phase 3, Burgess Hill, RH15 8BF

CUBE6  
PRECAST CONCRETE FLOORING

PRODUCT  
DRAWN BY  
evie@cube6.co.uk  
DATE  
26/10/2023  
DRG No  
231550-9-W150P  
a