

dMEV fan shown relates to 2021 interim regulations only

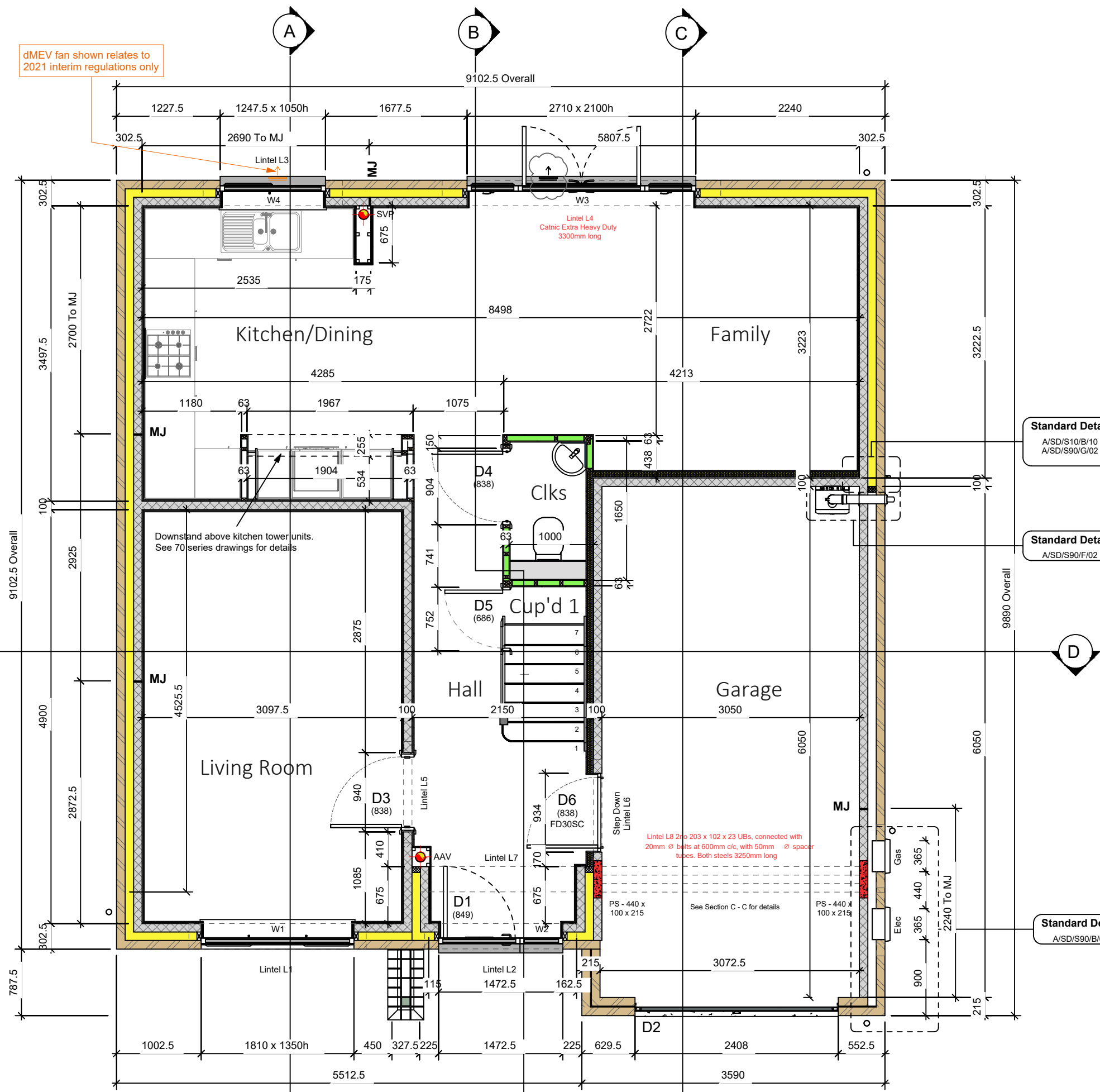

Wall Legend - Brick (100mm Cavity) Int Gar.

	Standard External Insulated Cavity Wall - 0.24W/m²K 102.5mm facing brickwork 100mm cavity filled with blown mineral fibre insulation 100mm aerated concrete block, K-value 0.11W/m²K, min strength 2.9N/mm² 12.5mm gypsum board on adhesive dabs
	Mid Strength External Insulated Cavity Wall - 0.25W/m²K 102.5mm facing brickwork 100mm cavity filled with blown mineral fibre insulation 100mm aerated concrete block, K-value 0.15W/m²K, min strength 3.6N/mm² 12.5mm gypsum board on adhesive dabs
	High Strength External Insulated Cavity Wall - 0.26W/m²K 102.5mm facing brickwork 100mm cavity filled with blown mineral fibre insulation 100mm aerated concrete block, K-value 0.19W/m²K, min strength 7.3N/mm² 12.5mm gypsum board on adhesive dabs
	External Uninsulated Cavity Wall (to garage, cold roof space etc.) 102.5mm facing brickwork 100mm air cavity 100mm aerated concrete block min strength 2.9N/mm²
	External Garage Wall 102.5mm facing brickwork 10mm air cavity 102.5mm facing brickwork
	Internal Blockwork Partition Between Dwelling and Garage 100mm aerated concrete block min strength 2.9N/mm² 63mm British Gypsum Thermaline PIR Plasterboard on adhesive dabs
	Internal Blockwork Partition 12.5mm gypsum board on adhesive dabs 100mm aerated concrete block min strength 2.9N/mm² 12.5mm gypsum board on adhesive dabs
	Structural Stud Partition 12.5mm gypsum board 12.5mm sheathing to detail 63 x 38mm timber studs (studs and noggings rotated through 90°) 12.5mm gypsum board 12.5mm sheathing to detail
	Structural Stud Partition with Acoustic Insulation 12.5mm gypsum board 12.5mm sheathing to detail 63 x 38mm timber studs (studs and noggings rotated through 90°) with Isover APR 1200 acoustic 12.5mm gypsum board 12.5mm sheathing to detail
	Non-Load Bearing Stud Partition 12.5mm gypsum board 63 x 38mm timber studs 12.5mm gypsum board
	Stud Partition with Acoustic Insulation 12.5mm gypsum board 63 x 38mm timber studs, with 65mm thick Isover APR 1200 acoustic insulation packed between 12.5mm gypsum board
	Wind Post Ancon WP3 or similar within external wall cavity, designed for 7kN ULS load

Note:- all blockwork drawn blue to be 7.3N/mm² as per Structural Engineers comments.
Refer to relevant Construction Specification for either and 2021 Build regs for further details.
This drawing must be read in conjunction with 25 series drawings.
ALL MOVEMENT JOINTS TO BE CONFIRMED AS REQUIRED AND SUITABLE BY S.ENG

C1 2025.04.14 GM IJC issued for Construction.
Rev: Date: By: Checked: Desc:

CONSTRUCTION

Luminous House, 300 South Row, Milton Keynes. MK9 2FR
T: 01438 359816
E:enquiries@arkonassociates.co.uk
www.arkonassociates.co.uk

CLIENT: BELLWAY HOMES LTD. (NORTH LONDON)

PROJECT: FORSTER PARK, STEVENAGE (PHASE 2)
WORKING DRAWINGS

TITLE: The Cutler
1335 ft² | 4b Det | All Variants
Ground Floor Setting Out Plan

SCALE: 1:50@A3 DATE: Sep 24 DRAWN BY: GM CHECKED: IJC
PROJ No: 5279 DWG No: CU1001 REV: C1

1 Ground Floor
1 : 50



Padstone Legend

