

### Wall Legend (100mm Cavity)

	Standard External Insulated Cavity Wall - 0.24W/m²K 102.5mm facing brickwork 100mm cavity filled with blown mineral fibre insulation* 100mm aerated concrete block, K-value 0.11W/m²K, min strength 2.9N/mm² 12.5mm gypsum board on adhesive dabs
	Standard External Insulated Cavity Wall Weatherboard - 0.24W/m²K Weatherboard to construction specification. 100mm aerated concrete block, K-value 0.15W/m²K, min strength 3.6N/mm² 100mm cavity filled with blown mineral fibre insulation* 100mm aerated concrete block, K-value 0.11W/m²K, min strength 2.9N/mm² 12.5mm gypsum board on adhesive dabs
	High Strength External Insulated Cavity Wall - 0.26W/m²K 102.5mm facing brickwork 100mm cavity filled with blown mineral fibre insulation* 100mm aerated concrete block, K-value 0.19W/m²K, min strength 7.3N/mm² 12.5mm gypsum board on adhesive dabs
	Internal Blockwork Partition 12.5mm gypsum board on adhesive dabs 100mm aerated concrete block min strength 2.9N/mm² 12.5mm gypsum board on adhesive dabs
	Structural Stud Partition 12.5mm gypsum board   12.5mm OSB2 sheathing 63 x 38mm timber studs (studs and noggings rotated through 90°) 12.5mm gypsum board   12.5mm OSB2 sheathing
	Structural Stud Partition with Acoustic Insulation 12.5mm gypsum board   12.5mm sheathing to detail 63 x 38mm timber studs (studs and noggings rotated through 90°) with Isover APR 1200 acoustic 12.5mm gypsum board   12.5mm sheathing to detail
	Non-Load Bearing Stud Partition 12.5mm gypsum board   63 x 38mm timber studs   12.5mm gypsum board
	Stud Partition with Acoustic Insulation 12.5mm gypsum board 63 x 38mm timber studs, with 65mm thick Isover APR 1200 acoustic insulation packed between 12.5mm gypsum board
	Wind Post Ancon WP3 or similar within external wall cavity, designed for 7kN ULS load

Note:- all blockwork drawn blue to be 7.3N/mm² as per Structural Engineers comments.  
Refer to relevant Construction Specification for either and 2021 Build regs for further details  
This drawing must be read in conjunction with 25 series drawings.  
ALL MOVEMENT JOINTS TO BE CONFIRMED AS REQUIRED AND SUITABLE BY S.ENG

### Padstone Legend

	Padstones To size stated on drawing and S.Eng spec.
--	--

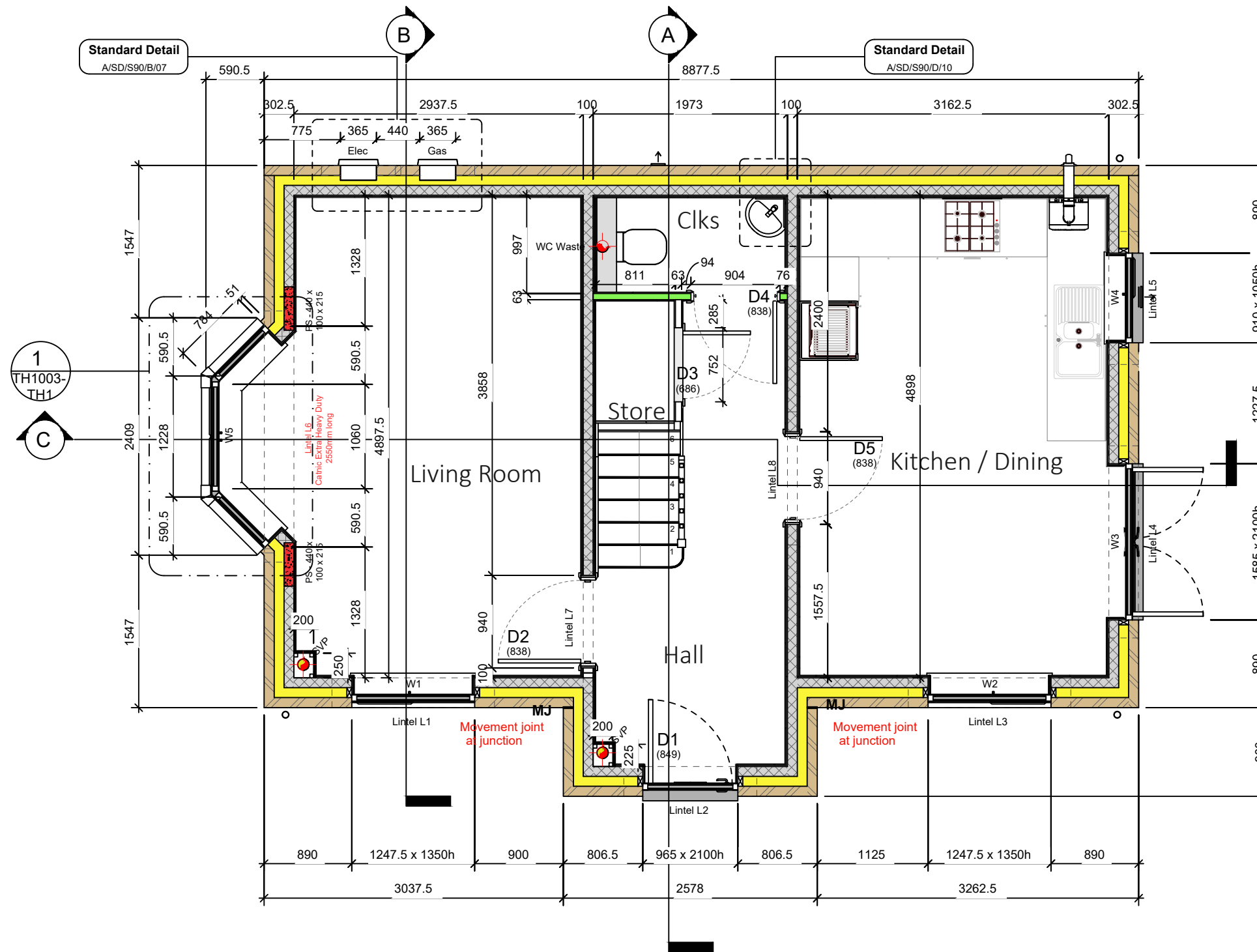

1 Ground Floor  
1 : 50



C1 2025.04.16 GM IJC issued for Construction.

Rev: Date: By: Checked: Desc:

### CONSTRUCTION

..\Bellway-19351451.png



Luminous House, 300  
South Row, Milton  
Keynes. MK9 2FR  
T: 01438 359816

CLIENT:  
BELLWAY HOMES LTD. (NORTH LONDON)

PROJECT:  
FORSTER PARK, STEVENAGE (PHASE 2)

WORKING DRAWINGS

TITLE:  
The Thespian

921 ft² | 3b Det | TH1

Ground Floor Setting Out Plan

SCALE: 1:50@A3 DATE: Oct 24 DRAWN BY: GM CHECKED: IJC

PROJ No: 5279 DWG No: TH1001-TH1 REV: C1