

Plots 560-561 FFL = 117.800m TOC = 116.975m
HT - Perilla - Perilla
 Scale 1:50

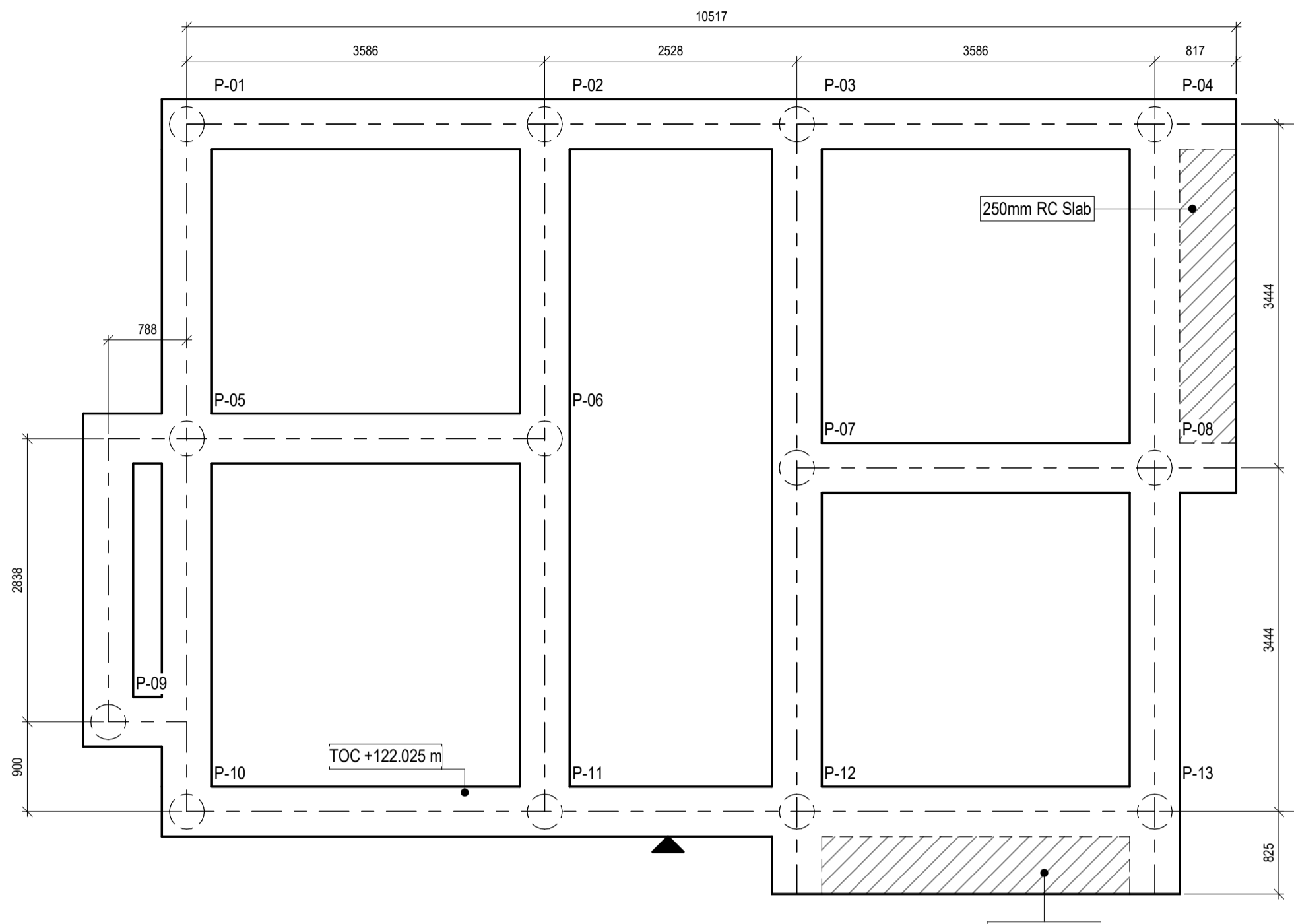

Plots 572 FFL = 122.850m TOC = 122.025m
HT - Angelica
 Scale 1:50

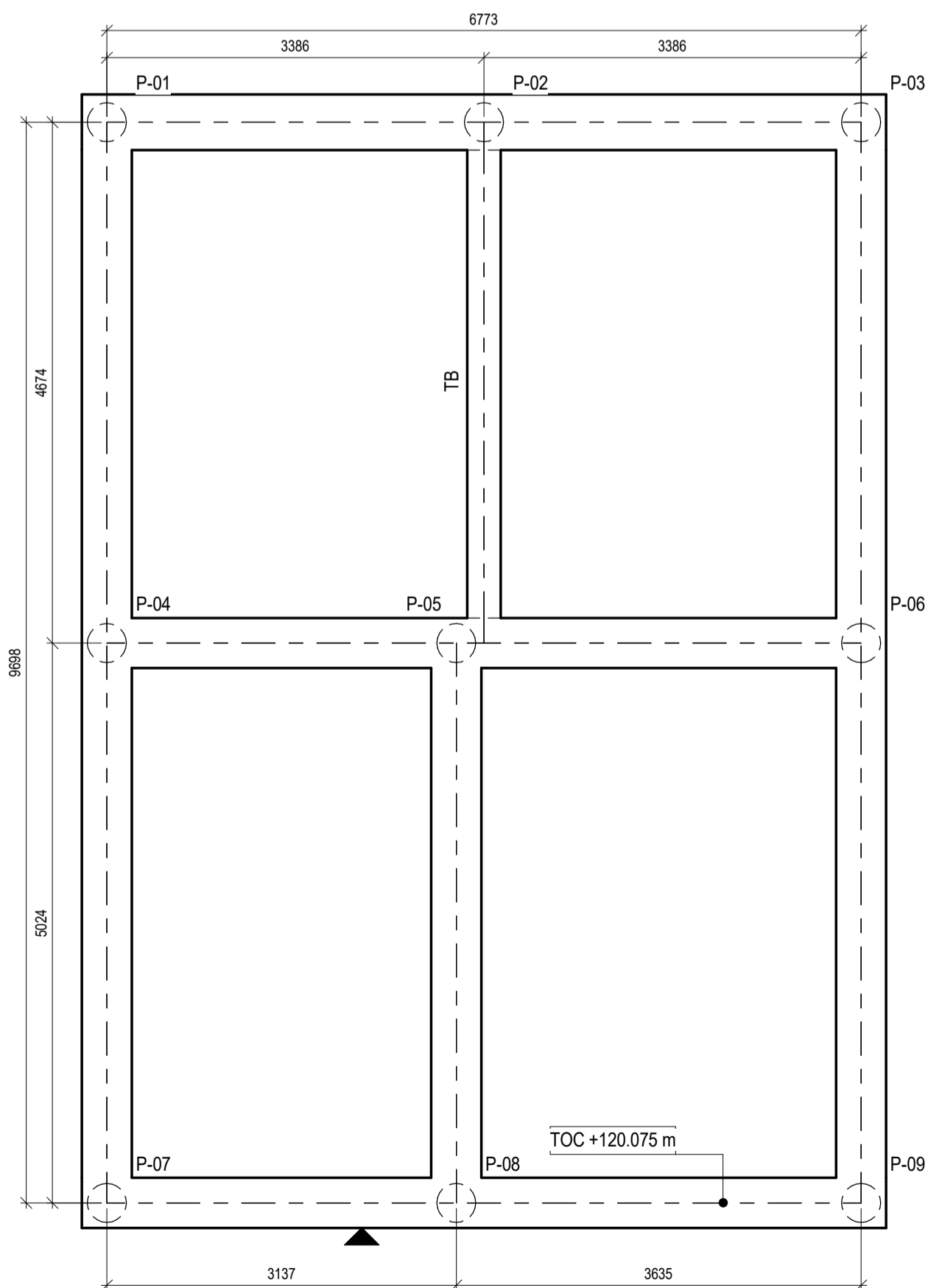

Plots 562 FFL = 120.900m TOC = 120.075m
HT - Ophelia
 Scale 1:50

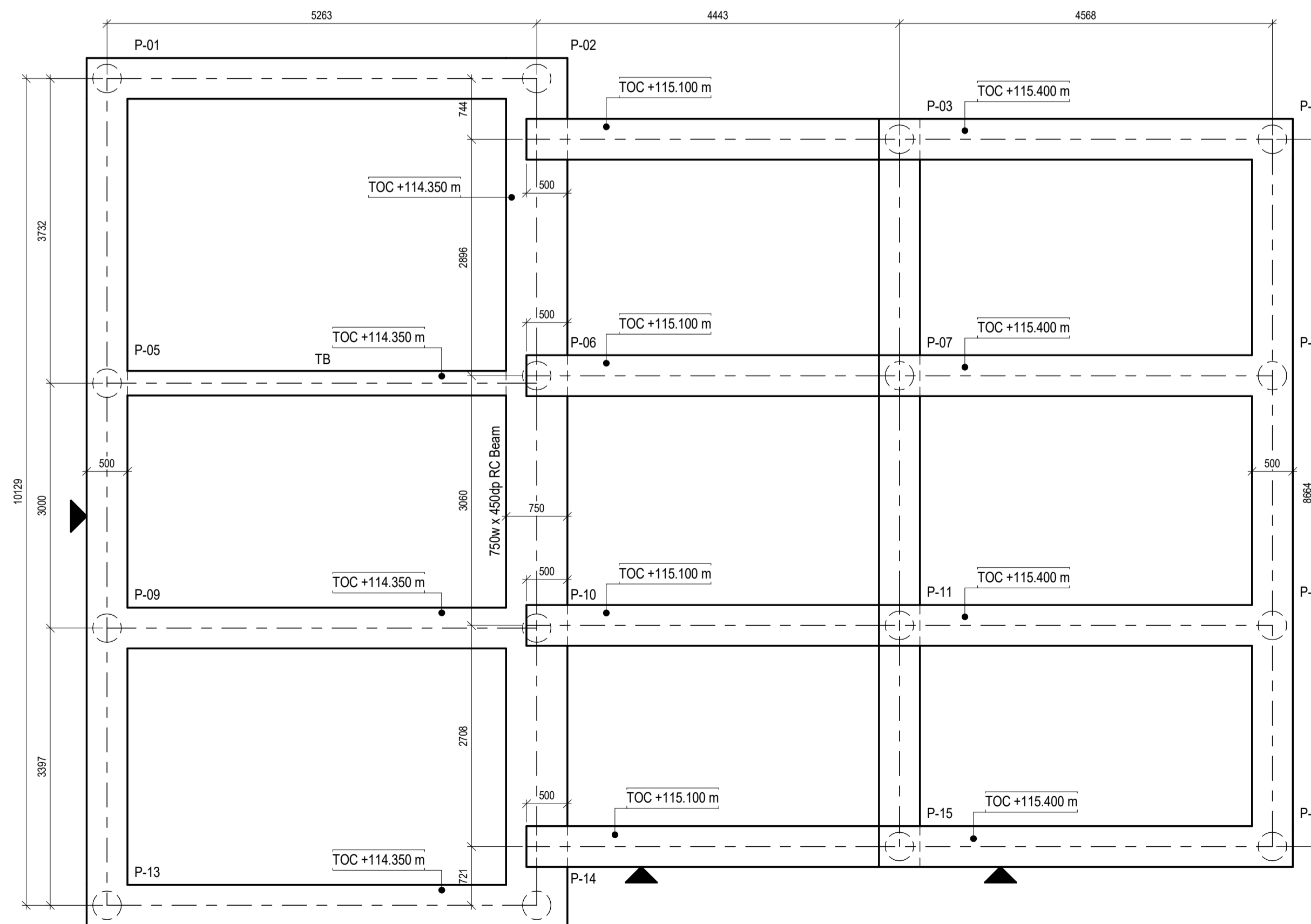

Plots 523 FFL = 115.175m TOC = 114.350m
 Plots 524 FFL = 115.925m TOC = 115.100m
 Plots 525 FFL = 116.225m TOC = 115.400m
HT - Alyssum - Freesia - Freesia
 Scale 1:50

Pile Schedule - Plot 560-561

Pile Number	Easting (m)	Northing (m)	Cut-off Level	Permanent Load (kN)	Variable Load (kN)	Pile Diameter (mm)
P-01	523654.115	22723.842	116.560	170	60	350
P-02	523651.155	22719.643	116.560	390	130	350
P-03	523648.194	22715.443	116.560	170	60	350
P-04	523651.009	22726.032	116.560	250	90	350
P-05	523648.049	22721.832	116.560	415	135	350
P-06	523645.088	22717.633	116.560	250	90	350
P-07	523648.115	22727.860	116.560	170	60	350
P-08	523645.455	22723.861	116.560	225	75	350
P-09	523642.494	22719.461	116.560	170	60	350
P-10	523642.861	22725.490	116.560	160	60	350
P-11	523642.861	22725.490	116.560	375	130	350
P-12	523639.900	22721.290	116.560	160	60	350

Pile Schedule - Plot 572

Pile Number	Easting (m)	Northing (m)	Cut-off Level	Permanent Load (kN)	Variable Load (kN)	Pile Diameter (mm)
P-01	523784.250	22719.836	121.610	160	50	350
P-02	523781.638	22719.294	121.610	220	70	350
P-03	523779.798	22719.026	121.610	300	150	350
P-04	523777.186	22717.484	121.610	300	100	350
P-05	523786.409	22719.130	121.610	230	75	350
P-06	523783.797	22719.588	121.610	300	100	350
P-07	523782.158	22719.534	121.610	400	150	350
P-08	523779.547	22719.992	121.610	300	100	350
P-09	523788.927	22719.656	121.610	230	75	350
P-10	523786.970	22719.851	121.610	160	50	350
P-11	523786.959	22719.309	121.610	230	70	350
P-12	523784.518	22720.042	121.610	350	150	350
P-13	523781.907	22720.499	121.610	300	100	350

Pile Schedule - Plot 562

Pile Number	Easting (m)	Northing (m)	Cut-off Level	Permanent Load (kN)	Variable Load (kN)	Pile Diameter (mm)
P-01	523707.824	22724.110	119.660	140	50	350
P-02	523705.410	22721.735	119.660	220	70	350
P-03	523702.996	22729.360	119.660	140	50	350
P-04	523704.546	22727.442	119.660	310	100	350
P-05	523702.310	22726.241	119.660	250	90	350
P-06	523699.719	22722.692	119.660	310	100	350
P-07	523701.023	22721.023	119.660	140	50	350
P-08	523698.787	22728.822	119.660	250	90	350
P-09	523696.195	22726.273	119.660	140	50	350

Pile Schedule - Plot 523-525

Pile Number	Easting (m)	Northing (m)	Cut-off Level	Permanent Load (kN)	Variable Load (kN)	Pile Diameter (mm)
P-01	523615.755	22719.289	113.935	220	70	350
P-02	523618.243	22714.907	113.935	350	150	350
P-03	523620.999	22718.469	114.685	250	150	350
P-04	523623.159	227162.494	114.985	150	70	350
P-05	523619.044	227148.504	113.935	250	70	350
P-06	523621.451	227153.185	113.935	350	150	350
P-07	523623.551	227157.100	114.685	350	150	350
P-08	523625.711	227161.125	114.985	250	100	350
P-09	523621.687	227147.086	113.935	300	100	350
P-10	523624.175	227151.724	113.935	400	150	350
P-11	523626.248	227155.653	114.685	350	150	350
P-12	523628.407	227159.678	114.985	250	100	350
P-13	523624.690	227145.400	113.935	220	70	350
P-14	523627.169	227150.118	113.935	350	150	350
P-15	523628.634	227154.373	114.685	250	150	350
P-16	523630.793	227158.398	114.985	150	70	350

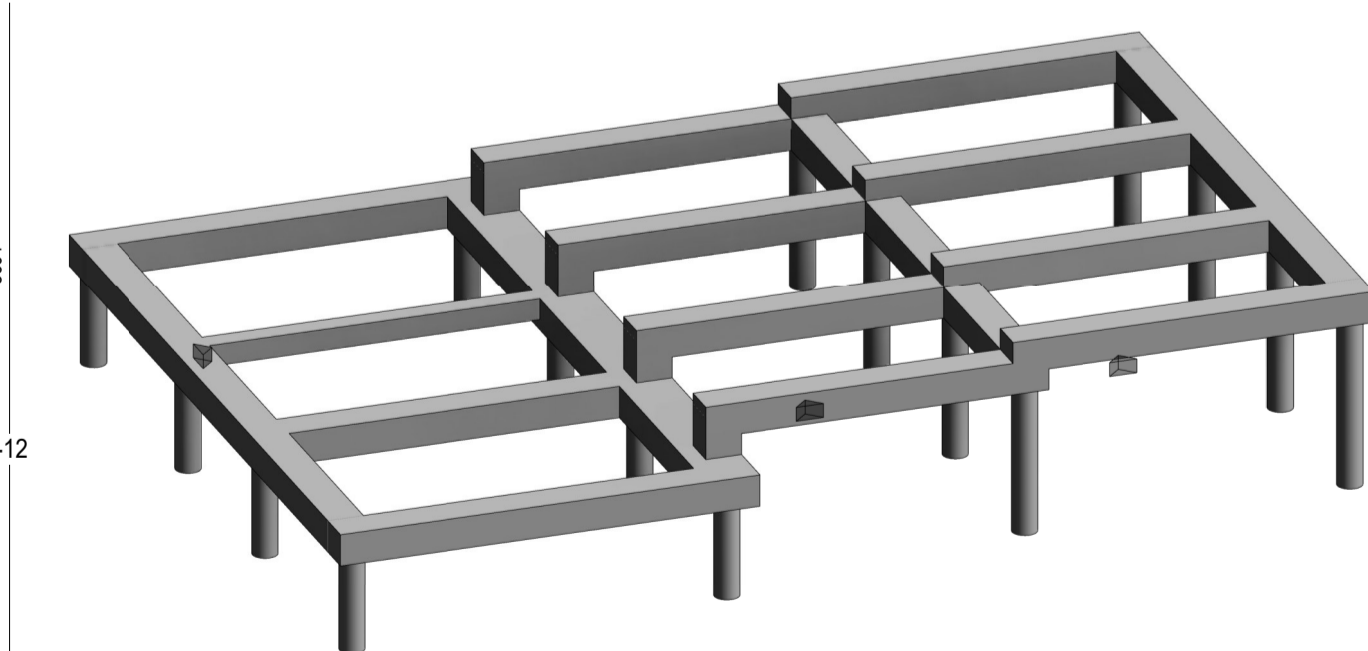

3D Structure Plot 523-525
 Scale

Legend:

- ▲ = Front of House/Garage
- H/T = House Type
- TOC = Top of Concrete
- FFL = Finished Floor Level

CONTRACTOR TO CHECK THE HANDING OF ALL PLOTS AGAINST SITE LAYOUT ENSURING THE HANDINGS MATCH

CIVIL / STRUCTURAL DESIGN RISK MANAGEMENT

Abnormal or unusual residual risks associated with the design outcomes shown on this drawing are:-

RSK LDE LTD has followed its Design Risk Management process for Hazard Elimination and Risk reduction in developing the designs shown on this drawing. Abnormal or unusual residual risks may be shown above where it is considered that such risk may not normally be expected by competent persons engaged on work of this nature or type.

Piling Notes:

- This drawing is to be read in conjunction with all relevant Architect's, Civil Engineering, MEP, and Engineer's drawings. Coordination between all relevant design team information is required during setting out. Centerlines of foundation as shown relate to the centerline of the wall obtained from the Architect block plans U.N.O.
- This drawing is to be read in conjunction with all RSK specifications.
- Concrete Specification**
 All substructure Concrete mix to be minimum grade C28/35 complying with design chemical class DC-1 (max 20mm aggregate size) and satisfy design sulphate class DS-1 and ACCEC aggressive chemical class AC-1 of BRE Special Digest 1 (2005)
- All reinforcement steel to be grade H500.
- All Ground Beams to be 500 x 450 deep U.N.O. All Tie Beams to be 300 x 300mm.
- Refer to RSK drawings 1342534-RSK-ZZ-00-FD-ST-1000 for typical sections and full notes regarding piles, design and testing regime.
- For RC detailing refer to RSK drawings 134534-RSK-ZZ-00-RC-ST-2000 onwards.
- Refer to drawings as 134534-RSK-ZZ-00-FD-ST-ZZ-1015 to 1018 For Heave Extent

Rev	Date	Construction Issue	Amendment	Drawn	Chkd	Appd
C1	09.03.26	Construction Issue		SJW	TN	VV

LDE
 CIVILS | STRUCTURES | HYDROLOGY
 an RSK company
 18 Frogmore Road, Hemel Hempstead, Hertfordshire, HP3 9RT
 Tel: +44 (0) 1442 437500
 Fax: +44 (0) 1442 437550
 Email: info@rsk.co.uk
 Web: www.rsk.co.uk

Client: **Ashberry Homes**

Project Title: **FORSTER PARK STEVENAGE PHASE 2B**

Status: **CONSTRUCTION**

Drawing Title: **PILED FOUNDATION GA FOR PLOTS 523-525, 560-561, 562 & 572,**

Drawn	Date	Checked	Date	Approved	Date
SJW	09.03.26	TN	09.03.26	VV	09.03.26

Scale	Orig Size	Dimensions
1 : 50	A1	mm

RSK Project No. **134534** File Name: 134534-RSK-ZZ-00-ZZ-ST-ZZ-

Drawing Reference	Rev.
134534 RSK ZZ 00 FD ST ZZ 1137	C1

Project No. Company Block Level Type Disc. Series Draw No.

Scale: 0 1 2 3 4 5m