

Substructure Wall Legend (100mm Cavity)

	Standard External Insulated Cavity Wall (Below Ground) 100mm blocks (7.3N/mm ²) upto 150mm below external ground level, then class B engineering brickwork (102.5mm) to DPC level 100mm cavity with expanded polystyrene board (thermal conductivity 0.038 W/m ² /K) 100mm aerated concrete block / coursing bricks (7.3N/mm ²)
	External Uninsulated Cavity Wall (To Garage etc - Below Ground) 100mm blocks (7.3N/mm ²) upto 150mm below external ground level, then class B engineering brickwork (102.5mm) to DPC level 100mm cavity 100mm aerated concrete block / coursing bricks (7.3N/mm ²)
	Party Wall (Below Ground) 100mm aircrete block (7.3N/mm ²) 100mm cavity with expanded polystyrene board (thermal conductivity 0.038 W/m ² /K) 100mm aircrete block (7.3N/mm ²)
	Internal Blockwork Partition (Below Ground) 100mm aerated concrete block (7.3N/mm ²) (Suspended ground floor beam manufacturer's coursing blocks / bricks as required)
	Sleeper Wall 100mm aerated concrete block (7.3N/mm ²) to underside of suspended ground floor beams

Refer to current Construction Specification for further details

NB. 3.6N/mm² Blockwork may be used below DPC subject to Divisional Consulting Engineers Approval.

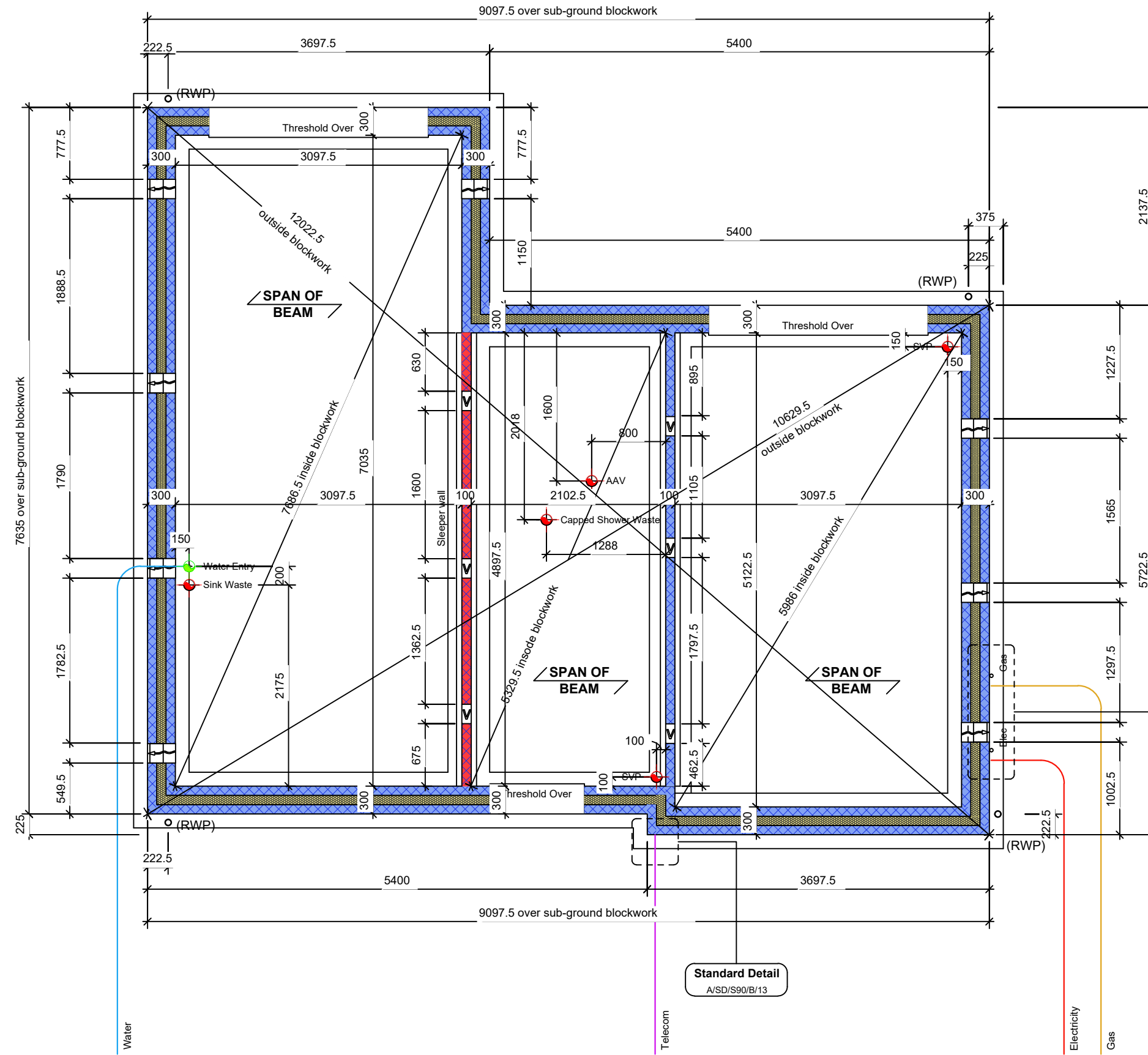

1 Foundation 1-50
1 : 50



Standard Detail
A/SD/S90/B/03
A/SD/S90/B/04
A/SD/S90/B/07

Standard Detail
A/SD/S90/B/13

Rev:	Date:	By:	Checked:	Desc:
------	-------	-----	----------	-------

TENDER

Luminous House, 300 South Row, Milton Keynes. MK9 2FR
T: 01438 359816
E: enquiries@arkonassociates.co.uk
www.arkonassociates.co.uk

CLIENT:
BELLWAY HOMES LTD. (NORTH LONDON)

PROJECT:
FORSTER PARK, STEVENAGE (PHASE 2B & 2D-2)
WORKING DRAWINGS

TITLE:
The Cardamine Life
1053 ft² | 3b Detached | ALL VARIANTS
Foundation Layout

SCALE: 1:50@A3	DATE: Aug 25	DRAWN BY: GM	CHECKED: IJC
PROJ No: 5304	DWG No: CR3001	REV: -	