

NOTE: GROUND FLOOR REAR ELEVATION BLOCKWORK TO BE CONSTRUCTED OF 7.3N/MM2 BLOCKS FROM FOUNDATION UP TO FIRST FLOOR LEVEL

Wall Legend (100mm Cavity)

	Standard External Insulated Cavity Wall - 0.24W/m²K 102.5mm facing brickwork 100mm cavity filled with blown mineral fibre insulation* 100mm aerated concrete block, K-value 0.11W/m²K, min strength 2.9N/mm² 12.5mm gypsum board on adhesive dabs
	Standard External Insulated Cavity Wall Weatherboard - 0.24W/m²K Weatherboard to construction specification. 100mm aerated concrete block, K-value 0.15W/m²K, min strength 3.6N/mm² 100mm cavity filled with blown mineral fibre insulation* 100mm aerated concrete block, K-value 0.11W/m²K, min strength 2.9N/mm² 12.5mm gypsum board on adhesive dabs
	High Strength External Insulated Cavity Wall - 0.26W/m²K 102.5mm facing brickwork 100mm cavity filled with blown mineral fibre insulation* 100mm aerated concrete block, K-value 0.19W/m²K, min strength 7.3N/mm² 12.5mm gypsum board on adhesive dabs
	Internal Blockwork Partition 12.5mm gypsum board on adhesive dabs 100mm aerated concrete block min strength 2.9N/mm² 12.5mm gypsum board on adhesive dabs
	Structural Stud Partition 12.5mm gypsum board 12.5mm OSB2 sheathing 63 x 38mm timber studs (studs and noggings rotated through 90°) 12.5mm gypsum board 12.5mm OSB2 sheathing
	Structural Stud Partition with Acoustic Insulation 12.5mm gypsum board 12.5mm sheathing to detail 63 x 38mm timber studs (studs and noggings rotated through 90°) with Isover APR 1200 acoustic 12.5mm gypsum board 12.5mm sheathing to detail
	Non-Load Bearing Stud Partition 12.5mm gypsum board 63 x 38mm timber studs 12.5mm gypsum board
	Stud Partition with Acoustic Insulation 12.5mm gypsum board 63 x 38mm timber studs, with 65mm thick Isover APR 1200 acoustic insulation packed between 12.5mm gypsum board
	W/P Wind Post Ancon WP3 or similar within external wall cavity, designed for 7kN ULS load

Note: all blockwork drawn blue to be 7.3N/mm² as per Structural Engineers comments. Refer to relevant Construction Specification for either and 2021 Build regs for further details. This drawing must be read in conjunction with 25 series drawings. ALL MOVEMENT JOINTS TO BE CONFIRMED AS REQUIRED AND SUITABLE BY S.ENG

Padstone Legend

	Padstones To size stated on drawing and S.Eng spec.
--	--

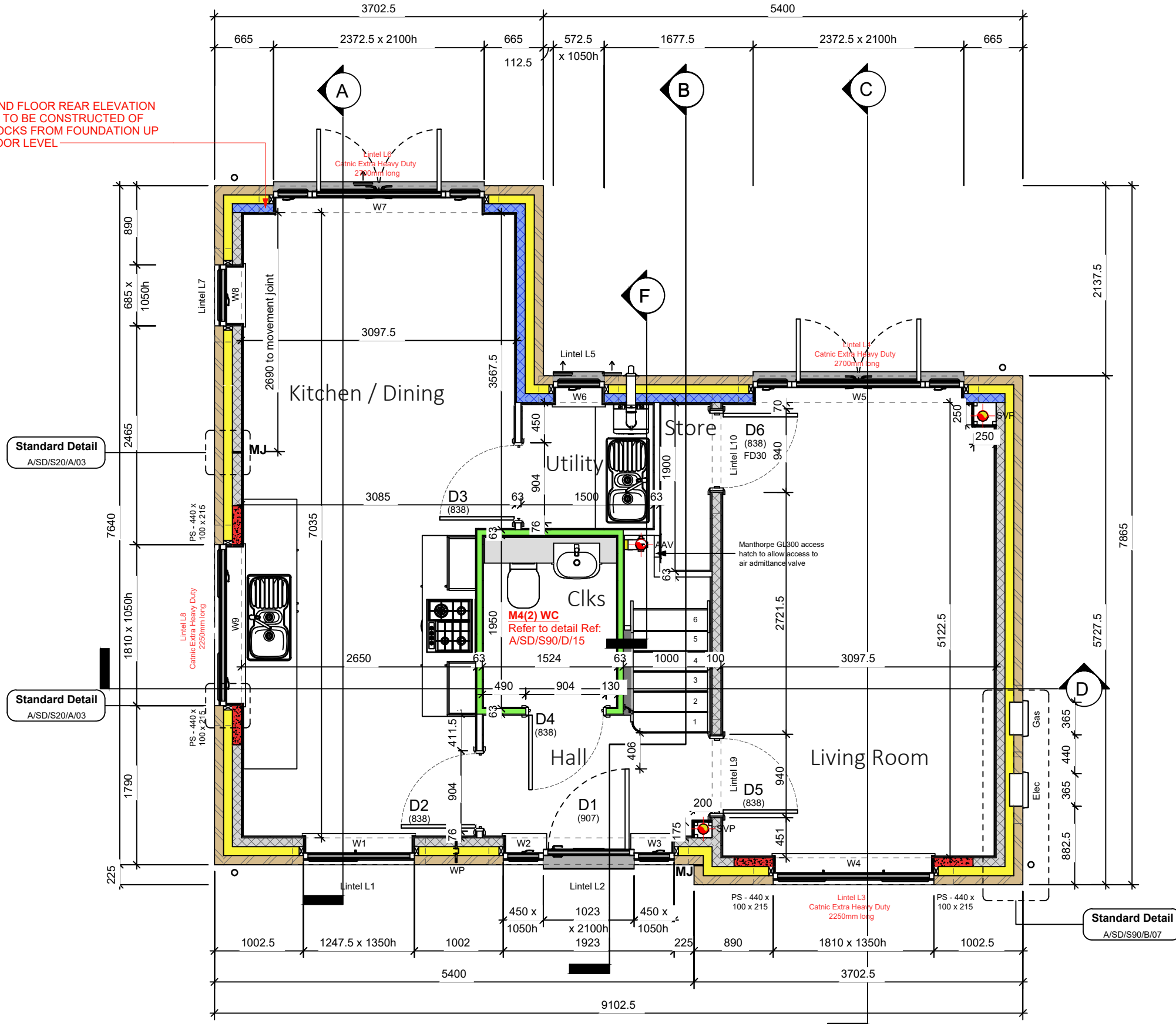

1 Ground Floor
1 : 50



Rev: Date: By: Checked: Desc:

TENDER

Ashberry Homes

arkonassociates
architecture + design

Luminous House, 300 South Row, Milton Keynes. MK9 2FR
T: 01438 359816
E: enquiries@arkonassociates.co.uk
www.arkonassociates.co.uk

CLIENT: BELLWAY HOMES LTD. (NORTH LONDON)

PROJECT: FORSTER PARK, STEVENAGE (PHASE 2)

WORKING DRAWINGS

TITLE: The Cardamine Life
1053 ft² | 3b Detached | CR1b
Ground Floor Setting Out Plan

SCALE: 1:50@A3 DATE: Nov 25 DRAWN BY: GM CHECKED: IJC

PROJ No: 5304 DWG No: CR1001-CR1b REV: -