

Wall Legend (100mm Cavity) - Attached

| | |
|--|--|
| | Standard External Insulated Cavity Wall - 240mm G 100mm facing brickwork 100mm cavity filled with blown mineral fibre insulation* 100mm vertical concrete block, K-value 0.110W/mK, min strength 2.9N/m ² 12.5mm gypsum board on adhesive data |
| | Standard External Insulated Cavity Wall - Weatherboard - 240mm G Weatherboard to construction specification 100mm vertical concrete block, K-value 0.110W/mK, min strength 2.9N/m ² 100mm cavity filled with blown mineral fibre insulation* 100mm vertical concrete block, K-value 0.110W/mK, min strength 2.9N/m ² 12.5mm gypsum board on adhesive data |
| | High Strength External Insulated Cavity Wall - 240mm G 100mm facing brickwork 100mm cavity filled with blown mineral fibre insulation* 100mm vertical concrete block, K-value 0.110W/mK, min strength 7.2N/m ² 12.5mm gypsum board on adhesive data |
| | Party Wall 100mm vertical concrete block, with density range between 600-800kg/m ³ 100mm Party Wall blown glass mineral wool insulation 100mm vertical concrete block, with density range between 600-800kg/m ³ 12.5mm gypsum board on adhesive data |
| | Internal Blockwork Partition Between Dwellings and Garage 100mm vertical concrete block, min strength 7.2N/m ² 6mm British Gypsum Thermaflex PFR Plasterboard on adhesive data |
| | Internal Blockwork Partition 100mm vertical concrete block, min strength 2.9N/m ² 12.5mm gypsum board on adhesive data |
| | Structural Stud Partition 12.5mm gypsum board 12.5mm OSB2 sheathing 45 x 90mm timber studs spaced and raftering rotated through 90° 12.5mm gypsum board 12.5mm OSB2 sheathing |
| | Structural Stud Partition with Acoustic Insulation 12.5mm gypsum board 12.5mm OSB2 sheathing 60 x 90mm timber studs spaced and raftering rotated through 90° with Acoustic APRI 1200 acoustic insulation packed between studs 12.5mm gypsum board 12.5mm OSB2 sheathing to detail |
| | 100mm Bricking Stud Partition 12.5mm gypsum board 60 x 90mm timber studs 12.5mm gypsum board |
| | Stud Partition with Acoustic Insulation 12.5mm gypsum board 60 x 90mm timber studs, with 65mm thick Acoustic APRI 1200 acoustic insulation packed between studs 12.5mm gypsum board |
| | WIP As per WIP or similar with external wall cavity, designed for TN LLS load |

Note: All blockwork should be to be 7.2N/m² as per Structural Engineers comments.
Refer to relevant Construction Specifications for other and 2021 Built Area for further details.
This drawing shall be read in conjunction with 20 other drawings.
ALL MOVEMENT JOINTS TO BE CONFIRMED AS REQUIRED AND SUITABLE BY S. ENG

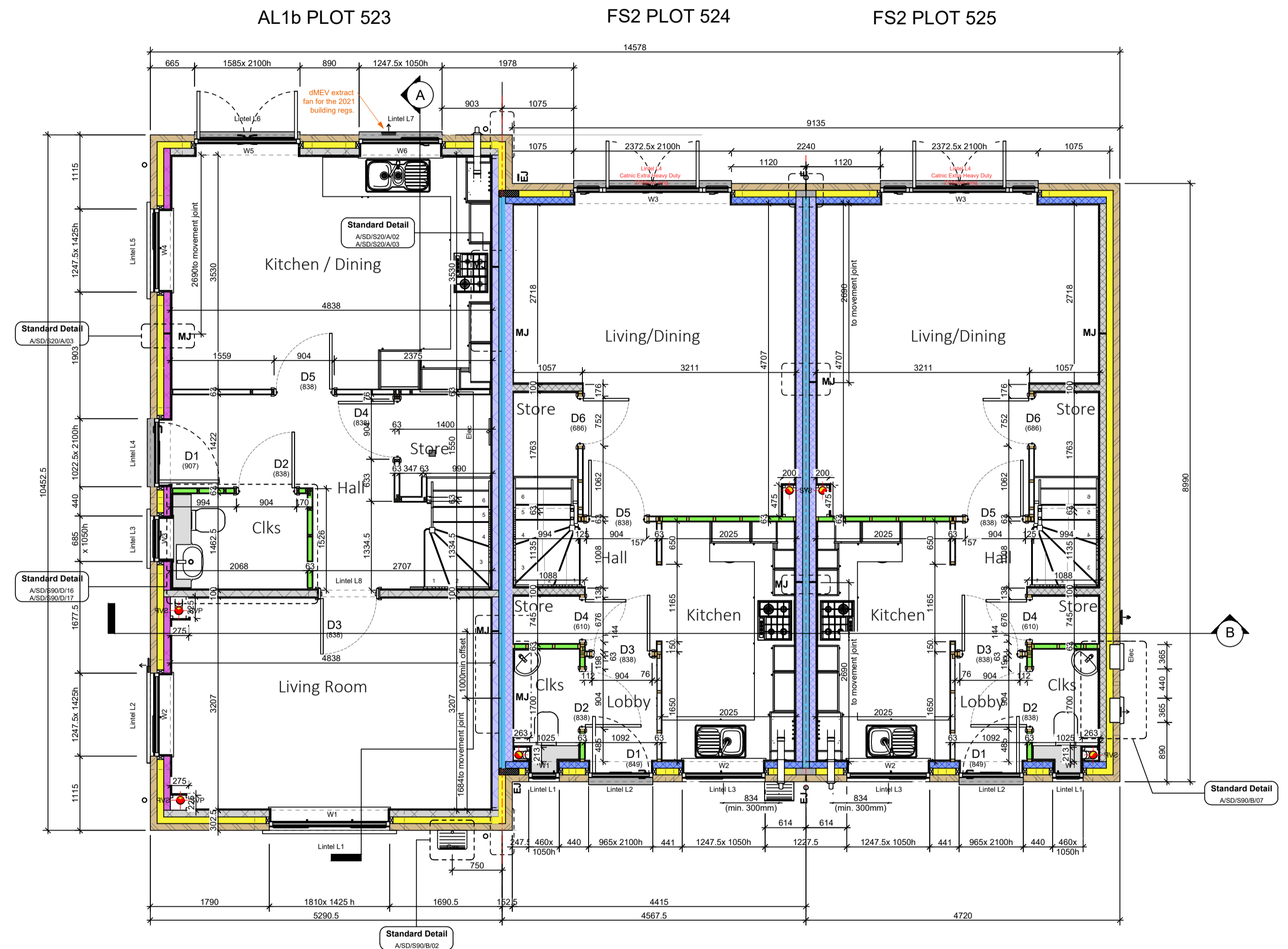

Rev: _____ Date: _____ By: _____ Checked: _____ Desc: _____

TENDER

Ashberry Homes **arkonassociates**

Luminous House, 300 South Row, Milton Keynes, MK9 2FR
T: 01438 359816
E: enquiries@arkonassociates.co.uk
www.arkonassociates.co.uk

CLIENT: BELLWAY HOMES LTD. (NORTH LONDON)

PROJECT: FORSTER PARK, STEVENAGE (PHASE 2)

WORKING DRAWINGS

TITLE: The Alyssum Life
1026 ft² | 3b Semi | AL1b & FS2
Block Ground Floor Setting Out Plan Plots 523-525

SCALE: 1:50@A1 DATE: Dec 25 DRAWN BY: GM CHECKED: LJC

PROJ. NO: 5304 DWG. NO: AL1001-BLK1 REV: _____