

PE1a PLOT 521

NOTE: GROUND FLOOR FRONT AND REAR ELEVATION BLOCKWORK TO BE CONSTRUCTED OF 7.3N/MM2 BLOCKS FROM FOUNDATION UP TO UNDERSIDE OF JOIST

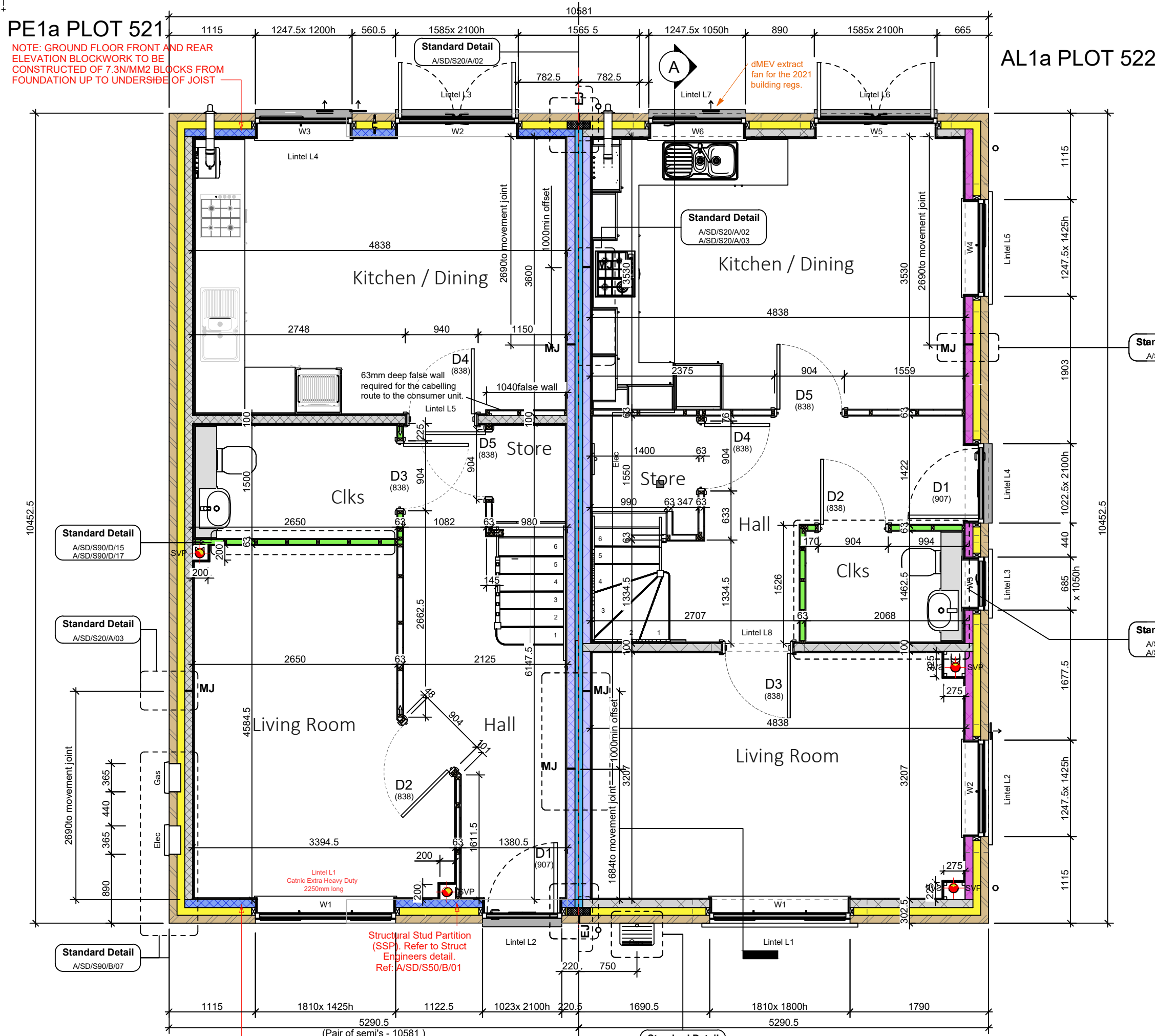

NOTE: GROUND FLOOR FRONT AND REAR ELEVATION BLOCKWORK TO BE CONSTRUCTED OF 7.3N/MM2 BLOCKS FROM FOUNDATION UP TO UNDERSIDE OF JOIST

1 Block Ground Floor Plan  
1 : 50

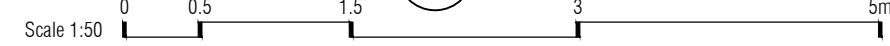

Wall Legend - Brick (100mm Cavity) Attached

	Standard External Insulated Cavity Wall - 0.24W/m <sup>2</sup> K 102.5mm facing brickwork 100mm cavity filled with blown mineral fibre insulation 100mm aerated concrete block, K-value 0.11W/m <sup>2</sup> K, min strength 2.9N/mm <sup>2</sup> 12.5mm gypsum board on adhesive dabs
	Mid Strength External Insulated Cavity Wall - 0.25W/m <sup>2</sup> K 102.5mm facing brickwork 100mm cavity filled with blown mineral fibre insulation 100mm aerated concrete block, K-value 0.15W/m <sup>2</sup> K, min strength 3.6N/mm <sup>2</sup> 12.5mm gypsum board on adhesive dabs
	High Strength External Insulated Cavity Wall - 0.26W/m <sup>2</sup> K 102.5mm facing brickwork 100mm cavity filled with blown mineral fibre insulation 100mm aerated concrete block, K-value 0.19W/m <sup>2</sup> K, min strength 7.3N/mm <sup>2</sup> 12.5mm gypsum board on adhesive dabs
	Party Wall 100mm aerated concrete block, with density range between 600-800kg/m <sup>3</sup> 100mm Party Wall blown glass mineral wool insulation 100mm aerated concrete block, with density range between 600-800kg/m <sup>3</sup> 12.5mm gypsum board on adhesive dabs
	Internal Blockwork Partition 12.5mm gypsum board on adhesive dabs 100mm aerated concrete block min strength 2.9N/mm <sup>2</sup> 12.5mm gypsum board on adhesive dabs
	Structural Stud Partition 12.5mm gypsum board   12.5mm sheathing to detail 63 x 38mm timber studs (studs and noggings rotated through 90°) 12.5mm gypsum board   12.5mm sheathing to detail
	Structural Stud Partition with Acoustic Insulation 12.5mm gypsum board   12.5mm sheathing to detail 63 x 38mm timber studs (studs and noggings rotated through 90°) with Isover APR 1200 acoustic 12.5mm gypsum board   12.5mm sheathing to detail
	Non-Load Bearing Stud Partition 12.5mm gypsum board 63 x 38mm timber studs 12.5mm gypsum board
	Stud Partition with Acoustic Insulation 12.5mm gypsum board 63 x 38mm timber studs, with 65mm thick Isover APR 1200 acoustic insulation packed between 12.5mm gypsum board
	Wind Post Ancon WP3 or similar within external wall cavity, designed for 7kN ULS load

Note: - all blockwork drawn blue to be 7.3N/mm<sup>2</sup> as per Structural Engineers comments. Refer to relevant Construction Specification for either and 2021 Build regs for further details. This drawing must be read in conjunction with 25 series drawings. ALL MOVEMENT JOINTS TO BE CONFIRMED AS REQUIRED AND SUITABLE BY S.ENG

Rev: Date: By: Checked: Desc:

TENDER

Luminous House, 300 South Row, Milton Keynes. MK9 2FR  
T: 01438 359816  
E: enquiries@arkonassociates.co.uk  
www.arkonassociates.co.uk

CLIENT: BELLWAY HOMES LTD. (NORTH LONDON)

PROJECT: FORSTER PARK, STEVENAGE (PHASE 2)

WORKING DRAWINGS

TITLE: The Alyssum Life

1026 ft<sup>2</sup> | 3b Semi | AL1a & PE1a

Block Ground Floor Setting Out Plan Plots 521-522

SCALE: 1:50@A3 DATE: Dec 25 DRAWN BY: GM CHECKED: IJC

PROJ No: 5304 DWG No: AL1001-BLK0b REV: -