

Wall Legend - Block / Render(100mm Cavity) - Split

	Standard External Insulated Cavity Wall - 0.24W/m²K 102.5mm facing brickwork 100mm cavity filled with blown mineral fibre insulation* 100mm aerated concrete block, K-value 0.11W/m²K, min strength 2.9N/mm² 12.5mm gypsum board on adhesive dabs
	Standard External Insulated Cavity Wall - Rendered - 0.24W/m²K 22mm monocouche through colour render to outer leaf. 100mm aerated concrete block, K-value 0.15W/m²K, min strength 3.6N/mm² 100mm cavity filled with blown mineral fibre insulation* 100mm aerated concrete block, K-value 0.11W/m²K, min strength 2.9N/mm² 12.5mm gypsum board on adhesive dabs
	High Strength External Insulated Cavity Wall - Rendered - 0.26W/m²K 22mm monocouche through colour render to outer leaf. 100mm aerated concrete block, K-value 0.15W/m²K 100mm cavity filled with blown mineral fibre insulation* 100mm aerated concrete block, K-value 0.19W/m²K, min strength 7.3N/mm² 12.5mm gypsum board on adhesive dabs
	Mid Strength External Insulated Cavity Wall - 0.25W/m²K 102.5mm facing brickwork 100mm cavity filled with blown mineral fibre insulation* 100mm aerated concrete block, K-value 0.15W/m²K, min strength 3.6N/mm² 12.5mm gypsum board on adhesive dabs
	High Strength External Insulated Cavity Wall - 0.26W/m²K 102.5mm facing brickwork 100mm cavity filled with blown mineral fibre insulation* 100mm aerated concrete block, K-value 0.19W/m²K, min strength 7.3N/mm² 12.5mm gypsum board on adhesive dabs
	Party Wall - block density range between 600-800kg/m³ 12.5mm gypsum board on adhesive dabs 100mm aerated concrete block, K-value 0.19W/m²K, min strength 7.3N/mm² 100mm Party Wall blown glass mineral wool insulation 100mm aerated concrete block, K-value 0.19W/m²K, min strength 7.3N/mm² 12.5mm gypsum board on adhesive dabs
	Party Wall 12.5mm gypsum board on adhesive dabs 100mm aerated concrete block, with density range between 600-800kg/m³ 100mm Party Wall blown glass mineral wool insulation 100mm aerated concrete block, with density range between 600-800kg/m³ 12.5mm gypsum board on adhesive dabs
	Split Level Party Wall at Second Floor 12.5mm gypsum board on adhesive dabs 102.5mm facing brick 100mm Party Wall blown glass mineral wool insulation 100mm aerated concrete block, with density range between 600-800kg/m³ 12.5mm gypsum board on adhesive dabs
	Internal Blockwork Partition 12.5mm gypsum board on adhesive dabs 100mm aerated concrete block, with density range between 600-800kg/m³ 12.5mm gypsum board on adhesive dabs
	Structural Stud Partition 12.5mm gypsum board 12.5mm OSB2 sheathing 63 x 38mm timber studs (studs and noggings rotated through 90°) 12.5mm gypsum board 12.5mm OSB2 sheathing
	Structural Stud Partition with Acoustic Insulation 12.5mm gypsum board 12.5mm sheathing to detail 63 x 38mm timber studs (studs and noggings rotated through 90°) with Isover APR 1200 acoustic 12.5mm gypsum board 12.5mm sheathing to detail
	Non-Load Bearing Stud Partition 12.5mm gypsum board 63 x 38mm timber studs 12.5mm gypsum board
	Stud Partition with Acoustic Insulation 12.5mm gypsum board 63 x 38mm timber studs, with 65mm thick Isover APR 1200 acoustic insulation packed between 12.5mm gypsum board
	Wind Post Ancon WP3 or similar within external wall cavity, designed for 7kN ULS load

Padstone Legend

	Padstones To size stated on drawing and S.Eng spec.
--	--

MJ required at brick to block junction

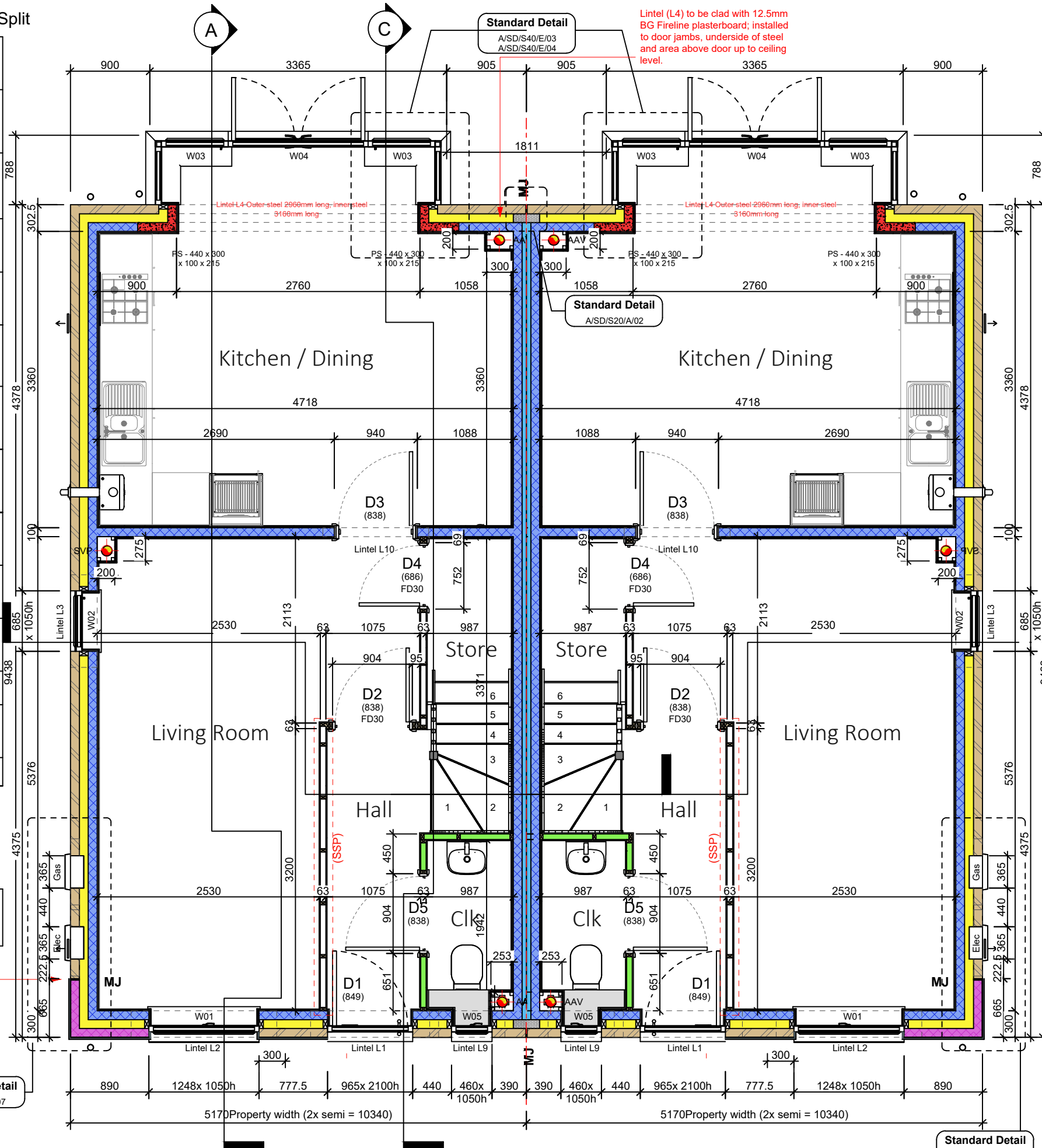

1 Block Ground Floor
1 : 50



Rev: Date: By: Checked: Desc:

TENDER

Ashberry Homes

arkonassociates
architecture + design

Luminous House, 300 South Row, Milton Keynes. MK9 2FR
T: 01438 359816
E:enquiries@arkonassociates.co.uk
www.arkonassociates.co.uk

CLIENT: BELLWAY HOMES LTD. (NORTH LONDON)

PROJECT: FORSTER PARK, STEVENAGE (PHASE 2)

WORKING DRAWINGS

TITLE: The Tulip
1248 ft² | 3b Semi | TU1
Block Ground Floor Setting Out Plan

SCALE: 1:50@A3 DATE: Jan 26 DRAWN BY: GM CHECKED: IJC

PROJ No: 5304 DWG No: TU1001-BLK REV: -