

HT - Wisteria
Scale 1 : 50

Plots 535 (Opp) FFL = 119.350m TOC = 118.525m
 Plots 587 (As) FFL = 122.700m TOC = 121.875m
 Plots 590 (As) FFL = 123.800m TOC = 122.975m

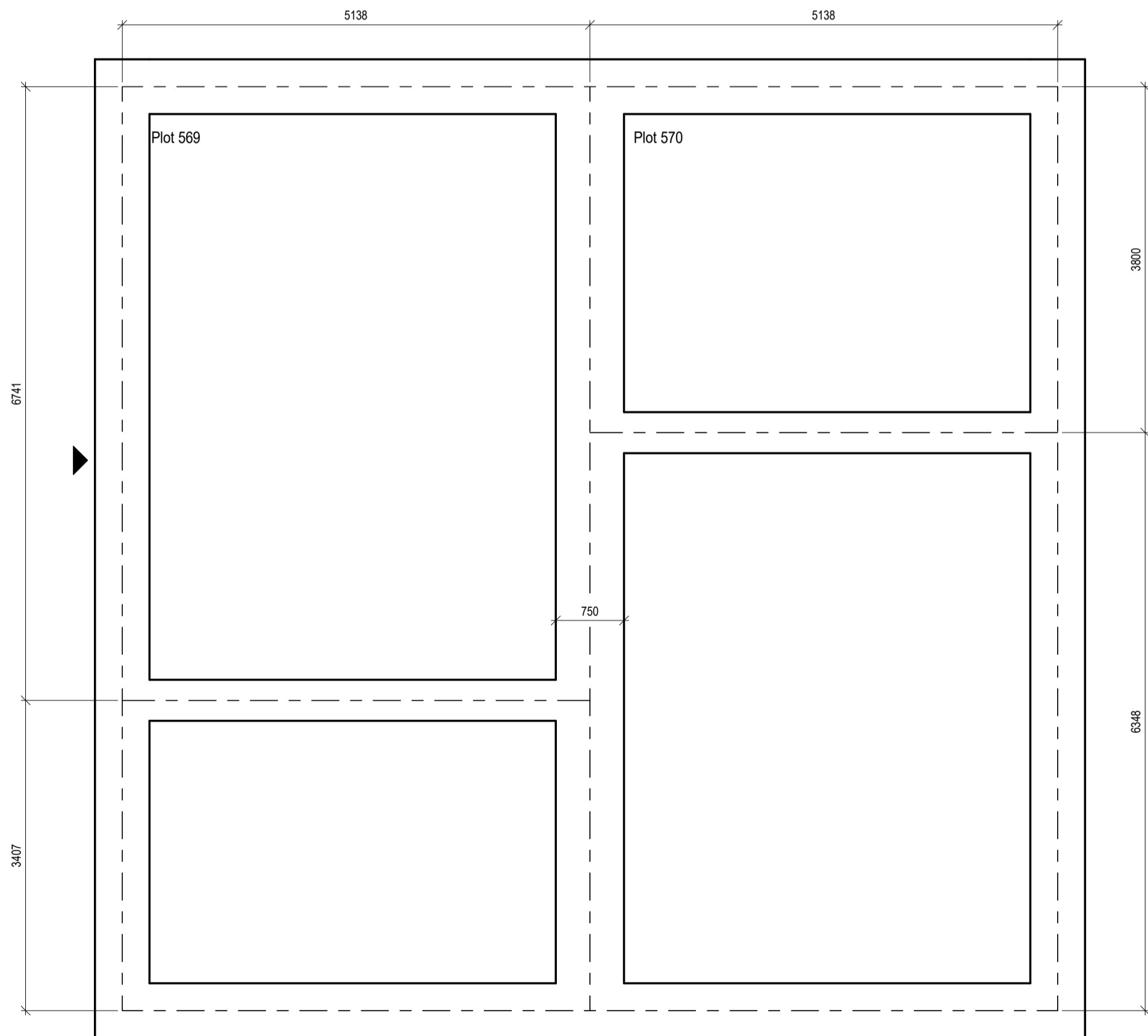

HT - Alyssum - Perilla
Scale 1 : 50

Plots 569-570 (As) FFL = 121.450m TOC = 120.625m

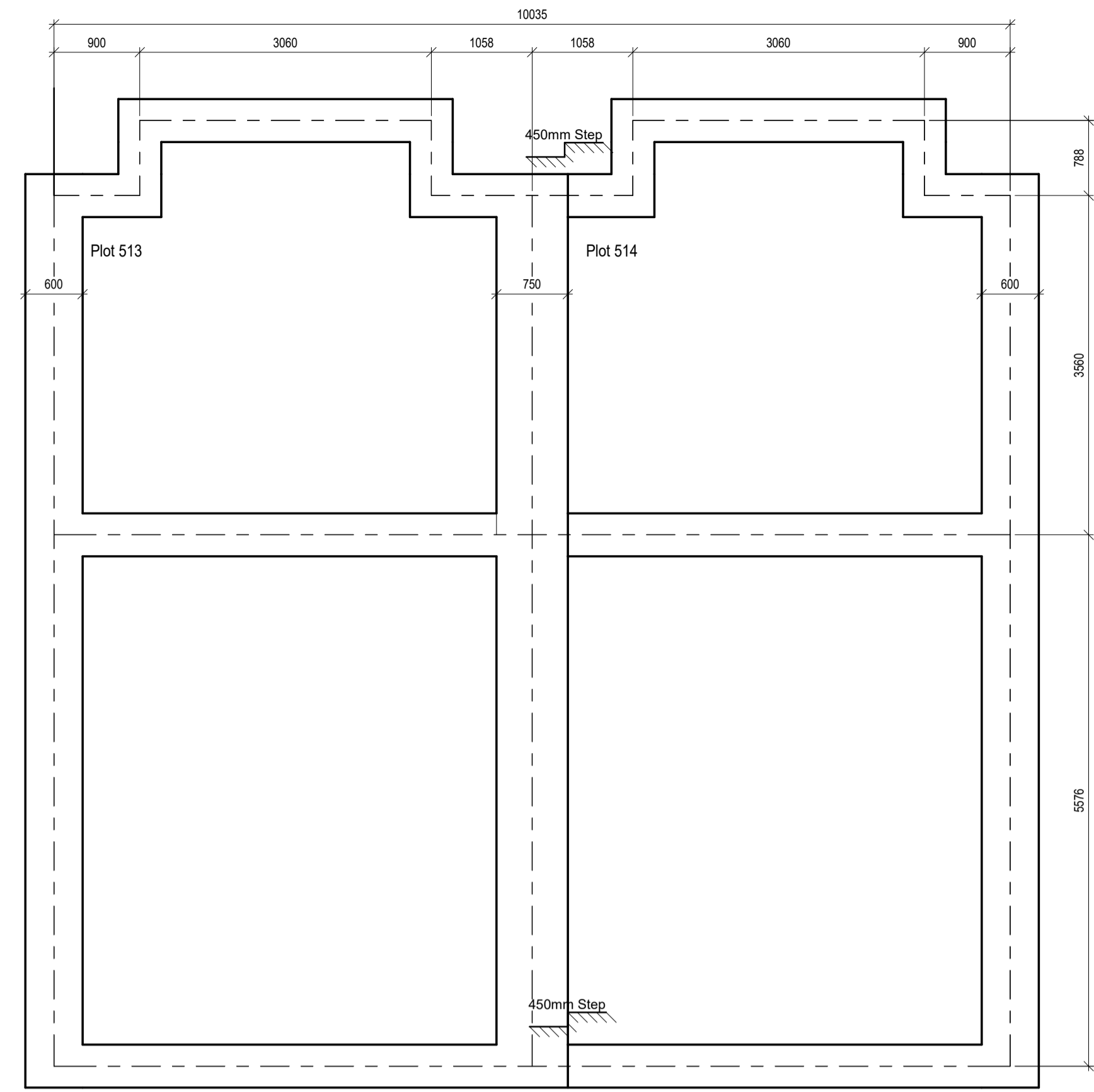

HT - Tulip - Tulip
Scale 1 : 50

Plots 513 (As) FFL = 117.850m TOC = 117.025m Plots 514 (As) FFL = 118.300m TOC = 117.325m

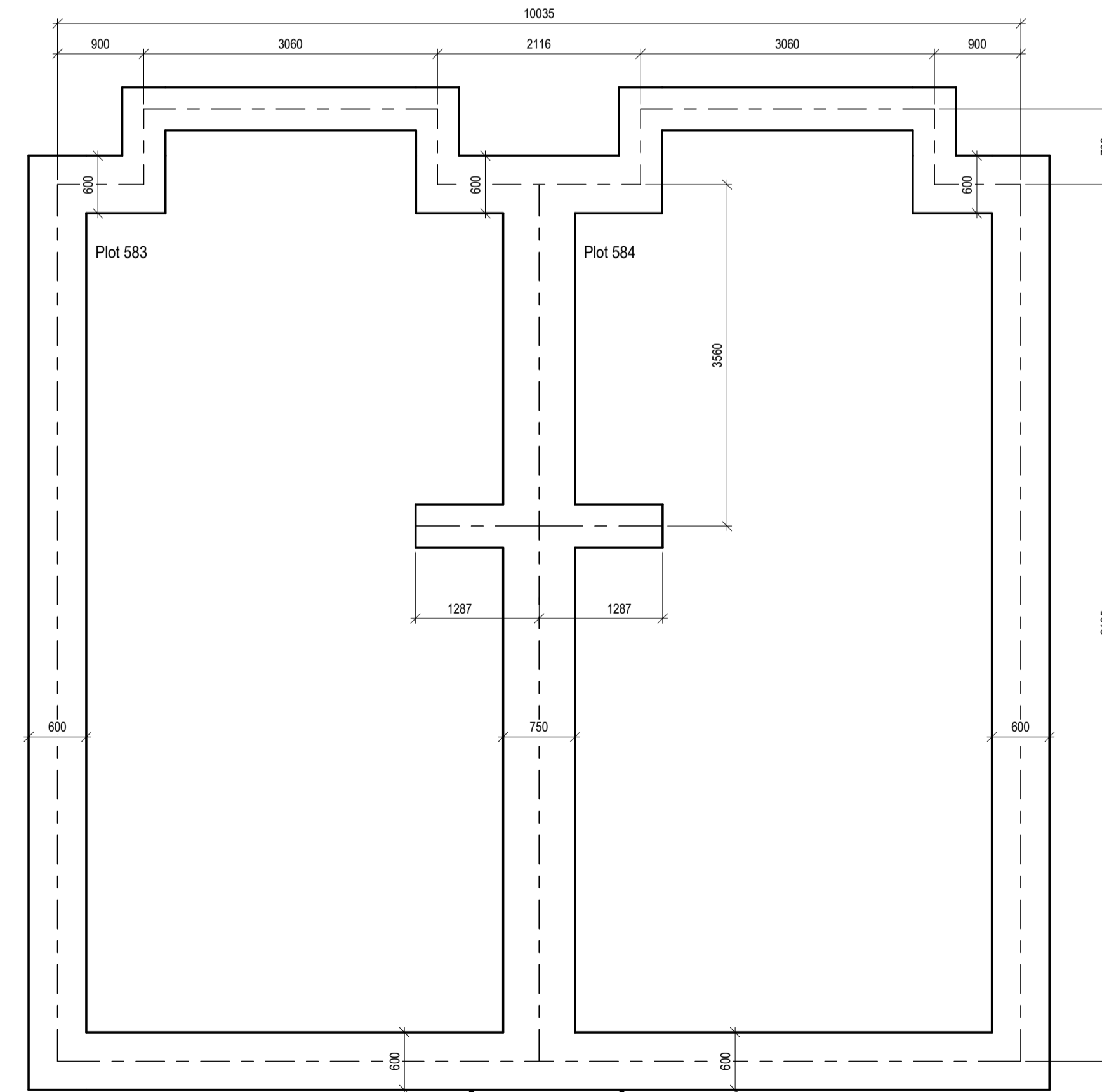

HT - Veronica - Veronica
Scale 1 : 50

Plots 583-584 (As) FFL = 122.000m TOC = 121.175m

CIVIL / STRUCTURAL DESIGN RISK MANAGEMENT

Abnormal or unusual residual risks associated with the design outcomes shown on this drawing are:-

RSK LDE LTD has followed its Design Risk Management process for Hazard Elimination and Risk reduction in developing the designs shown on this drawing. Abnormal or unusual residual risks may be shown above where it is considered that such risk may not normally be expected by competent persons engaged on work of this nature or type.

Trench Fill Foundations Notes:

Trench Fill Foundation Notes:

- Refer to RSK drawings as follows:
 - Foundation depths and tree influence zones : 134534-RSK-ZZ-00-FD-ST-ZZ-1010 onward
- Centre lines of foundations to be centre lines of walls U.N.O.
- The foundations should be brought up to 825mm below finished floor level for houses & flats and 600mm below finished floor level for garages unless the contractor wishes to minimise the depth of concrete and thus increase the height of the substructure blockwork accordingly (with due regard to providing sufficient room for services and drainage to pass over foundations).
- Foundations to contain precautionary nominal mesh reinforcement due to variable ground conditions. Introduce B785 mesh (min) top and bottom with main bars running along the line of the foundation. Cover to reinforcement to be a minimum of 50mm. This must be increased to 75mm where concrete is cast against earth faces (sides and underside if blinding is not used).
- Refer to architect's details for concrete cavity base fill level. Concrete to be GEN1.
- Foundation widths are based on an allowable bearing pressure of 110kN/m²
- Table of minimum foundation thickness based on widths:

Foundation width (mm)	Foundation thickness (mm)
450-600	225
750-900	300
1050	400
1200	450
1350	525
1500	600
1650	675
1800	750

- All foundation widths to be 450mm unless noted otherwise.
- All subwall block strength to be 7.3N/m²
- Refer to drawings as 134534-RSK-ZZ-00-FD-ST-ZZ-1015 to 1018 For Heave Extent

NOTE! CONTRACTOR TO CHECK HANDING AND SETTING OUT OF ALL PLOTS IS CHECKED AGAINST THE LATEST ARCHITECTS DRAWINGS BEFORE EXCAVATION AND POURING OF FOUNDATIONS.

NOTE! DYNAMIC PROBING FOR PHASE 2A AND PLOT 538-553 SHOULD BE CONDUCTED AT THE CORNERS. THIS SHOULD BE COMPLETED BEFORE FOUNDATION WORK BEGINS. PROBES SHOULD EXTEND TO AN APPROPRIATE DEPTH OF 5 METERS, CORRESPONDING TO THE ESTIMATED PRESSURE BULB BENEATH THE FOUNDATION

FOUNDATION EXCAVATION INSPECTIONS ARE REQUIRED, REFER TO GEOTECHNICAL ENGINEERS REQUIREMENTS TRENCH FILL FOUNDATION SOLUTION (MESH REINFORCED) IN AREAS OF HIGH RESISTIVELY CHALK IS TO BE APPROVED BY NHBC PRIOR TO CONSTRUCTION.

T2	13.10.25	Tender Issue		DP	TN	VV
T1	21.08.25	Tender Issue		SJW	TN	VV
Rev	Date	Amendment		Drawn	Chkd	Appd



an RSK company
 18 Frogmore Road Tel: +44 (0) 1442 437500
 Hemel Hempstead Fax: +44 (0) 1442 437550
 Hertfordshire Email: info@rsk.co.uk
 HP3 9RT Web: www.rsk.co.uk



Client
FORSTER PARK STEVENAGE PHASE 2B

Status
TENDER

Drawing Title
TRENCHFILL FOUNDATION GA FOR PLOTS 513-514, 535, 569-570, 583-584, 587 & 590

Drawn	Date	Checked	Date	Approved	Date
DP	13.10.25	TN	13.10.25	VV	13.10.25
Scale	Orig Size	Dimensions			
1 : 50	A1	mm			

RSK Project No. **134534** File Name 134534-RSK-ZZ-00-ZZ-ST-ZZ-

Drawing Reference		Rev.
134534	RSK	00
Project No.	Company	Block
Level	Type	Disc.
Series	Draw. No.	
	1130	T2

Legend:

- ▲ = Front of House/Garage
- HT = House Type
- TOC = Top of Concrete
- FFL = Finished Floor Level

CONTRACTOR TO CHECK THE HANDING OF ALL PLOTS AGAINST SITE LAYOUT ENSURING THE HANDINGS MATCH

Scale 0 1 2 3 4 5m