

Wall Legend - Block/Brick/Render(100mm Cavity)

	Standard External Insulated Cavity Wall - 0.24W/m²K 102.5mm facing brickwork 100mm cavity filled with blown mineral fibre insulation* 100mm aerated concrete block, K-value 0.11W/m²K, min strength 2.9N/mm² 12.5mm gypsum board on adhesive dabs
	Standard External Insulated Cavity Wall - Rendered - 0.24W/m²K 22mm monocoche through colour render to outer leaf. 100mm aerated concrete block, K-value 0.15W/m²K, min strength 3.6N/mm² 100mm cavity filled with blown mineral fibre insulation* 100mm aerated concrete block, K-value 0.11W/m²K, min strength 2.9N/mm² 12.5mm gypsum board on adhesive dabs
	Standard External Insulated Cavity Wall - Brick/Rendered - 0.24W/m²K 102.5mm facing brickwork 100mm cavity filled with blown mineral fibre insulation* 100mm aerated concrete block, K-value 0.11W/m²K, min strength 2.9N/mm² 12.5mm gypsum board on adhesive dabs
	Mid Strength External Insulated Cavity Wall - 0.25W/m²K 102.5mm facing brickwork 100mm cavity filled with blown mineral fibre insulation* 100mm aerated concrete block, K-value 0.15W/m²K, min strength 3.6N/mm² 12.5mm gypsum board on adhesive dabs
	High Strength External Insulated Cavity Wall - 0.26W/m²K 102.5mm facing brickwork 100mm cavity filled with blown mineral fibre insulation* 100mm aerated concrete block, K-value 0.19W/m²K, min strength 7.3N/mm² 12.5mm gypsum board on adhesive dabs
	Internal Blockwork Partition 12.5mm gypsum board on adhesive dabs 100mm aerated concrete block min strength 2.9N/mm² 12.5mm gypsum board on adhesive dabs
	Structural Stud Partition 12.5mm gypsum board 12.5mm OSB2 sheathing 63 x 38mm timber studs (studs and noggings rotated through 90°) 12.5mm gypsum board 12.5mm OSB2 sheathing
	Structural Stud Partition with Acoustic Insulation 12.5mm gypsum board 12.5mm sheathing to detail 63 x 38mm timber studs (studs and noggings rotated through 90°) with Isover APR 1200 acoustic 12.5mm gypsum board 12.5mm sheathing to detail
	Non-Load Bearing Stud Partition 12.5mm gypsum board 63 x 38mm timber studs 12.5mm gypsum board
	Stud Partition with Acoustic Insulation 12.5mm gypsum board 63 x 38mm timber studs, with 65mm thick Isover APR 1200 acoustic insulation packed between 12.5mm gypsum board
	Wind Post Ancon WP3 or similar within external wall cavity, designed for 7kN ULS load

Note:- all blockwork drawn blue to be 7.3N/mm² as per Structural Engineers comments.
Refer to relevant Construction Specification for either and 2021 Build regs for further details.
This drawing must be read in conjunction with 25 series drawings.
ALL MOVEMENT JOINTS TO BE CONFIRMED AS REQUIRED AND SUITABLE BY S.ENG

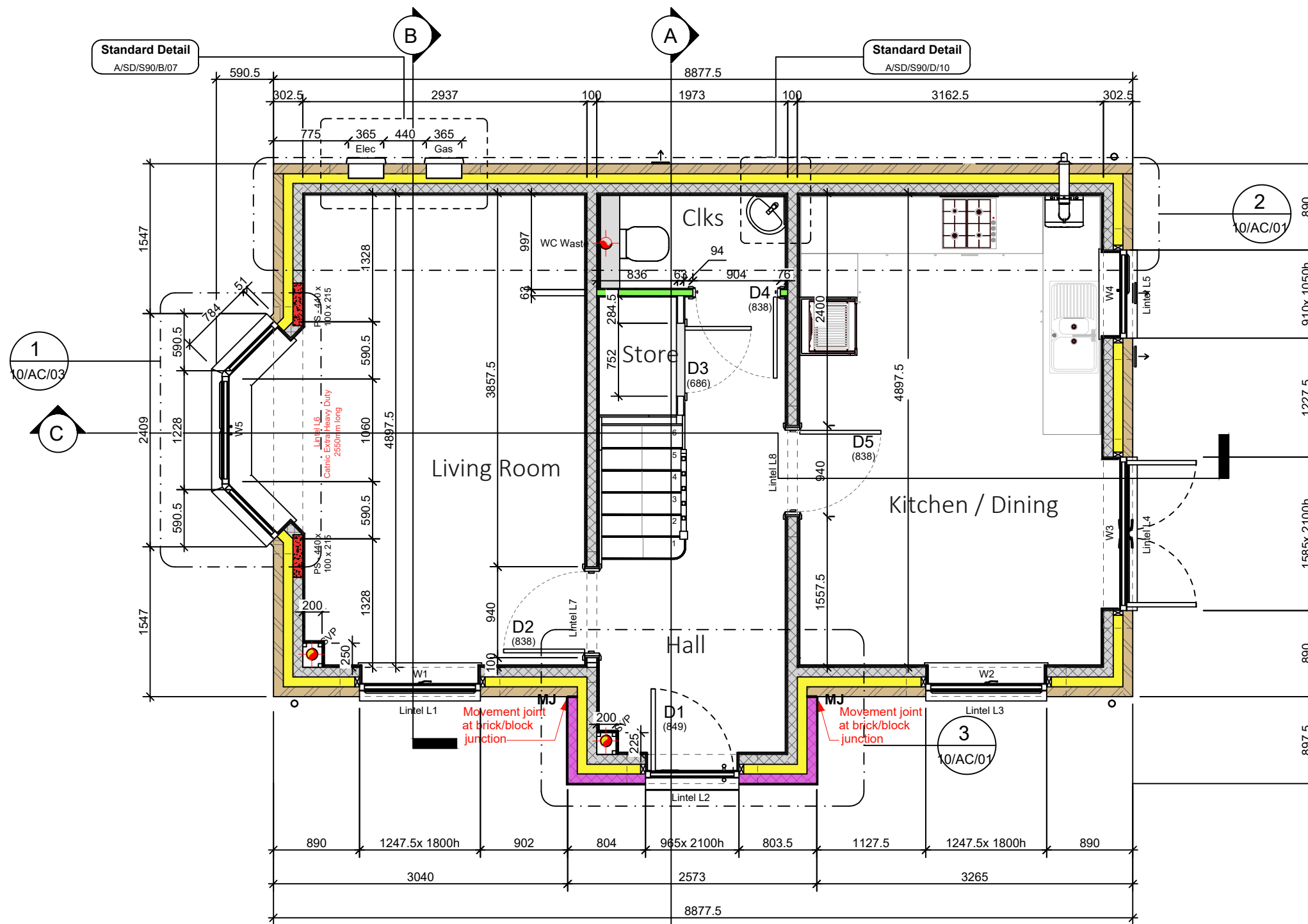

Rev: Date: By: Checked: Desc:

TENDER

Ashberry
Homes



Luminous House, 300
South Row, Milton
Keynes. MK9 2FR
T: 01438 359816

E:enquiries@arkonassociates.co.uk

www.arkonassociates.co.uk

CLIENT:
BELLWAY HOMES LTD. (NORTH LONDON)

PROJECT:
FORSTER PARK, STEVENAGE (PHASE 2)

WORKING DRAWINGS

TITLE:
The Wisteria

921 ft² | 3b Det | WI2

Ground Floor Setting Out Plan

SCALE:
1:50@A3

DATE:
Dec 25

DRAWN BY:
GM

CHECKED:
IJC

PROJ No:
5304

DWG No:
WI1001-WI2

REV:
-

1 Ground Floor

1:50

