

Notes

- This drawing is to be read in conjunction with all relevant drawing specifications and British Standards.
- For setting out of foundations refer to Architects drawings, do not scale. This drawing and associated .dwg files are not to be used for dimensional information. Refer to Architects drawings for dimensions or obtain on site as appropriate UNO.
- DPC/DPM to be in accordance with Architects details.
- For underbuild, DPC and tanking locations refer to Civil Engineering information.
- The ground worker shall at all times protect the formation from degradation.
- All variations are to be agreed with the Engineer prior to incorporation into the works.
- 48 hours notice is to be given to the Engineer for inspection of any works.
- SOIL CONDITIONS**
Refer to site investigations by: Geosphere Environmental
Ref: 5116.GI/GROUND/GF/SG/26-10-2020/V2
Dated: 26/10/2020
- External drawing information used & date
BHP received:
Site Investigation: 09/12/2020
Site Plan: 13/05/2025 - 8531-Site plan_Ver3.dwg
Topographical Survey: 04/11/2021
Private Levels: 16/06/2025 - 8531-FAH-ZZ-00-DR-C-0100-0102 PHASE 1 EXTERNAL LEVELS 2025-06-13
Private Drainage: TBC

Drawing Legend

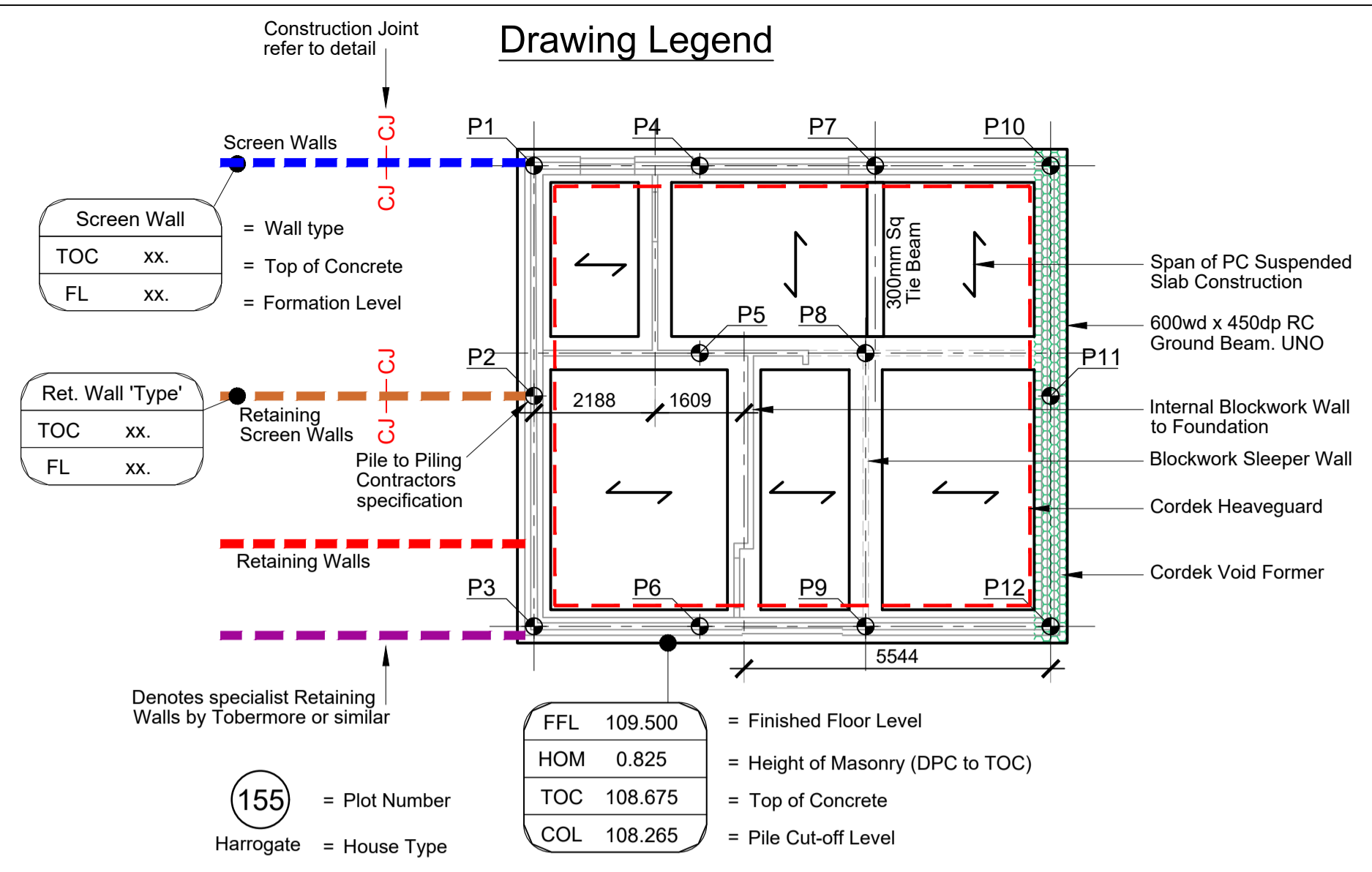

Drawing Sheet Location Plan

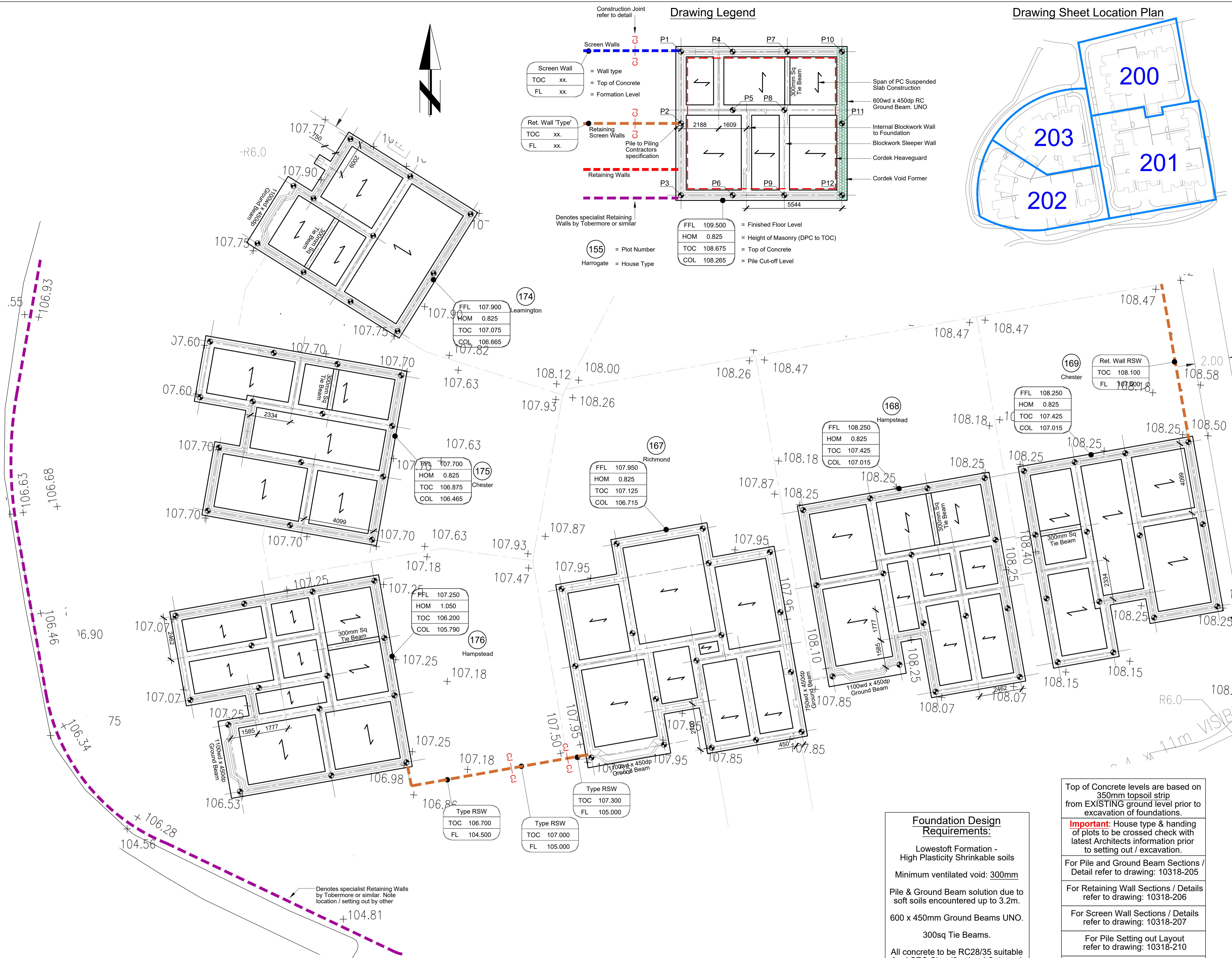

CDM SYMBOLS APPLY TO ALL PLOTS

STOP THINK!
Risk of collapse.
In relation to sides of excavations due to instability of soils / overhang from plant too close to excavation.

STOP THINK!
Risk of falling.
In relation to open trenches, any obstructions / debris on site, including stacked / stored materials or units. Ensure guarding of any certified excavation is carried out as appropriate. Similarly guarding required to wells or other below ground voids if encountered.

STOP THINK!
Heavy object.
Risk assessment for manual handling to be carried out based on the total weight of materials used and if necessary the use of mechanical means for movement - placing on site, where appropriate.

Rev.	Date	Comment	Chkd	By
C1	05.09.2025	Construction Issue	JGW	DJ
T2	27.06.2025	Minor updates as per revision clouds	JGW	WM
T1	24.06.2025	Tender issue	JGW	WM

A-Site Reference
8350-BHP-ZZ-FD-DR-S-09-202

Redrow Status
S3 - FOR COMMENT

Client
REDROW
A BETTER WAY TO LIVE

Barter Hill Partnership Limited
Office 40, The Stansted Centre,
Parsonage Road,
Takeley, Essex
CM22 6PU
t: 01279 430888
e: mail@barterhill.co.uk

15 Meridian Way
Meridian Business Park
Norwich NR7 0TA
t: 01603 300360
e: mail@barterhill.co.uk

Project
Hazel Park Phase 1, Stevenage

Drawing Title
**Foundation Proposals
Plots 167 - 169 & 174 - 176**

Designed by JGW	Drawn by WM	Checked by JGW
Scale @ A1 1:100	Date June 2025	
Drawing No. 10318 / 202	Revision C1	Job Ref 10318
Status CONSTRUCTION ISSUE		
Cad file P:\1\Structural\	Contact Office	

Foundation Design Requirements:

Lowestoft Formation - High Plasticity Shrinkable soils

Minimum ventilated void: 300mm

Pile & Ground Beam solution due to soft soils encountered up to 3.2m.

600 x 450mm Ground Beams UNO.

300sq Tie Beams.

All concrete to be RC28/35 suitable for ACEC Classification AC-1s and Design Sulphate Class DS-1

Top of Concrete levels are based on 350mm topsoil strip from EXISTING ground level prior to excavation of foundations.

Important: House type & handing of plots to be crossed check with latest Architects information prior to setting out / excavation.

For Pile and Ground Beam Sections / Detail refer to drawing: 10318-205

For Retaining Wall Sections / Details refer to drawing: 10318-206

For Screen Wall Sections / Details refer to drawing: 10318-207

For Pile Setting out Layout refer to drawing: 10318-210

For Pile Loadings and Setting out coordinates: 10318-211