

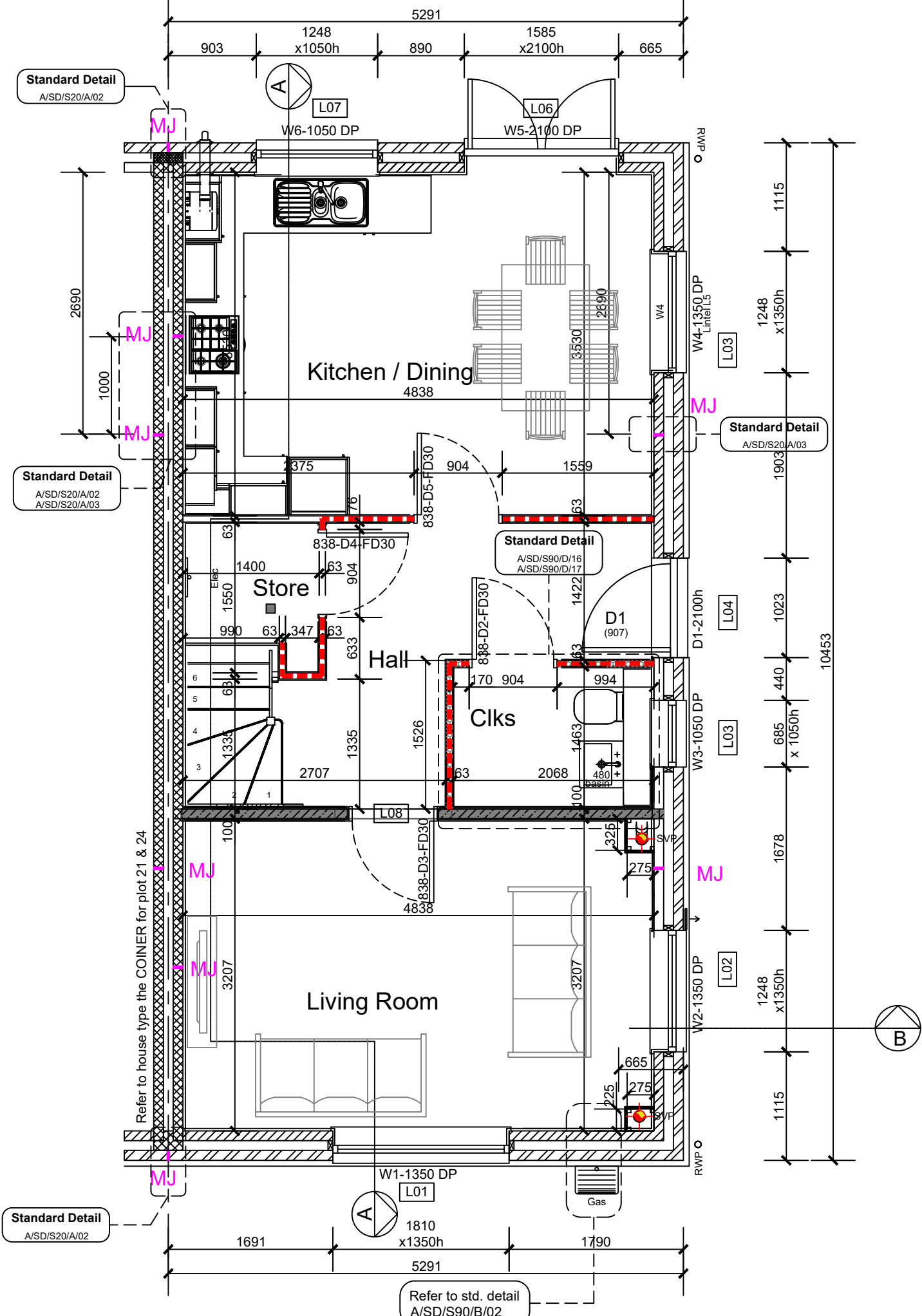

ND:	
ING WALLS	ITY TO STRUCTURAL ENG. SPEC.
FACE BRICKWORK.	
INDICATES 100mm BLOCKWORK WITH 3.6N/mm2 STRENGTH AND MAXIMUM 1600 KG/M3 DENSITY O.N.O.	
PARTY WALLS	
INDICATES 100mm AIRCRETE BLOCKWORK WITH 3.6N/mm2 STRENGTH AND 600-800 KG/M3 DENSITY O.N.O. & BED JOINT REINFORCEMENT FOR ROBUST STANDARD DETAIL : E-WM-30	
INTERNAL WALLS	
INDICATES 100mm BLOCKWORK WITH 3.6N/mm2 STRENGTH WITH 30x5mm GALVANISED MS STRAP 1200mm LONG FIXED ACROSS 3 JOISTS AT Max 2m C/C (Min 2 No.)	
INDICATES O/A 88mm STRUCTURAL TIMBER PARTITION COMPRISING 12.5mm PLASTERBOARD 11mm OSB2 SHEATHING ON BOTH SIDES OF 63X38 mm TIMBER STUD (STUDS AND NOGGINGS ROTATED THROUGH 90°). REFER TO A/AS/S50/B/01 TO 05	
INDICATES 88mm OVERALL THICKNESS COMPRISING 63X38mm TIMBER STUD WITH 12.5mm PLASTERBOARD EITHER SIDE.	
INDICATES O/A 88 mm TIMBER ACOUSTIC STUDWORK PARTITION 63 X 38mm TIMBER STUDS, WITH 65mm THICK ISOVER APR 1200 ACOUSTIC INSULATION PACKED BETWEEN	
INDICATES HALF HOUR FIRE RESISTANCE TO STUD PARTITION 88mm OVERALL THICKNESS COMPRISING 63X38 mm TIMBER STUD WITH 12.5mm WALLBOARD EITHER SIDE.	

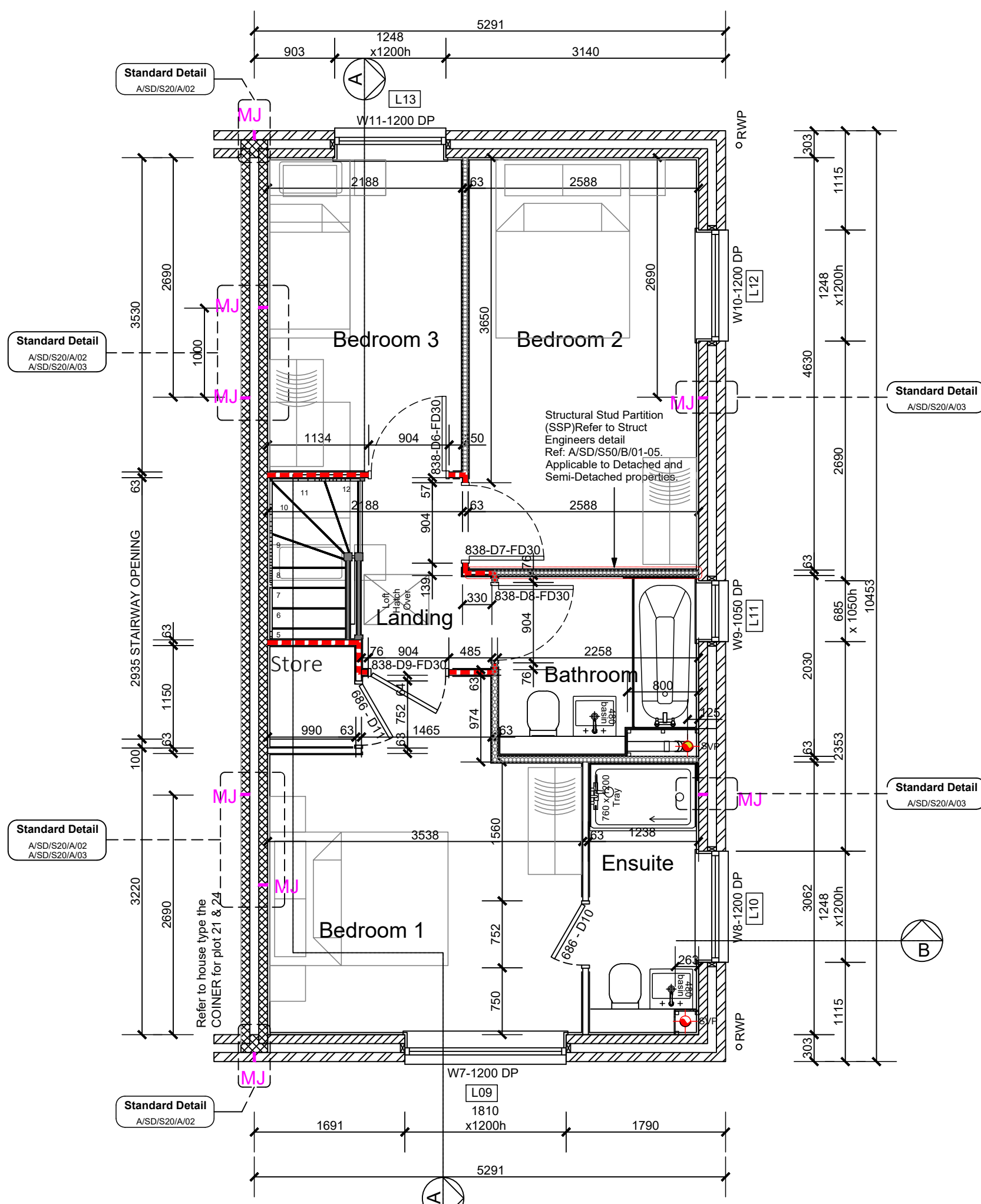

Ground Floor Plan  
Plot 20 As  
Plot 25 H



First Floor Plan  
Plot 20 As  
Plot 25 H

WADP Limited Registered in England No. 4564928  
Registered office: Station House, Cornaught Road, Brookwood,  
GU24 0ER

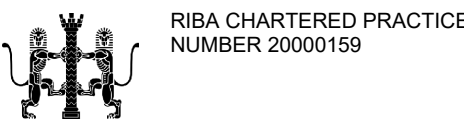

Drawings not to be scaled.  
Work to figured dimensions only.  
All dimensions to be checked on site, and any  
discrepancies reported to the Architect immediately

All drawings are to be read in conjunction the  
BELLWAY Company Specification and Project  
Specifications, Company Standard Details and with the  
current Building Regulations and Codes of Practice.

It is the Contractor's responsibility to ensure that all  
works are carried out in accordance with the same.

All concrete work to be carried out in accordance with  
BS EN 1992-1-1:2004.

All brickwork and blockwork to be carried out in  
accordance with BS EN 1996-1-2:2005.

All structural steelwork to be carried out in accordance  
with BS EN 1993-1-1:2005 Steelwork to be Grade  
S275.

All structural timber to be used in accordance with BS  
EN 1995-1-1:2004 and is to be preservative treated in  
accordance with BS4072.

All plumbing to be in accordance with BS6700, BS EN  
12056, BS6465:Part 1 and BS6367.

All glass falling within critical zones as defined by Part  
N of the Building Regulations is to be toughened or  
safety glass in accordance with BS EN 12600

All building works to be undertaken in accordance with  
Robust Enhanced Accredited Details.

# WADP

ARCHITECTS

62 Well Lane  
Horsell  
Woking  
Surrey  
GU21 4PS

Telephone: 01483 763028  
e-mail info@wadp.co.uk

## Bellway

www.bellway.co.uk

REGENT'S GATE  
VIRGINIA WATER SOUTH

THE BLEMMERE  
Floor Plans

1:50 @ A1 50mm @ A1

April 2024

CB

WADP-183\_THE BLEMMERE

C1