

<div>SUBSTRUCTURE MASONRY STRENGTH LEGEND</div> <div>All Substructure Blockwork to be 7.3N/mm2 Aircrete Blocks, JetFloor Infill blocks to be 3.5N/mm2</div> <div>Where infill blocks to beam and block floor are built into adjacent walls, the infill block is to be the same strength and density as the wall blockwork.</div>		<div>GENERAL ARRANGEMENT PLANS - WALL LEGEND</div> <div><div><div><div></div><div>Frost resistant quality facing brickwork 20N Brickwork</div></div><div><div><div></div><div>Perimeter Timber Studs</div></div><div><div>140x38mm Timber Studs Panels with140mm mineral wool insulation quilt between studs</div><div>1 or 2 layers of 9mm OSB-3 Sheathing to one side</div></div></div><div><div><div></div><div>Internal Loadbearing and Buttress Walls</div></div><div><div>89x38mm Timber Studs Panels with 50mm Acoustic insulation quilt between studs</div><div>1 or 2 layers of 9mm OSB-3 Sheathing to one side</div></div></div><div><div><div></div><div>Internal Non-Loadbearing Walls</div></div><div><div>63x38mm Timber Studs Panels with 50mm Acoustic insulation quilt between studs</div></div></div><div><div><div></div><div>Movement Joint</div></div><div><div><div></div><div>Cavity Closer</div></div></div></div></div></div>		<div>FIRE DOOR LEGEND</div> <div><div><div></div><div>FD30</div><div>Half hour fire door with intumescent strip.</div></div></div>		<div>ELECTRICAL KEY</div> <div><div><div><div>This electrical legend is to be read in conjunction with the internal specification and M&amp;E consultants details if applicable with any discrepancies being reported to the site manager. Doorbells, light switches, entryphones, etc. should be fixed no higher than 1200mm above FFL. TV, OR &amp; power sockets should be fixed no lower than 450mm above FFL. All wall lights to be fitted at 2100mm above FFL.</div><div><table><tr><th>Symbol</th><th>Description</th></tr><tr><td></td><td>Flush double switch socket.</td></tr><tr><td></td><td>Flush double switch socket with 2 USB ports.</td></tr><tr><td></td><td>External socket.</td></tr><tr><td></td><td>13A flush unswitched spur.</td></tr><tr><td></td><td>Flush double switched socket 200mm above kitchen work top with 2 USB ports</td></tr><tr><td></td><td>Flush double switched socket 200mm above kitchen work top.</td></tr></table></div><div><table><tr><td></td><td>13A Flush unswitched outlet 300mm below kitchen work top.</td></tr><tr><td></td><td>Flush 30A cooker switch 200mm above kitchen work top.</td></tr><tr><td></td><td>Shower head &amp; control position.</td></tr><tr><td></td><td>Ceiling mounted extract fan.</td></tr><tr><td></td><td>Isolator switch.</td></tr><tr><td></td><td>Shaver Socket.</td></tr><tr><td></td><td>Heat Detector.</td></tr><tr><td></td><td>For full lounge plate specification refer to CALA Group Internal Specification.</td></tr><tr><td></td><td>For sites with FTTP refer to SD/1002.</td></tr></table></div><div><table><tr><td></td><td>Flush rocker light switch. Where switches are located in same wall, use 2/3/4 gang switches</td></tr><tr><td></td><td>Ceiling rose light point.</td></tr><tr><td></td><td>LED light fitting.</td></tr><tr><td></td><td>Under-stair oval bulkhead wall mounted light.</td></tr><tr><td></td><td>External Wall light.</td></tr><tr><td></td><td>Batten holder light fitting.</td></tr><tr><td></td><td>Door bell push.</td></tr><tr><td></td><td>Door bell sounder.</td></tr><tr><td></td><td>Dual TV/ FM point 1xCT100 cabling (diplexer).</td></tr><tr><td></td><td>Single slave phone socket 1xCAT 6 cabling.</td></tr></table></div><div><table><tr><td></td><td>RJ45 data point</td></tr><tr><td></td><td>HDMI port (4 &amp; 5 beds only)</td></tr><tr><td></td><td>Immersion heater switch (located in AC).</td></tr><tr><td></td><td>Rad/Rail.</td></tr><tr><td></td><td>Heating control programming switch.</td></tr><tr><td></td><td>Grid switch.</td></tr><tr><td></td><td>Thermostat.</td></tr><tr><td></td><td>Electrical Vehicle charging Point.</td></tr></table></div></div></div></div>				Symbol	Description		Flush double switch socket.		Flush double switch socket with 2 USB ports.		External socket.		13A flush unswitched spur.		Flush double switched socket 200mm above kitchen work top with 2 USB ports		Flush double switched socket 200mm above kitchen work top.		13A Flush unswitched outlet 300mm below kitchen work top.		Flush 30A cooker switch 200mm above kitchen work top.		Shower head & control position.		Ceiling mounted extract fan.		Isolator switch.		Shaver Socket.		Heat Detector.		For full lounge plate specification refer to CALA Group Internal Specification.		For sites with FTTP refer to SD/1002.		Flush rocker light switch. Where switches are located in same wall, use 2/3/4 gang switches		Ceiling rose light point.		LED light fitting.		Under-stair oval bulkhead wall mounted light.		External Wall light.		Batten holder light fitting.		Door bell push.		Door bell sounder.		Dual TV/ FM point 1xCT100 cabling (diplexer).		Single slave phone socket 1xCAT 6 cabling.		RJ45 data point		HDMI port (4 & 5 beds only)		Immersion heater switch (located in AC).		Rad/Rail.		Heating control programming switch.		Grid switch.		Thermostat.		Electrical Vehicle charging Point.	<div>NOTES:</div> <div>All dimensions to be checked on site prior to the commencement of construction and any discrepancy should be reported to the Site Manager.</div> <div>This drawing may not be reproduced in any part or form without written consent.</div> <div>All copyrights reserved.</div> <div>Sub-Contractors MUST ensure that they have the latest issue drawing before they commence work on site.</div> <div>This drawing is to be read in conjunction with all relevant Specifications, schedules and Engineers details.</div>	
Symbol	Description																																																																														
	Flush double switch socket.																																																																														
	Flush double switch socket with 2 USB ports.																																																																														
	External socket.																																																																														
	13A flush unswitched spur.																																																																														
	Flush double switched socket 200mm above kitchen work top with 2 USB ports																																																																														
	Flush double switched socket 200mm above kitchen work top.																																																																														
	13A Flush unswitched outlet 300mm below kitchen work top.																																																																														
	Flush 30A cooker switch 200mm above kitchen work top.																																																																														
	Shower head & control position.																																																																														
	Ceiling mounted extract fan.																																																																														
	Isolator switch.																																																																														
	Shaver Socket.																																																																														
	Heat Detector.																																																																														
	For full lounge plate specification refer to CALA Group Internal Specification.																																																																														
	For sites with FTTP refer to SD/1002.																																																																														
	Flush rocker light switch. Where switches are located in same wall, use 2/3/4 gang switches																																																																														
	Ceiling rose light point.																																																																														
	LED light fitting.																																																																														
	Under-stair oval bulkhead wall mounted light.																																																																														
	External Wall light.																																																																														
	Batten holder light fitting.																																																																														
	Door bell push.																																																																														
	Door bell sounder.																																																																														
	Dual TV/ FM point 1xCT100 cabling (diplexer).																																																																														
	Single slave phone socket 1xCAT 6 cabling.																																																																														
	RJ45 data point																																																																														
	HDMI port (4 & 5 beds only)																																																																														
	Immersion heater switch (located in AC).																																																																														
	Rad/Rail.																																																																														
	Heating control programming switch.																																																																														
	Grid switch.																																																																														
	Thermostat.																																																																														
	Electrical Vehicle charging Point.																																																																														
<div>SUBSTRUCTURE LEGEND</div> <div><div><div><div>DD1</div><div>Direct Drain Connection (No.1).</div></div><div><div>SVP1</div><div>Soil Vent Pipe (No.1).</div></div></div><div>Centre line of drainage outlets to be positioned 75mm from structural Wall</div></div>																																																																															
<div>DOOR THRESHOLD</div> <div><div><div></div><div>Thick dashed line denotes ACO 'HEX Drain Brickslot' hidden drainage channel across width of door opening Refer to Engineers and Architects details.</div></div><div><div></div><div>Thin dashed line indicates extent of secondary DPC stepped up to accommodate level threshold where required.</div></div></div>		<div>STAIRCASE INFORMATION</div>																																																																													

SPECIFICATION C

PRIVATE

r to achieve minimum width of 850mm.

eight must be max of FFL

g area: Window Handle min 450mm to max of FFL

ows: Handle height must be max of 1400mm from FFL

vitches/ stopcocks/ controls entre line between above floor level and a nm (horizontally) to an

ts are mounted so that tw 1350-1450mm above FFL  
re mounted btw above FFL

bathroom capable of firm ort for adaptations such as m WBP Plywood to be applied ide of the WC partitions as s to withstand loads of sure door linings are dth to accommodate. Refer to

s are to be specified mily Bathroom in order M4(2)

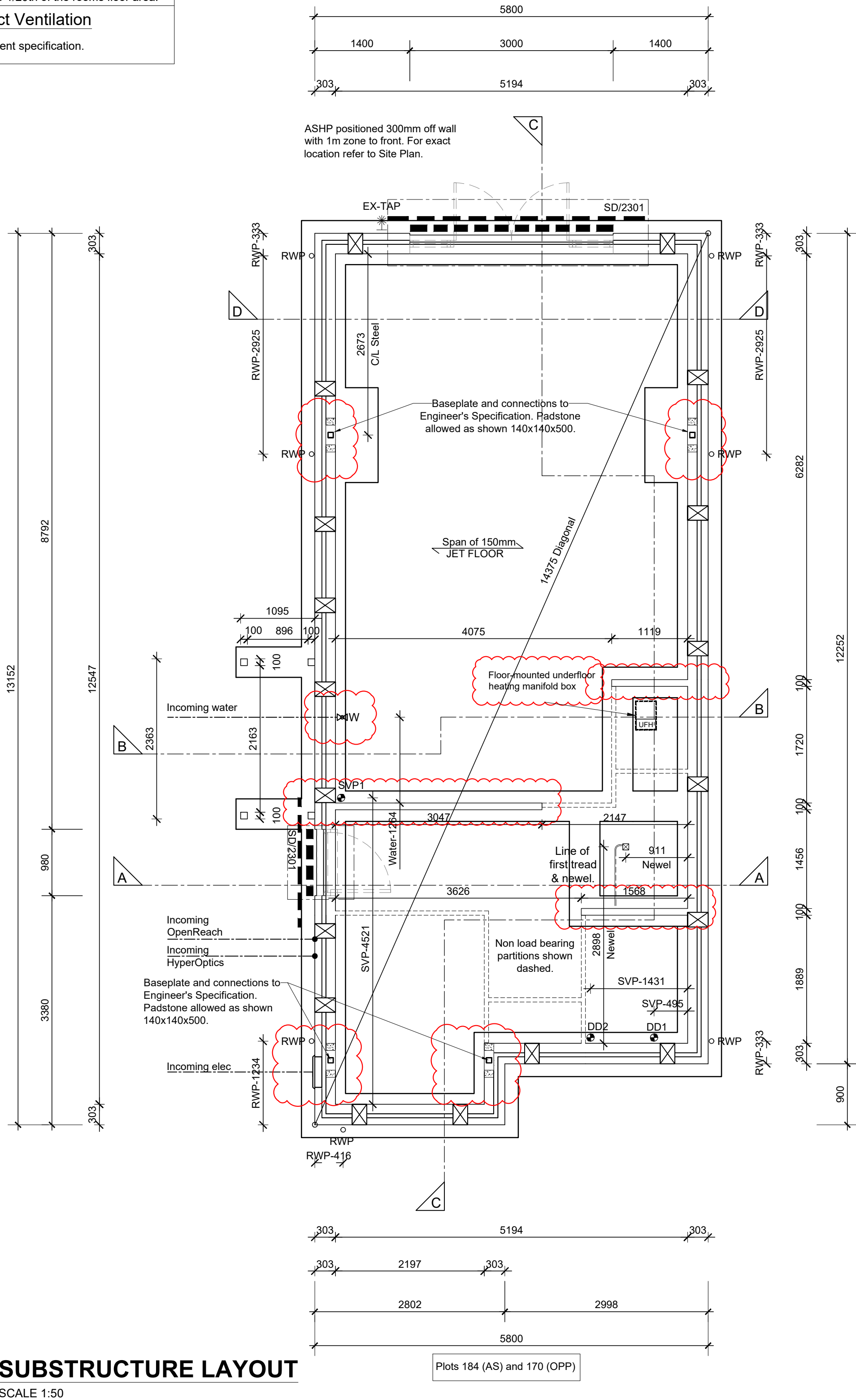

SUBSTRUCTURE LAYOUT

SCALE 1:50

Access zones Part M4 Cat 2:  
- Dotted line denotes clear access routes for M4(2) compliance.  
- Dotted hatched squared denotes 300mm nib to leading edge of entrance storey doors  
- Dotted line denotes clear access routes to be minimum 750mm wide from doorway to window and around bed in principal bedroom for M4(2) compliance

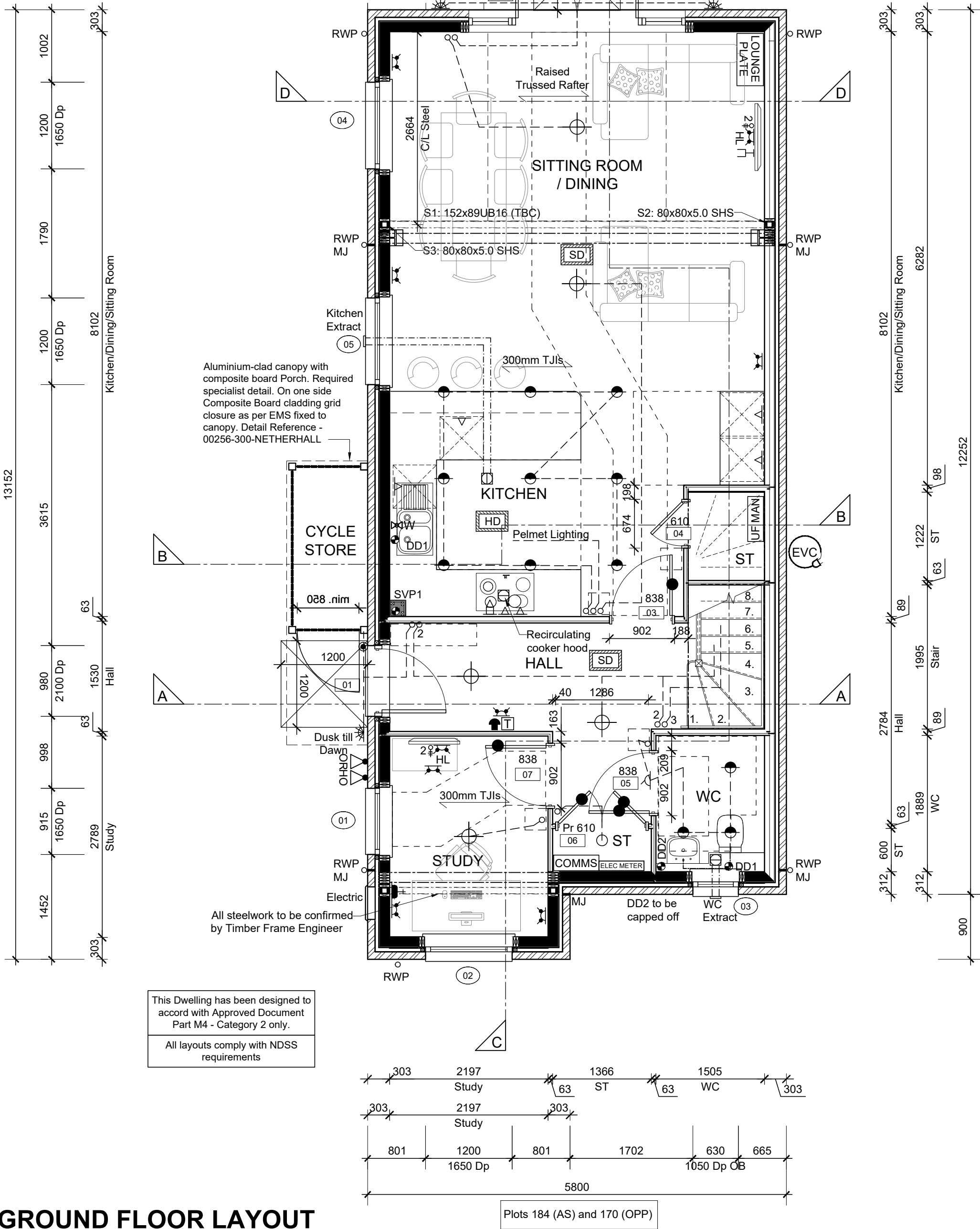

GROUND FLOOR LAYOUT

SCALE 1:50

A	10.02.25	Foundation walls updated to GDC plans, timber frame structural steel added. Under floor heating manifold added and sink waste removed	DW
Rev	Date	Description	Init.



Netherhall Gardens

DRAWING TITLE  
HT 4.1c  
Substructure & Ground Floor Layout

Timber Frame Construction

SCALE	DATE	DRAWN
1:50 @ A1	Jan 2024	KB
DWG NO.	REV.	
00256-125-NETHERHALL	A	