

Pre-Inspection Checklist Sub Structure Block Work to FFL	
Project: Brooklands college	Date: 19 November 2024
Area: Phase 1b	Am / Pm: AM
Locaton: Plot 161	Drawing Number: SA00394-0590-A-HT8-SUB
Weather Condition: Dry	Sheet Number: I

Table of Contents

- Setting Out Line & Level to Current Drawings
- Product Material Compliant With Engineers/Architect Specification
- Specified Bedding Depth, Colour & Mlxing Ratio to Specification
- Specified DPC Installed & at Correct Level
- Specified Wall Ties & Air Vents Installed at Correct Location & Height
- DPC / Membrane Installed as Per Specification
- Brick Type
- Lintel Bearing

Completed By: James Brydon

Date Completed: 19 November 2024

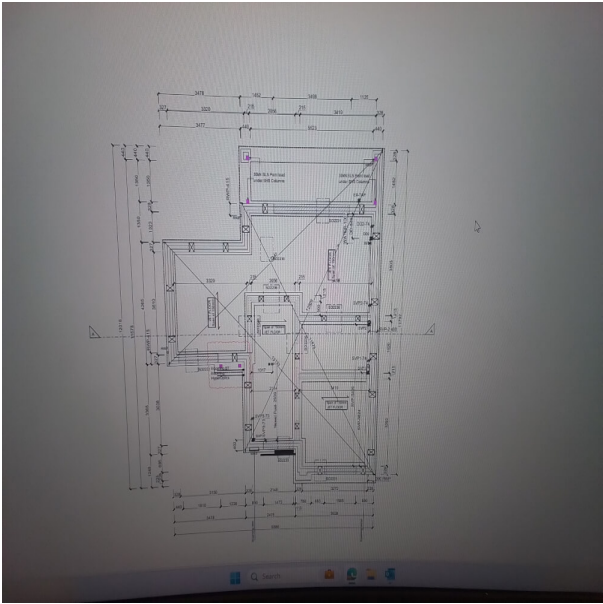

Completed By: James Brydon

Date Completed: 19 November 2024



Completed By: James Brydon

Date Completed: 19 November 2024



Specified DPC Installed & at Correct Level

Completed By: James Brydon

Date Completed: 19 November 2024

Completed By: James Brydon

Date Completed: 19 November 2024



Completed By: James Brydon
Date Completed: 19 November 2024

Completed By: James Brydon

Date Completed: 19 November 2024

Item	Unit	Quantity	Unit Price	Total Price	Material Code	Material Description	Unit Price	Total Price	Material Code	Material Description	Unit Price	Total Price
Brickwork	m ²	100	15.00	1500.00	100	Brickwork	15.00	1500.00	100	Brickwork	15.00	1500.00
Blockwork	m ²	100	12.00	1200.00	100	Blockwork	12.00	1200.00	100	Blockwork	12.00	1200.00
Concrete	m ³	100	18.00	1800.00	100	Concrete	18.00	1800.00	100	Concrete	18.00	1800.00
Foundation	m ²	100	20.00	2000.00	100	Foundation	20.00	2000.00	100	Foundation	20.00	2000.00
Roofing	m ²	100	10.00	1000.00	100	Roofing	10.00	1000.00	100	Roofing	10.00	1000.00
Flooring	m ²	100	8.00	800.00	100	Flooring	8.00	800.00	100	Flooring	8.00	800.00
Wallpaper	m ²	100	5.00	500.00	100	Wallpaper	5.00	500.00	100	Wallpaper	5.00	500.00
Painting	m ²	100	3.00	300.00	100	Painting	3.00	300.00	100	Painting	3.00	300.00
Plumbing	m ²	100	4.00	400.00	100	Plumbing	4.00	400.00	100	Plumbing	4.00	400.00
Electrical	m ²	100	6.00	600.00	100	Electrical	6.00	600.00	100	Electrical	6.00	600.00
HVAC	m ²	100	7.00	700.00	100	HVAC	7.00	700.00	100	HVAC	7.00	700.00
Landscaping	m ²	100	9.00	900.00	100	Landscaping	9.00	900.00	100	Landscaping	9.00	900.00
Fencing	m ²	100	11.00	1100.00	100	Fencing	11.00	1100.00	100	Fencing	11.00	1100.00
Gardens	m ²	100	13.00	1300.00	100	Gardens	13.00	1300.00	100	Gardens	13.00	1300.00
Pools	m ²	100	16.00	1600.00	100	Pools	16.00	1600.00	100	Pools	16.00	1600.00
Driveways	m ²	100	14.00	1400.00	100	Driveways	14.00	1400.00	100	Driveways	14.00	1400.00
Garages	m ²	100	17.00	1700.00	100	Garages	17.00	1700.00	100	Garages	17.00	1700.00
Sheds	m ²	100	19.00	1900.00	100	Sheds	19.00	1900.00	100	Sheds	19.00	1900.00
Houses	m ²	100	21.00	2100.00	100	Houses	21.00	2100.00	100	Houses	21.00	2100.00
Apartments	m ²	100	23.00	2300.00	100	Apartments	23.00	2300.00	100	Apartments	23.00	2300.00
Commercial	m ²	100	25.00	2500.00	100	Commercial	25.00	2500.00	100	Commercial	25.00	2500.00
Industrial	m ²	100	27.00	2700.00	100	Industrial	27.00	2700.00	100	Industrial	27.00	2700.00
Agricultural	m ²	100	29.00	2900.00	100	Agricultural	29.00	2900.00	100	Agricultural	29.00	2900.00
Marine	m ²	100	31.00	3100.00	100	Marine	31.00	3100.00	100	Marine	31.00	3100.00
Aircraft	m ²	100	33.00	3300.00	100	Aircraft	33.00	3300.00	100	Aircraft	33.00	3300.00
Space	m ²	100	35.00	3500.00	100	Space	35.00	3500.00	100	Space	35.00	3500.00
Offshore	m ²	100	37.00	3700.00	100	Offshore	37.00	3700.00	100	Offshore	37.00	3700.00
Specialist	m ²	100	39.00	3900.00	100	Specialist	39.00	3900.00	100	Specialist	39.00	3900.00
Other	m ²	100	41.00	4100.00	100	Other	41.00	4100.00	100	Other	41.00	4100.00

Completed By: James Brydon

Date Completed: 19 November 2024



Proceed/not proceed

Reason for Rejection/Comments: Proceed. FYI Darren Smoker. 2 additional trench block laid to achieve TOC level

Signed for HOULIHAN: James Brydon

Date: 2024-11-19

Signed for client by:

Date:

The above inspections have been carried out and are acceptable/unacceptable

Non Conformities/Comments

Reason for non Conformities/Comments: Rear elevation still needs to built as waiting for steels

Signed for HOULIHAN: James Brydon

Date: 2024-11-19

Signed for client by:

Date: