

STAIRCASE - GRD-1st			
13 equal risers of 209.38mm; Going = 234mm; Pitch 41.82°; Width over strings - 860mm			

ROOF VENTILATION (TYPE 1)			
An impermeable roofing underlay (Type 1F / HR) is to be draped over all roof pitches, with Rytons OFV1000 (or similar approved) over fascia ventilator providing ventilation equivalent to a continuous 10mm opening at eaves level, and Glidevale Fulmetal Rediroll ventilated dry ridge system (or similar approved) providing ventilation equivalent to a continuous 5mm opening at ridge level.			

PADSTONE SCHEDULE			
REF	LENGTH	DEPTH	WIDTH
P1	215	215	100
P2	440	215	100
	600	215	100

Padstones and steel beam sizes as per SE Drawings

Refer to specialist for joist sizes

Refer to M&E Drawings for Underfloor heating details

GENERAL ARRANGEMENT PLANS - WALL LEGEND

	Frost resistant quality facing brickwork 20N Brickwork laid in minimum class iii (M4) mortar.
	Celcon Standard blockwork to inner leaf only. Medium dense blockwork to outer leaf to be laid in minimum class iii (M4) mortar. 70mm British Gypsum Gyprock 70S50 °C stud system, with studs at 600mm centres. 12.5mm Gyproc Soundbloc plasterboard each side with tapered edges, finished as per internal spec. Moisture-resistant plasterboard to bathroom with studs at 400mm centres. Note: All external wall cavities to be 125mm unless otherwise specified. 70mm Butressing Wall with 12mm Ply Sheathing as per SD/3022. 12.5mm Gyproc Soundbloc plasterboard each side with tapered edges, finished as per internal spec. Moisture-resistant plasterboard to bathroom with studs at 400mm centres. 63x38mm timber studs @ max 600mm centres. 50mm Isover acoustic partition roll (APR 1200) to be installed between studwork for the entire wall panel.
	MJ Movement Joints
	Denotes the position of the external cavity fire Soc.

**IMPORTANT NOTE:**  
ALL EXTERNAL WALLS TO INCORPORATE BRICKFORCE SBF30W60 BED-JOINT REINFORCEMENT TO INNER LEAF OF BLOCKWORK 2x COURSES ABOVE & BELOW ALL OPENINGS & TO PROJECT A MIN. 600mm BEYOND OPENING.

ELECTRICAL KEY

Symbol	Description
	Flush double switched socket 200mm above kitchen work top with 2 USB points
	Flush rocker light switch, 1,2 or 3 way switched.
	Ceiling rose light point.
	LED downlighter light fitting.
	Under-stair oval bulkhead wall mounted light.
	External Wall light.
	Batten holder light fitting.
	Door bell push.
	Door bell sounder.
	13A flush unswitched spur.

Where switches are located all in the same wall, use 2/3/4 gang switches.

Symbol	Description
	Flush double switched socket 200mm above kitchen work top.
	13A Flush unswitched outlet 300mm below kitchen work top.
	Flush 30A cooker switch 200mm above kitchen work top.
	Gas point.
	Shower head & control position.
	Ceiling mounted extract fan.
	Isolator switch.
	Shaver socket.

Symbol	Description
	Dual TV/ FM point 1xCT100 cabling (diplexer).
	Single slave phone socket 1xCAT 6 cabling.
	RJ45 data point
	HDMI port (4 & 5 beds only)
	Immersion heater switch, located in AC.
	Rad/Rail.
	Heating control programming switch.
	Grid switch.
	Thermostat.

Symbol	Description
	Carbon Monoxide Detector.
	Smoke Detector.
	Heat Detector.
	For sites with FTTP refer to SD/1002. For sites with FTTC refer to SD/1003.
	For full lounge plate specification refer to CALA Group Internal Specification.
	Intruder Alarm unit to Nacoss Standard
	Alarm Panel
	For sites where virgin is to be provided, Virgin Media blanking plates are to be provided adjacent to the low level Lounge Plate in the lounge, and next to the TV/FM socket within the Family Room and Master Bedroom.
	External wall mounted Electric Meter
	British Telecom Point
	Hyper Optic Point
	Underfloor Heating Manifold

LOFT SPACE ELEC KEY

Symbol	Description
	Batten holder light fitting.
	Flush double switch socket.
	Smoke Detector within loft space.
	Switch with Neon indicator

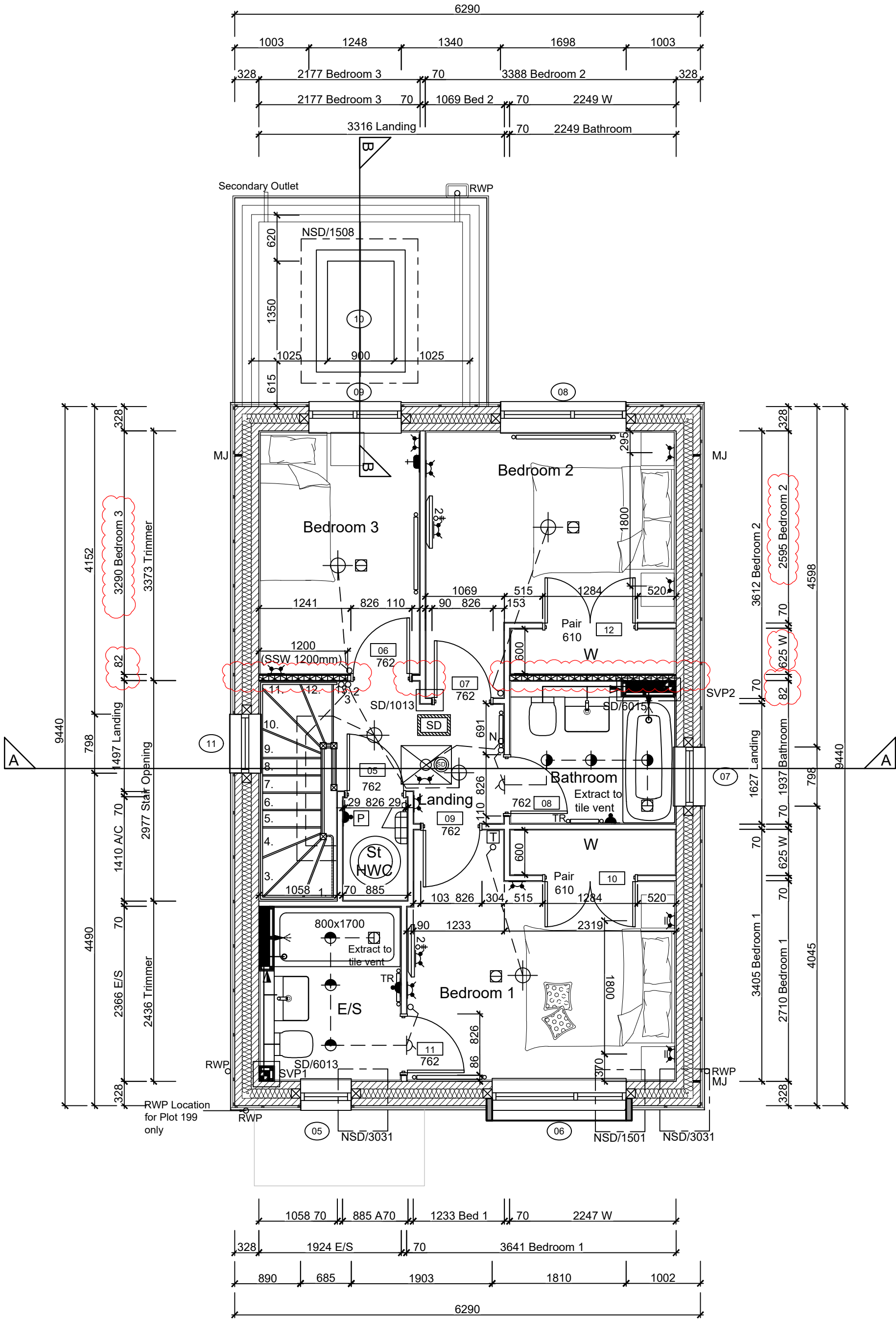

FIRST FLOOR LAYOUT  
SCALE 1:50

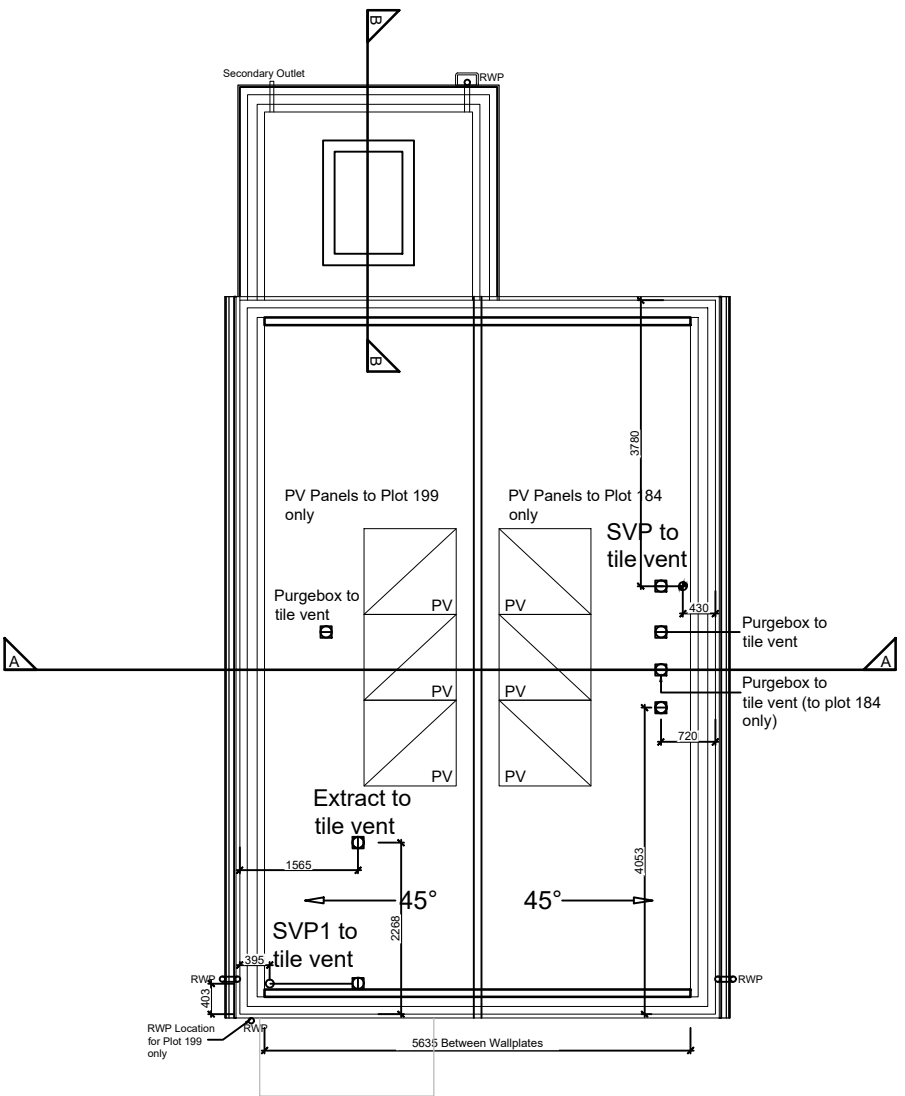

ROOF LAYOUT  
SCALE 1:100

Notes  
All dimensions to be checked on site prior to the commencement of construction and any discrepancy should be reported to the Site Manager.

This drawing may not be reproduced in any part or form without written consent.

All copyrights reserved.

Sub-Contractors MUST ensure that they have the latest issue drawing before they commence work on site.

This drawing is to be read in conjunction with all relevant Specifications, schedules and Engineers details.

P	01.10.25	Braced partition dim amended. Bed 2 & 3 dims amended. Legend amended.	SK
O	08.08.25	Nibs updated to site, Loft hatch coordinated with truss.	ZJ
N	12.06.25	Adjusted Bed 2 & 3 stud wall dims, additional dims. Rad & TV point relocated.	ZJ
M	09.05.25	Basin updated as per spec. Sanitary ware in en-suite updated as per spec. Thermostat relocated.	SK
L	25.04.25	Purge Box vents co-ordinated on the roof plan	SK
K	15.01.25	M&E coordinated. Sockets coordinated, ensuite size HT1 amended. PV's added. SD added to Loft hatch. Nib added to the wardrobe in Bed 02.	DF
		Loft hatch legend added.	
J	15.10.24	Detail Ref tags co-ordinated.	SK
I	23.09.24	Wall key amended	ZJ
H	22.07.24	RWP location amended. Secondary outlet added	SK
G	01.07.24	SE notes added.	
		RWP location amended as per Clients Comments dated 22.05.24. M&E note added.	SK
Rev	Date	Description	Init.



Job title  
**Brooklands College  
Weybridge**

Drawing title  
**House Type 1 (Fir)  
Plots: 184 & 199  
First Floor  
& Roof Plan**

Scale	1:50/1:100 @ A1	Date	May 2023
Rev.	P	Drawn	RR

Dwg No.  
SA00394-0003-A-HT1-GA