

STAIRCASE - GRD-1st			
13 equal risers of 209.38mm; Going = 234mm; Pitch 41.82°; Width over strings - 860mm			

ROOF VENTILATION (TYPE 1)			
An impermeable roofing underlay (Type 1F / HR) is to be draped over all roof pitches, with Rytons OFV1000 (or similar approved) over fascia ventilator providing ventilation equivalent to a continuous 10mm opening at eaves level, and Glidevale Fulmetal Redroll ventilated dry ridge system (or similar approved) providing ventilation equivalent to a continuous 5mm opening at ridge level.			

PADSTONE SCHEDULE			
REF	LENGTH	DEPTH	WIDTH
P1	440	215	100
P2 (L Shaped)	300X440	215	100

Padstones and steel beam sizes as per SE Drawings

Refer to specialist for joist sizes

GENERAL ARRANGEMENT PLANS - WALL LEGEND	
	Frost resistant quality facing brickwork 20N Brickwork laid in minimum class iii (M4) mortar.
	Celcon Standard blockwork to inner leaf only. Medium dense blockwork to outer leaf to be laid in minimum class iii (M4) mortar. Compressive strength 7.3N/mm² to the Ground Floor, minimum class iii (M6) mortar (unless otherwise noted) & 3.5N/mm² minimum class iii (M4) mortar (unless noted otherwise noted) to first/second floor/ roof level.
	Note: All external wall cavities to be 125mm unless otherwise specified. 70mm British Gypsum Gyframe 70S50 °C stud system, with studs at 600mm centres. 12.5mm Gyproc Soundbloc plasterboard each side with tapered edges, finished as per internal spec. Moisture-resistant plasterboard to bathroom with studs at 400mm centres.
	70mm Butressing Wall with 12mm Ply Sheathing as per SD/3022. 12.5mm Gyproc Soundbloc plasterboard each side with tapered edges, finished as per internal spec. Moisture-resistant plasterboard to bathroom with studs at 400mm centres. 63x38mm timber studs @ max 600mm centres. 50mm Isover acoustic partition roll (APR 1200) to be installed between studwork for the entire wall panel
	Movement Joints
	Denotes the position of the external cavity fire Soc.
IMPORTANT NOTE: ALL EXTERNAL WALLS TO INCORPORATE BRICKFORCE SBF30W60 BED-JOINT REINFORCEMENT TO INNER LEAF OF BLOCKWORK 2x COURSES ABOVE & BELOW ALL OPENINGS & TO PROJECT A MIN. 600mm BEYOND OPENING.	

ELECTRICAL KEY	
This electrical legend is to be read in conjunction with the internal specification & M&E consultants details if applicable with any discrepancies being reported to the site manager. Doorbells, light switches, entraphones, etc. should be fixed no higher than 1200mm above FFL. TV, BT & power sockets should be fixed no lower than 450mm above FFL. All wall lights to be fitted at 2100mm above FFL.	
Symbol	Description
	Flush double switch socket.
	Flush double switch socket with 2 USB points.
	External socket.
	13A flush unswitched spur.
Where switches are located all in the same wall, use 2/3/4 gang switches.	

Symbol	Description
	Flush double switched socket 200mm above kitchen work top.
	13A Flush unswitched outlet 300mm below kitchen work top.
	Flush 30A cooker switch 200mm above kitchen work top.
	Gas point.
	Shower head & control position.
	Ceiling mounted extract fan.
	Isolator switch.
	Shaver socket.

Symbol	Description
	Carbon Monoxide Detector.
	Smoke Detector.
	Heat Detector.
	For sites with FTTP refer to SD/1002. For sites with FTTC refer to SD/1003.
	For full lounge plate specification refer to CALA Group Internal Specification.
	Intruder Alarm unit to Nacoss Standard
	Alarm Panel
For sites where virgin is to be provided, Virgin Media blanking plates are to be provided adjacent to the low level Lounge Plate in the lounge, and next to the TV/FM socket within the Family Room and Master Bedroom.	
	External wall mounted Electric Meter
	British Telecom Point
	Hyper Optic Point
	Underfloor Heating Manifold

Notes
All dimensions to be checked on site prior to the commencement of construction and any discrepancy should be reported to the Site Manager.
This drawing may not be reproduced in any part or form without written consent.
All copyrights reserved.
Sub-Contractors MUST ensure that they have the latest issue drawing before they commence work on site.
This drawing is to be read in conjunction with all relevant Specifications, schedules and Engineers details.
<input type="checkbox"/> EVC: Indicative postion of EVCP- If remote, see External works drawing for position

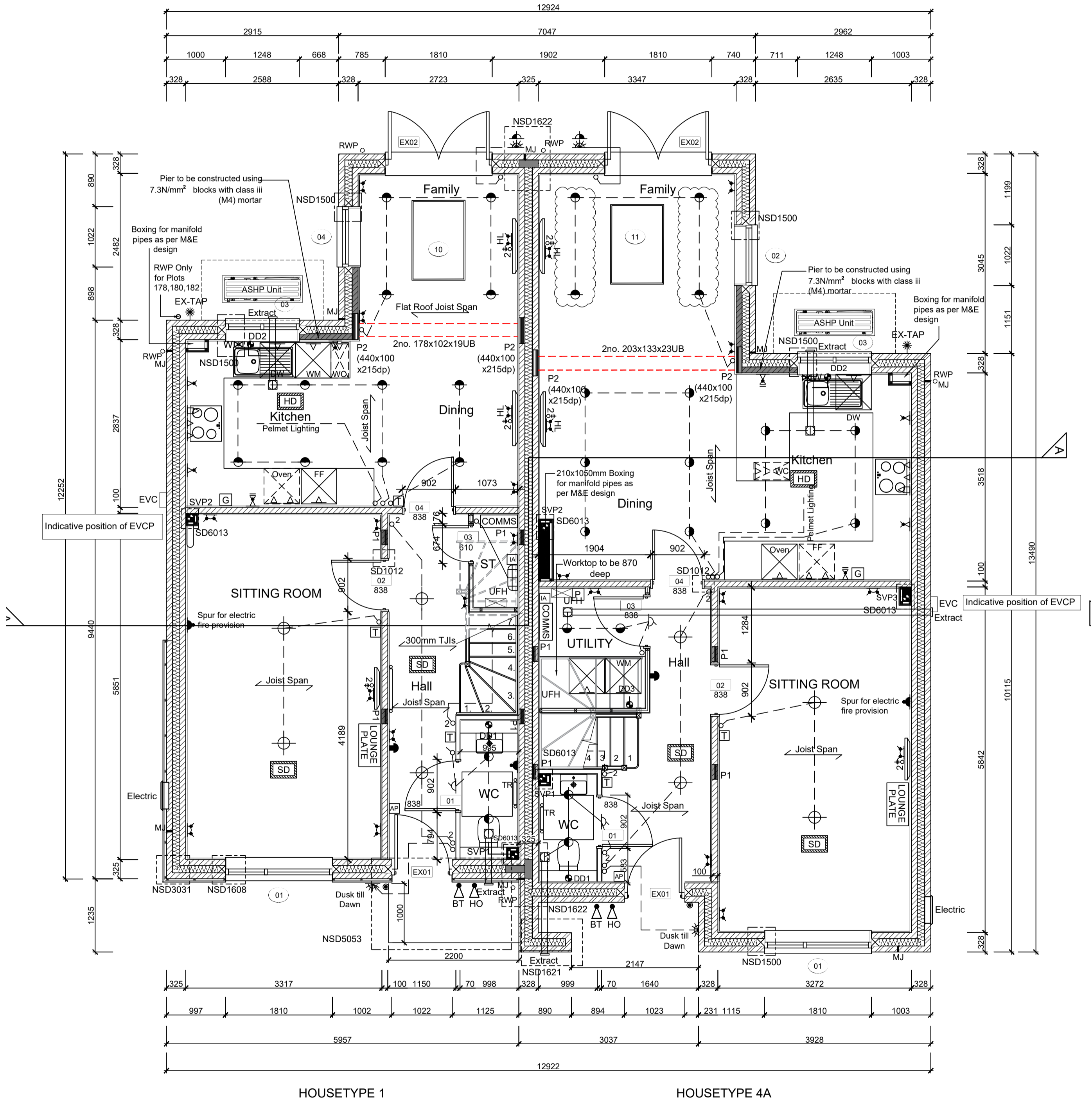

GROUND FLOOR LAYOUT
SCALE 1:50

R	18.10.25	Light switch to WC moved	LC
Q	08.08.25	HT4 Lights adjusted	ZJ
P	12.06.25	HT4 Grid & Program switch relocated Double	ZJ
		added, door handed, basin boxing removed	
		HT1 Grd & program switch relocated. TV point added	
		socket added, door handed	
O	17.04.25	Stairs amended as per specialist design	SK
N	20.02.25	HT4 UFH moved	ZJ
M	18.02.25	1/2 height boxing added for semi pedestal	ZJ
L	29.01.25	Incoming water position amended. Store door	SK
		amended to 610 single door.	
K	15.01.25	Kitchen coordinated with supplier layout, M&E coordinated. Sockets coordinated	DF
J	15.10.24	Detail Ref tags co-ordinated.	SK
Rev	Date	Description	Init.

Job title	
Brooklands College Weybridge	
Drawing title	
HT Semi 1A HT1 (Fir) & HT4(Laurel) Plots: 176/177 178/179 180/181 182/183 Ground Floor Plan	
Scale	Date
1:50 @ A1	May 2023
Rev.	Drawn
R	RR
Dwg No. SA00394-0151-A-SEMI1A-GA	