

INTERMITTENT EXTRACT VENTILATION: Kitchen = 30L/S Adjacent hob; Utility = 30L/S; Bathroom = 15L/S; En-Suites = 15L/S; Clk's = 6L/S
PURGE VENTILATION: All windows to habitable rooms to open more than 30 deg's. each habitable room to be provided with an operable window(s) with an opening area equal to 1/20th of the rooms floor area.

STAIRCASE - GRD-1st
14 equal risers of 205.14mm; Going = 234mm; Pitch 23.42°; Width over strings - 860mm
STAIRCASE - 1st-2nd
13 equal risers of 206.30mm; Going = 234mm; Pitch 23.42°; Width over strings - 860mm

ROOF VENTILATION (TYPE 1)
An impermeable roofing underlay (Type 1F / HR) is to be draped over all roof pitches, with Rytons OFV1000 (or similar approved) over fascia ventilator providing ventilation equivalent to a continuous 10mm opening at eaves level, and Glidevale Fulmetal Redirroll ventilated dry ridge system (or similar approved) providing ventilation equivalent to a continuous 5mm opening at ridge level.

PADSTONE SCHEDULE			
REF	LENGTH	DEPTH	WIDTH
P1	215	215	100
P2	440	215	100
P3	600	215	100

Padstones and steel beam sizes as per SE Drawings
Refer to specialist for joist sizes

GENERAL ARRANGEMENT PLANS - WALL LEGEND	
	Frost resistant quality facing brickwork 20N Brickwork laid in minimum class iii (M4) mortar.
	Calcon Standard blockwork to inner leaf only. Medium dense blockwork to outer leaf to be laid in minimum class iii (M4) mortar. Compressive strength 7.3N/mm² to the Ground Floor, minimum class iii (M6) mortar (unless otherwise noted) & 3.5N/mm² minimum class iii (M4) mortar (unless noted otherwise noted) to first/second floor & roof level.
	Note: All external wall cavities to be 125mm unless otherwise specified. 70mm British Gypsum Gyprock 70550 °C stud system, with studs at 600mm centres. 12.5mm Gyprock Soundbloc plasterboard each side with tapered edges, finished as per internal spec. Moisture-resistant plasterboard to bathroom with studs at 400mm centres.
	70mm Butressing Wall with 12mm Ply Sheathing as per SD3022. 12.5mm Gyprock Soundbloc plasterboard each side with tapered edges, finished as per internal spec. Moisture-resistant plasterboard to bathroom with studs at 400mm centres. 63x38mm timber studs @ max 600mm centres. 50mm looper acoustic partition roll (APR 1200) to be installed between studwork for the entire wall panel.
	Movement Joints
	Denotes the position of the external cavity fire Soc.
IMPORTANT NOTE: ALL EXTERNAL WALLS TO INCORPORATE BRICKFORCE SBF30W60 BED-JOINT REINFORCEMENT TO INNER LEAF OF BLOCKWORK 2x COURSES ABOVE & BELOW ALL OPENINGS & TO PROJECT A MIN. 600mm BEYOND OPENING.	

ELECTRICAL KEY	
This electrical legend is to be read in conjunction with the internal specification & M&E consultants details if applicable with any discrepancies being reported to the site manager. Doorbells, light switches, entryphones, etc. should be fixed no higher than 1200mm above FFL. TV, BT & power sockets should be fixed no lower than 450mm above FFL. All wall lights to be fitted at 2100mm above FFL.	
Symbol	Description
	Flush double switch socket.
	Flush double switch socket with 2 USB points.
	External socket.
	13A flush unswitched spur.
Where switches are located all in the same wall, use 2/3/4 gang switches.	

Symbol	Description
	Flush double switched socket 200mm above kitchen work top.
	13A Flush unswitched outlet 300mm below kitchen work top.
	Flush 30A cooker switch 200mm above kitchen work top.
	Gas point.
	Shower head & control position.
	Ceiling mounted extract fan.
	Isolator switch.
	Shaver socket.

Symbol	Description
	Carbon Monoxide Detector.
	Smoke Detector.
	Heat Detector.
	For sites with FTTP refer to SD/1002. For sites with FTTC refer to SD/1003.
	For full lounge plate specification refer to CALA Group Internal Specification.
	Intruder Alarm unit to Nacoss Standard
	Alarm Panel
For sites where virgin is to be provided, Virgin Media blanking plates are to be provided adjacent to the low level Lounge Plate in the lounge, and next to the TV/FM socket within the Family Room and Master Bedroom.	
	Pop up Socket for the Island
	External wall mounted Electric Meter
	British Telecom Point
	Hyper Optic Point
	Underfloor Heating Manifold

Notes
All dimensions to be checked on site prior to the commencement of construction and any discrepancy should be reported to the Site Manager.

This drawing may not be reproduced in any part or form without written consent.

All copyrights reserved.

Sub-Contractors MUST ensure that they have the latest issue drawing before they commence work on site.

This drawing is to be read in conjunction with all relevant Specifications, schedules and Engineers details.

RWP/MJ positions to be finalised on Architects drawings on an individual site by site basis

Meter positions to be finalised on Architects drawings on an individual site by site basis

Radiator positions shown as per M&E drawings. Sizing of radiators & towel rails are shown indicatively check M&E drawings for correct sizing.

Indicative postion of EVCP-
EVC:If remote,see External works drawing for position

Extract locations to be confirmed by Vectaire

R	08.08.25	WC/Utility wall updated to site measurement	ZJ
		Family room lighting adjusted	
Q	12.06.25	Relocated kitchen socket, added WC/Utility wall	DF
		setting out dimensions, add ex. light, grid switch moved	
		comms moved back to utility	
P	15.05.25	Kitchen door (04) handed. switches and thermostat relocated.Sockets moved,Utility door handed, Comms & sockets moved to gym, pop up, socket added.	SK
		duct for power to island added.	
O	14.04.25	Store Door amended to 610 door. Structural door opening amended.	SK
N	25.03.25	Utility & WC ventilation extract routes amended.	DF
M	06.02.25	Double socket added as per comments	SK
L	13.01.25	Kitchen coordinated with new supplier layout, M&E coordinated, sockets coordinated	SK
K	15.10.24	Detail Ref tags co-ordinated.	
J	16.09.24	Wall key amended	ZJ
I	12.09.24	Posts added for ex. stairs, staircase moved away from wall, ex. light relocated, BT/fibre relocated	SK
H	16.08.24	Ashp added. RWP added.	SK
Rev	Date	Description	Init.

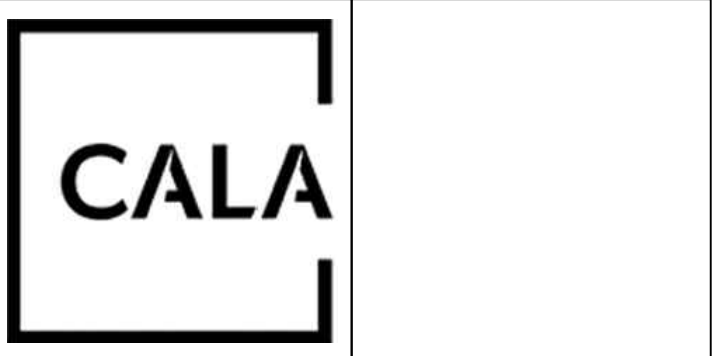

Job title

Brooklands College
Weybridge

Drawing title

House Type HT8A
4B7P Plots: 157,162
Ground Floor Plan

Scale
1:50 @ A1

Date
May 2023

Rev.
R

Drawn
RR

Dwg No.
SA00394-0601-A-HT8A-GA

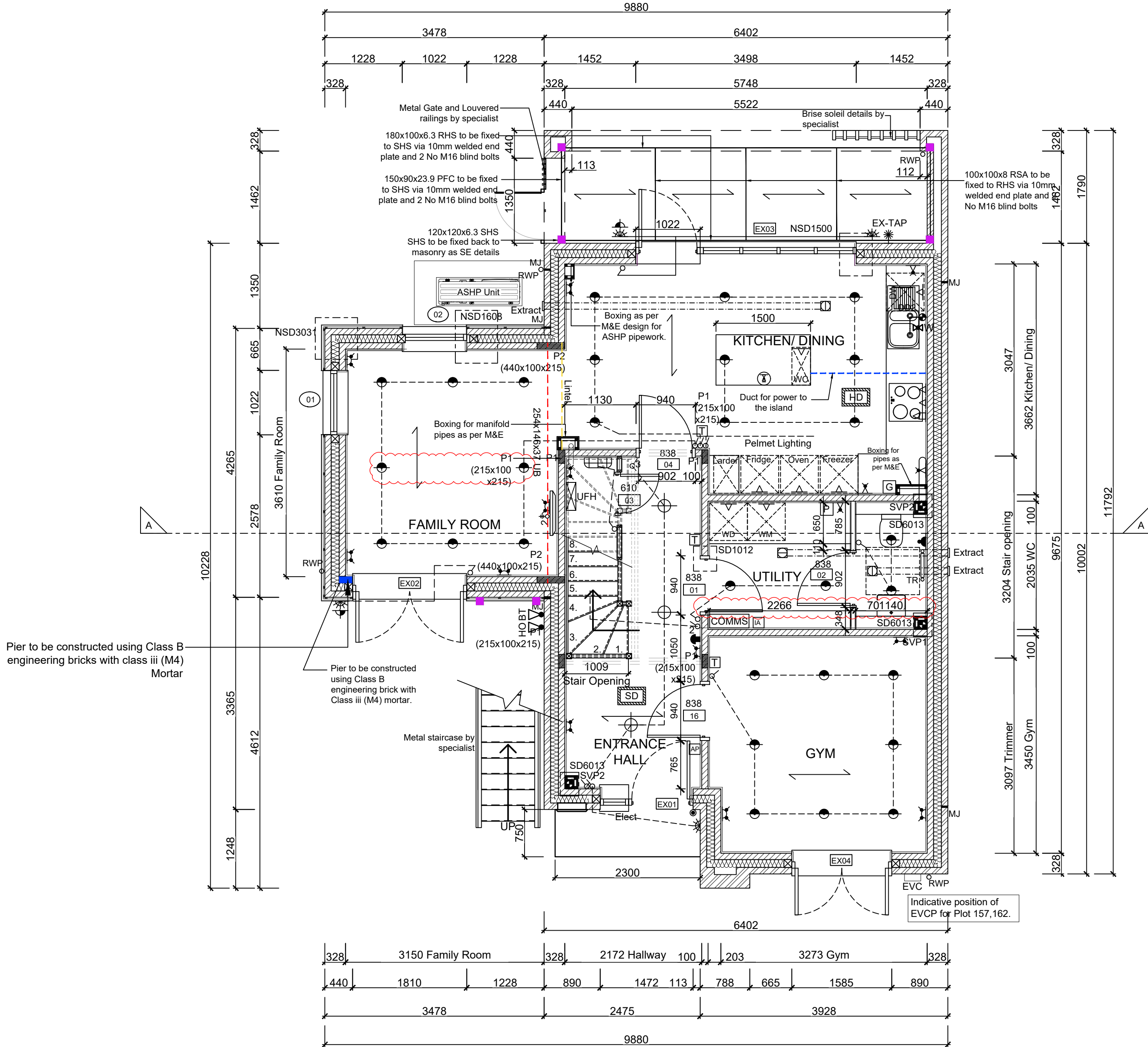

GROUND FLOOR LAYOUT
SCALE 1:50