

FOUNDATION LAYOUT FOR FROGMORE
1:50
(PLOT 84 ONLY)

PLOT NOS.	FFL	SSL	TOP OF FOUNDATION LEVEL	BTM. OF FOUNDATION LEVEL
84	168.020	167.795	167.195	AS SHOWN ON PLAN

ALL LEVELS T.B.C.

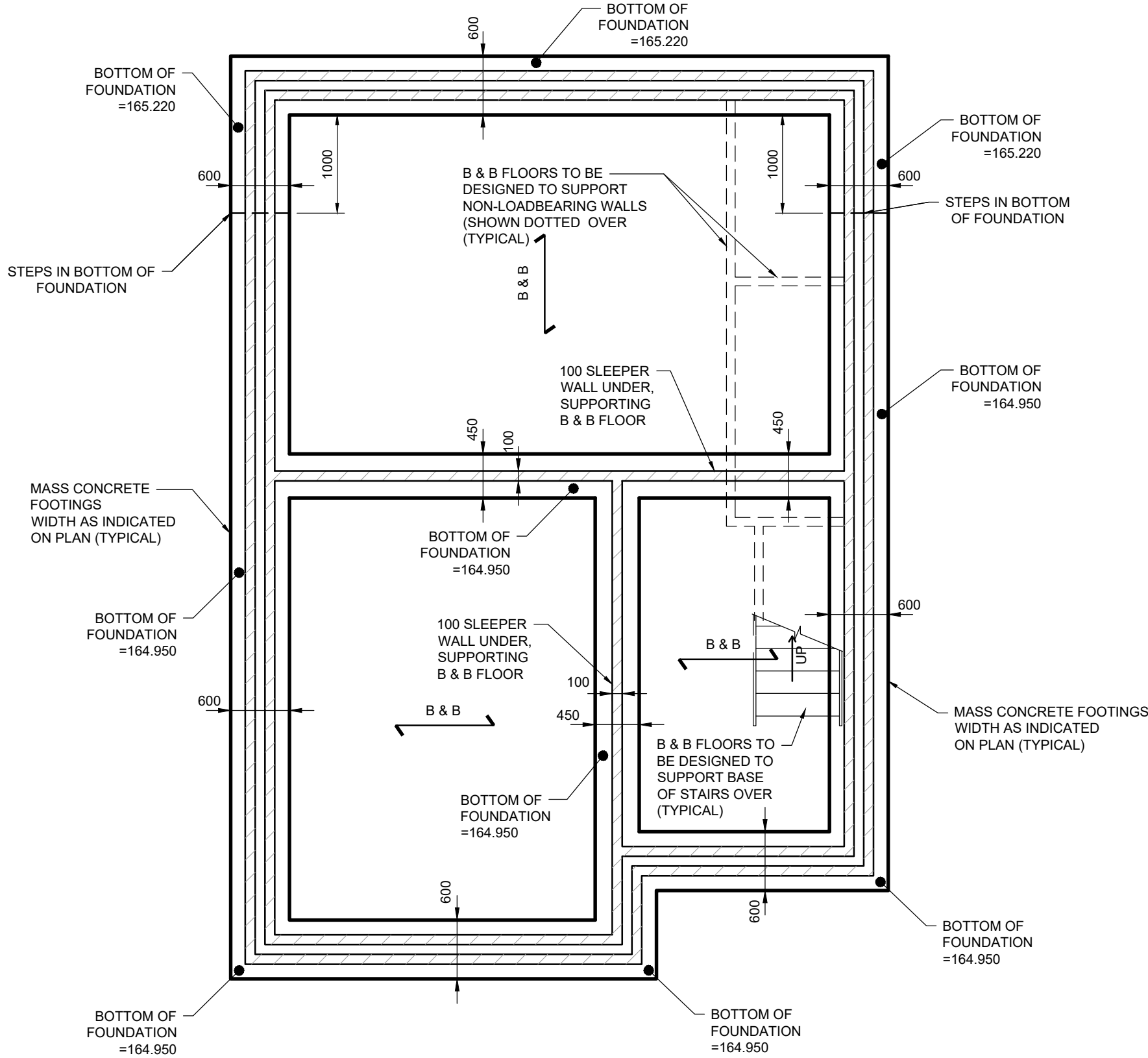

FOUNDATION LAYOUT FOR FROGMORE
1:50
(PLOT 61 ONLY)

PLOT NOS.	FFL	SSL	TOP OF FOUNDATION LEVEL	BTM. OF FOUNDATION LEVEL
61	166.270	166.045	165.445	AS SHOWN ON PLAN

B & B

HEAVY

LEGEND

GENERAL INTERNAL GROUND FLOOR:-
DENOTES SPAN OF SUSPENDED 150 DEEP PRESTRESSED CONCRETE BEAM AND STRUCTURAL EPS FLOOR OVER USING STRUCTURAL GRADE EPS AND 75 THICK STRUCTURAL CONCRETE GRADE RC32/40 TOPPING REINFORCED WITH A142 MESH WITH 40 COVER IN TOP

GARAGES AND BIN/CYCLE STORE FLOOR:-
DENOTES SPAN OF SUSPENDED 150 DEEP PRESTRESSED CONCRETE BEAM AND BLOCK FLOOR OVER USING STRUCTURAL GRADE TOP EPS INSULATION SHEET & 75 MIN. THICK STRUCTURAL CONCRETE GRADE RC32/40 TOPPING LAID TO FALLS REINFORCED WITH A142 MESH WITH 40 COVER IN TOP. MASONRY INFILL BLOCKS BETWEEN PC SLEEPER BEAMS TO HAVE A MINIMUM COMPRESSIVE STRENGTH OF 7N/mm².

REFER TO ARCHITECTS DRAWINGS FOR SETTING OUT AND GLOBAL POSITIONING OF ALL MASONRY WALLS SHOWN ON THIS DRAWING

REFER TO ARCHITECTS DRAWINGS FOR SIZE & POSITION OF ALL SERVICE HOLES AND SERVICES.

Do not scale from this drawing.

SAFETY HEALTH AND ENVIRONMENTAL INFORMATION

IN ADDITION TO THE HAZARD/RISKS NORMALLY ASSOCIATED WITH THE TYPES OF WORK DETAILED ON THIS DRAWING, NOTE THE FOLLOWING RISKS AND INFORMATION.

RISKS LISTED HERE ARE NOT EXHAUSTIVE. REFER TO DESIGN ASSESSMENT FORM NO.

CONSTRUCTION

DEMOLITION

FOR INFORMATION RELATING TO USE, CLEANING AND MAINTENANCE SEE THE HEALTH AND SAFETY FILE

IT IS ASSUMED THAT ALL WORKS WILL BE CARRIED OUT BY A COMPETENT CONTRACTOR WORKING, WHERE APPROPRIATE, TO AN APPROVED METHOD STATEMENT.

NOTES

- DO NOT SCALE THIS DRAWING. WORK TO FIGURED DIMENSIONS ONLY. ALL DIMENSIONS ARE IN MILLIMETRES (mm). ALL LEVELS IN METRES (m).
- THIS DRAWING TO BE READ IN CONJUNCTION WITH AND CHECKED AGAINST ALL OTHER RELEVANT ARCHITECTS, ENGINEERS AND SPECIALISTS DRAWINGS, SPECIFICATIONS & CONTRACT DOCUMENTS.
- CONFIRM ALL LEVELS, DIMENSIONS, DETAILS ETC, BEFORE WORK COMMENCES AND REPORT ANY DISCREPANCIES OR OMISSIONS IMMEDIATELY.
- ALL WORK & MATERIALS TO COMPLY WITH THE RELEVANT BRITISH STANDARDS, CODES OF PRACTICE AND THE BUILDING REGULATIONS.
- THE ENGINEER IS TO BE INFORMED IF ANY DETAIL INDICATED OR IMPLIED ON THIS DRAWING CAN NOT BE MAINTAINED.
- FOR SETTING OUT OF WALLS, STRUCTURAL OPENINGS AND SERVICE HOLES REFER TO ARCHITECT'S DRAWINGS.
- ALL DPC's, DPM's, INSULATION, CAVITY BARRIERS, WALL AND FLOOR FINISHES TO ARCHITECT'S DETAILS. PROVIDE AIR VENTS/BRICKS AT CENTRES TO SUIT ARCHITECT'S DETAILS TO INTERNAL AND EXTERNAL WALLS TO ALLOW CROSS VENTILATION.
- THE CONTRACTOR SHALL ENSURE THAT STABILITY OF THE BUILDING AND ADJACENT PREMISES IS MAINTAINED AT ALL STAGES OF CONSTRUCTION. COMPETENT SPECIALIST SUB-CONTRACTORS SHALL DESIGN, INSTALL AND MAINTAIN ALL NECESSARY TEMPORARY WORKS AND PROGRAMME THE JOB ACCORDINGLY IN A SAFE MANNER.
- FOR LOCATION OF SERVICES THROUGH FLOOR AND WALLS REFER TO ARCHITECTS /SERVICE ENGINEERS DETAILS.
- ALL FOUNDATION DEPTHS ARE TO BE AS NOTED BUT ARE SUBJECT TO FINAL INSPECTION ON SITE BY QUALIFIED GEO/TECHNICAL ENGINEER/ NHBC INSPECTOR TO CONFIRM FOUNDING LEVELS ARE OK. IF ACTIVE ROOT GROWTH IS APPARENT AT FOUNDING LEVEL THEN THE FOUNDATION MUST BE DEEPENED TO EXTEND AS SPECIFIED IN OUR GENERAL NOTES DRAWING DRG. NO. 152987-SCC-FRH-XX-XX-DR-S-010
- WHERE A FOUNDATION PASSES CLOSE TO A SEWER, DRAIN TRENCH OR TRIAL PIT THE FOUNDATION IS TO BE SUCH THAT ITS UNDERSIDE IS BELOW A LINE PROJECTED UP AT 45° FROM THE NEAREST BOTTOM CORNER OF THE DRAIN TRENCH, SEWER OR TRIAL PIT.

P02	16.08.24	LEVELS UPDATED	IS	PL	PL
P01	12.09.23	ISSUED FOR TENDER		PL	PS
Rev.	Date	Description	Drwn.	Chkd.	Appd.

FAIRHURST

SUITE A
OAK HOUSE
LONDON ROAD
SEVENOAKS
TN13 1AF

Tel: 01732 460 142
sevenoaks@fairhurst.co.uk

Client:

DANDARA LTD.

Project Title:

STEEL CROSS,
CROWBOROUGH,
EAST SUSSEX

Drawing Title:

FROGMORE
SUBSTRUCTURE G.A. PLAN
PLOTS 61,84
(OPTION 2)

Scale at A1: 1:50	Status: TENDER	
Drawn: JM	Checked: PL	Approved: PS
Date: AUGUST 2023	Date: SEPTEMBER 2023	Date: SEPTEMBER 2023

Drawing No.: 152987-SCC-FRH-XX-FN-DR-S-4131	Revision: P02
--	------------------