

DO NOT SCALE DRAWING

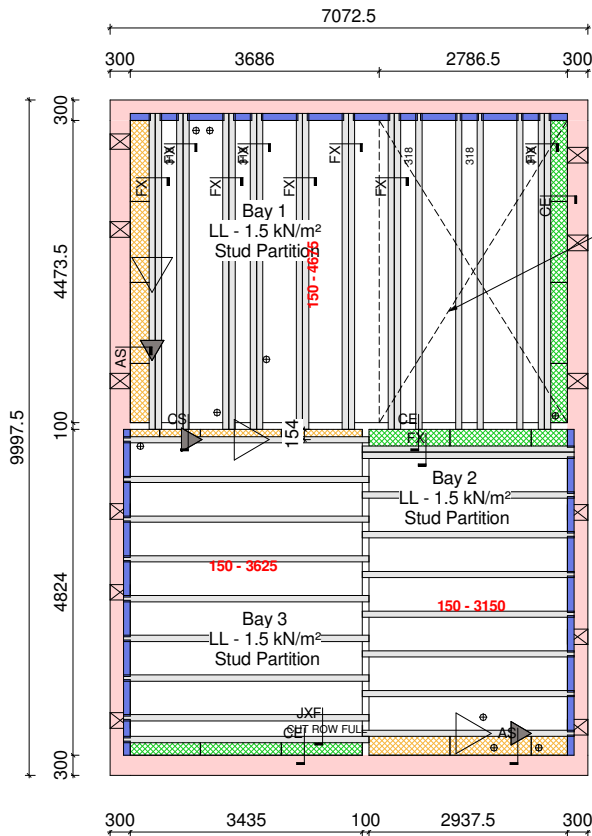

Installation Guide

Please Note: No allowances have been made on this design for additional loading out of infill blocks or other ancillaries. If this is required, you MUST contact Litecast for loading out advice PRIOR to doing so. Failure to do so may result in damage to structural integrity of the floor.



All partitions not supported off a footing below are assumed to be 1.2kN/m² Max. Non-load bearing studding.

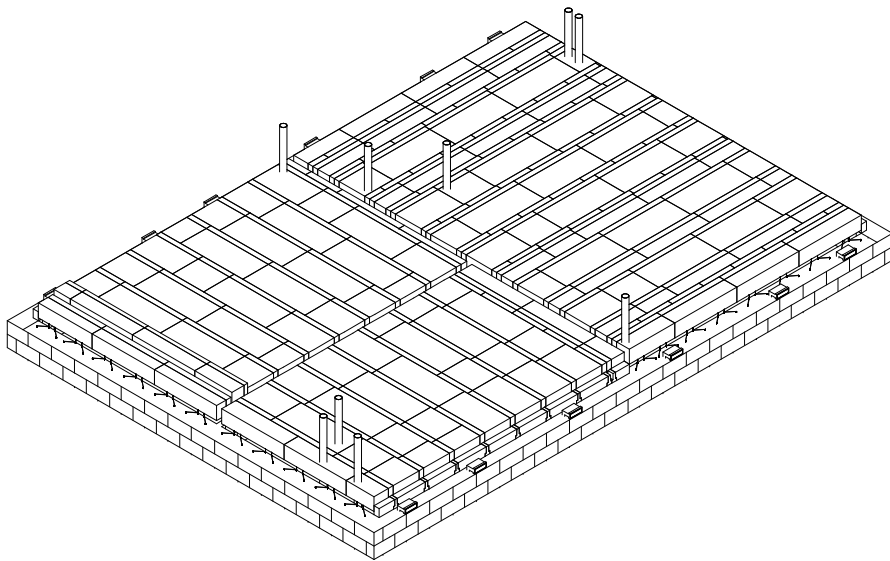

CUTTING PANELS TO SIZE FOR USE IN FLOOR

MUST BE CUT FROM FULL (540mm) PANEL

ONE SIDE TO BE USED AS STARTER PANEL. CUT EDGE SHOWN IN RED TO BE PLACED AGAINST WALL ON OPTIONAL EDGE SUPPORT CLIPS

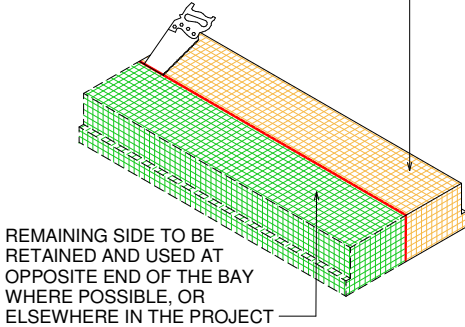

CUTTING FOR START/END

PANELS SHOULD BE CUT TO SUIT USING MEASUREMENTS TAKEN ON SITE.

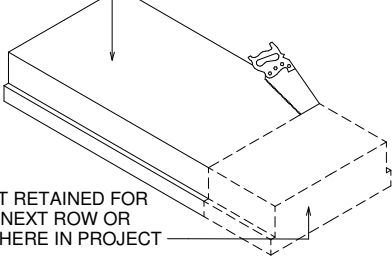

CUTS SHOULD NOT RESULT IN PANELS SMALLER THAN 300MM, AS THESE ARE NOT PERMITTED. EG. IF A 1000MM SECTION IS REQUIRED, IT SHOULD BE ACHIEVED BY CUTTING ONE PANEL TO 600MM AND ANOTHER TO 400MM. THIS AVOIDS CREATING AN UNUSABLE 200MM OFFCUT. EACH COMBINATION MUST ALWAYS INCLUDE ONE PANEL OF 600MM.

CUTTING TO SIZE FOR ROW

Two beams with multi rail

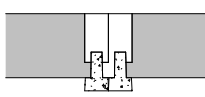

SECTION FX

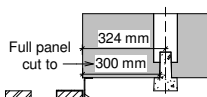

SECTION AS

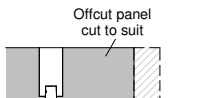

SECTION CE

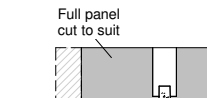

SECTION CS

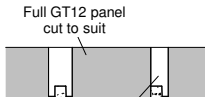

SECTION JXF

Drawing Legend

Joist Start Layout Point Poly Start Layout Point

150mm Joist

Service Hole Position

Suggested Void Ventilator Position. Those with V graphic have Vertical Ext. Thru' vents by builder.

Closure Block
All closure blocks to be bedded. All internal bearing channels must be concrete filled before screed is applied. Shuttering may be required for GT12 and GT18.

Starter Panel - Cut from FULL PANEL as indicated on design/section.

End Panel - Cut from FULL PANEL or off cut of Starter Panel as indicated on design/section.

Closure Blocks are only included for around the perimeter, as is highlighted on our design. If you would like additional Closure Blocks for internal walls, please contact Litecast.

PLEASE NOTE:

Sections should be used to determine panel type for cut rows and all edges are created using full (540mm) panels.

Section Details shown are auto generated and may not reflect situation on site.

Ancillaries Schedule		
Product Code	Description	Count
ANC-GT12F	GT12 540mm Infill Panel	76
ANC-GT12H	GT12 270mm Infill Panel	19
ANC-GT12MR	GT12 Multi Beam Rail	65
ANC-ESCGT12	GT12 Edge Support Clip	38
ANC-PES	Poly Edge Strip	60
ANC-LCB	100mm Large Closure Block	26
ANC-SCB	100mm Small Closure Block	5
ANC-AB1	Air-Brick TERRA	12
ANC-UV	Telescopic U/Floor Vent	12

Joist Schedule				
Description	Joist Length	Bay Id	Count	
150mm Floor Joist	4675	1	20	
150mm Floor Joist	3150	2	9	
150mm Floor Joist	3625	3	9	

Vent flow rates achieved

6450	mm² Capacity
2439	mm²/m P (1500mm²/m MIN)
1271	mm²/m² A (500mm²/m² MIN)

PANELS ON THIS DESIGN ARE

GT12 Yellow Label

THERMAL VALUES

PERIMETER/AREA VALUE - 0.521

TARGET U VALUE - 0.15 ACTUAL U VALUE - 0.11

b	Additional vents added and repositioned as requested	DB	14/04/25
a	Design previously estimated, drawing produced to site specific plans	DB	01/04/25

REV	DESCRIPTION	INI	DATE
-----	-------------	-----	------

TOTAL LENGTHS AND AREA		
150mm - Length	225mm - Length	Floor Area
154.475 m	0.000 m	60 m²

DESIGN CRITERIA (WHERE APPLICABLE)

FINISHES - 1.8kN/m² 75mm Steel Fibre/Mesh Reinforced Concrete Screed
LIVE LOAD (LL) - Refer To Bay Tag For Loads
OTHER INFILLS - EPS Panel
PARTITIONS - 1.2kN/m² Non Load Bearing Stud
PARTITIONS - 3kN/m Non Load Bearing Block

HOUSE TYPE
Reedmaker

SITE ADDRESS
St Nicholas Park, Forster Park
Off North Road
Stevenage
SG1 4DE

Litecast Unit 1 Pulney Chase Industrial Est. Pulney Lane, Hemel Hempstead, HX10 0RG Tel: +02476 356161	DRAWN BY david@litecast.co.uk	DATE 13/01/2025
	DRG NO. 241714-41-GT12	REV b