

DO NOT SCALE DRAWING

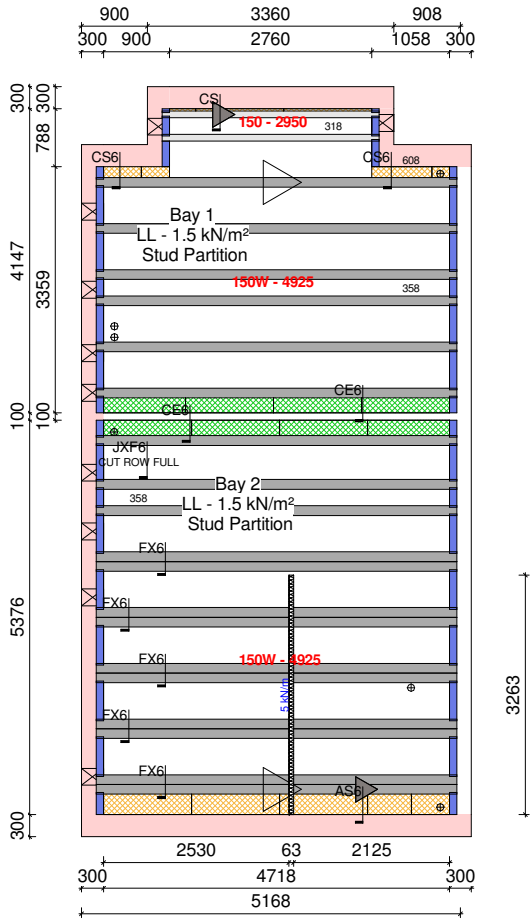

Installation Guide

Please Note: No allowances have been made on this design for additional loading out of infill blocks or other ancillaries. If this is required, you MUST contact Litecast for loading out advice PRIOR to doing so. Failure to do so may result in damage to structural integrity of the floor.



All partitions not supported off a footing below are assumed to be 1.2kN/m² Max. Non-load bearing studding.

### Drawing Legend

- Joist Start Layout Point
- Poly Start Layout Point
- 150mm Joist
- 150mm Wide Joist
- Service Hole Position
- Suggested Void Ventilator Position. Those with **V** graphic have Vertical Ext. Thru' vents by builder.
- Non Load Bearing Blockwork MAX Load (kN/m) Shown On Design
- Non Load Bearing Studwork MAX Load (kN/m) Shown On Design
- Closure Block
- All closure blocks to be bedded. All internal bearing channels must be concrete filled before screed is applied. Shuttering may be required for GT12 and GT18.
- Starter Panel - Cut from **FULL PANEL** as indicated on design/section.
- End Panel - Cut from **FULL PANEL** or off cut of Starter Panel as indicated on design/section.
- 318 150mm Floor Joists with 270mm poly panel between (Poly).
- 358 150mm Wide Floor Joists with 270mm poly panel between (Poly).
- 608 150mm and 150mm Wide Floor Joists with 540mm poly panel between (Poly).

### CUTTING PANELS TO SIZE FOR USE IN FLOOR

#### MUST BE CUT FROM FULL (540mm) PANEL

ONE SIDE TO BE USED AS STARTER PANEL. CUT EDGE SHOWN IN RED TO BE PLACED AGAINST WALL ON OPTIONAL EDGE SUPPORT CLIPS

REMAINING SIDE TO BE RETAINED AND USED AT OPPOSITE END OF THE BAY WHERE POSSIBLE, OR ELSEWHERE IN THE PROJECT

#### CUTTING FOR START/END

PANELS SHOULD BE CUT TO SUIT USING MEASUREMENTS TAKEN ON SITE.

OFFCUT RETAINED FOR USE IN NEXT ROW OR ELSEWHERE IN PROJECT

CUTS SHOULD NOT RESULT IN PANELS SMALLER THAN 300MM, AS THESE ARE NOT PERMITTED. EG. IF A 1000MM SECTION IS REQUIRED, IT SHOULD BE ACHIEVED BY CUTTING ONE PANEL TO 600MM AND ANOTHER TO 400MM. THIS AVOIDS CREATING AN UNUSABLE 200MM OFFCUT. EACH COMBINATION MUST ALWAYS INCLUDE ONE PANEL OF 600MM.

#### CUTTING TO SIZE FOR ROW

Two beams with multi rail

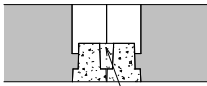

SECTION FX6

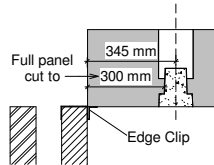

SECTION AS6

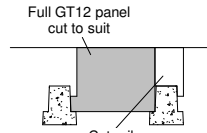

SECTION JXF6

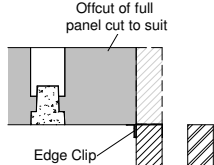

SECTION CE6

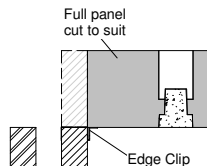

SECTION CS6

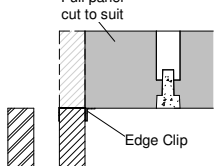

SECTION CS

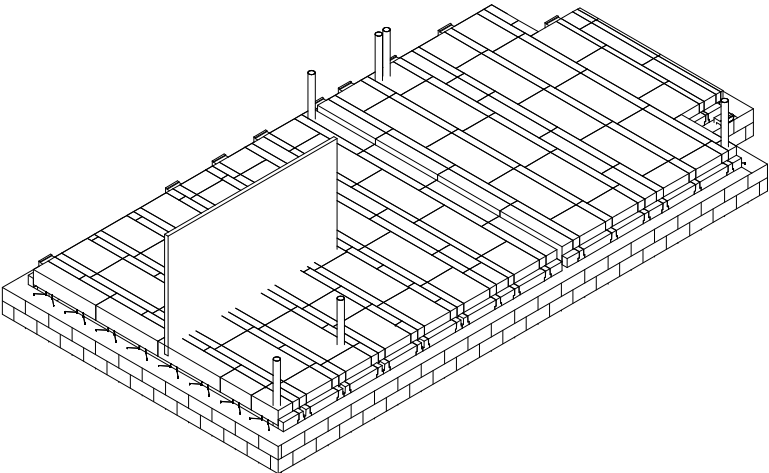

### PLEASE NOTE:

Sections should be used to determine panel type for cut rows and all edges are created using full (540mm) panels.

Closure Blocks are only included for around the perimeter, as is highlighted on our design. If you would like to add additional Closure Blocks for internal walls, please contact Litecast.

Ancillaries Schedule GT11		
Product Code	Description	Count
ANC-GT11F	GT11 540mm Infill Panel	5
ANC-GT11H	GT11 270mm Infill Panel	3
ANC-GT112F	GT112 540mm Infill Panel	49
ANC-GT112H	GT112 270mm Infill Panel	8
ANC-GT112MR	GT112 Multi Beam Rail	20
ANC-GT122F	GT122 540mm Infill Panel	4
ANC-ESCGT11	GT11 Edge Support Clip	34
ANC-PES	Poly Edge Strip	40
ANC-LCB	100mm Large Closure Block	27
ANC-SCB	100mm Small Closure Block	7
ANC-AB1	Air-Brick TERRA	10
ANC-UV	Telescopic U/Floor Vent	10

Joist Schedule			
Description	Joist Length	Bay Id	Count
150mm Floor Joist	2950	1	2
150mm Floor Joist (Wide)	4925	1	6
150mm Floor Joist (Wide)	4925	2	13

Vent flow rates achieved	
6450	mm² Capacity
3253	mm²/m P (1500mm²/m MIN)
1470	mm²/m² A (500mm²/m² MIN)

PANELS ON THIS DESIGN ARE

GT11	Blue Label	Cut Panels GT12 (If Required)	Yellow Label
------	------------	-------------------------------	--------------

THERMAL VALUES			
PERIMETER/AREA VALUE - 0.452			
TARGET U VALUE - 0.15 ACTUAL U VALUE - 0.11			

b	Additional vents added and repositioned as requested	DB	14/04/25
a	Design previously estimated, drawing produced to site specific plans	DB	02/04/25

REV	DESCRIPTION	INI	DATE
-----	-------------	-----	------

TOTAL LENGTHS AND AREA		
150mm - Length	225mm - Length	Floor Area
99.475 m	0.000 m	43 m²

DESIGN CRITERIA (WHERE APPLICABLE)  
FINISHES - 1.8kN/m² 75mm Steel Fibre/Mesh Reinforced Concrete Screed  
LIVE LOAD (LL) - Refer To Bay Tag For Loads  
OTHER INFILLS - EPS Panel  
PARTITIONS - 1.2kN/m² Non Load Bearing Stud  
PARTITIONS - 5kN/m Non Load Bearing Structural Stud

HOUSE TYPE Webster

SITE ADDRESS  
St Nicholas Park, Forster Park  
Off North Road  
Stevenage  
SG1 4DE

	DRAWN BY	DATE
	david@litecast.co.uk	02/04/2025
Unit 1 Purley Chase Industrial Est. Purley Lane, Horsham, W Sussex, GU10 0RG Tel : 02476 356161	DRG NO.	REV
	241714-45-GW11	b