

Cut line see drawing 4200573-DUNM-2005-Sheet 5

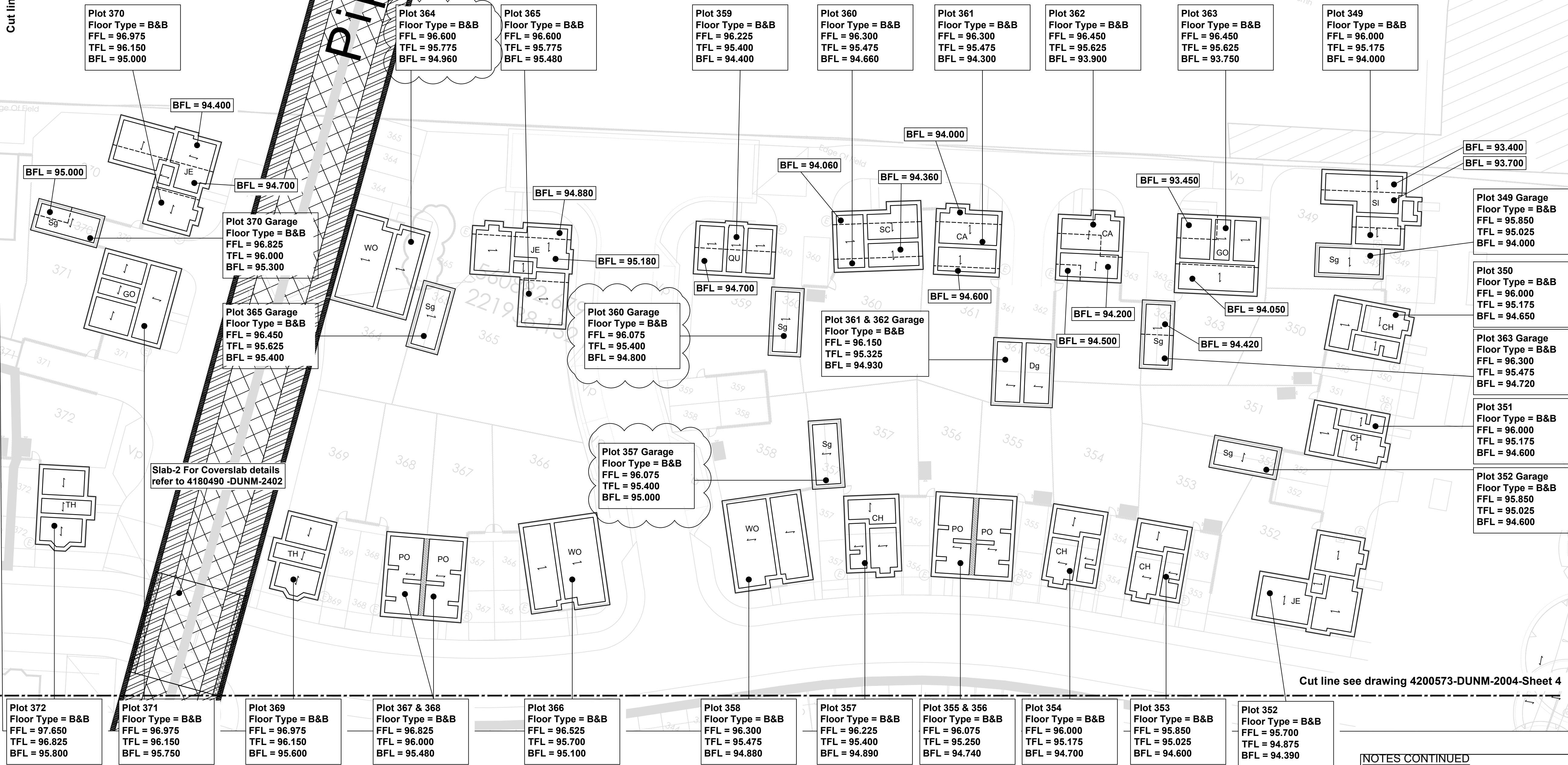

Pipe Line Easement



Foundation Layout Plan

Scale 1:250

Residual Hazards Identified	
Item	Description
	Blockwork to not exceed 20kg per unit

Note: The information on this drawing does not account for any buried services. Contractor is to obtain services information prior to commencement of works. Report to SE if any buried services clash with excavations / proposed foundation location.

Note: a) This drawing is based on planning drawing layout drawing BW193FULL\_PL\_02\_00  
b) Levels have been taken from drawing 194538-EXTERNAL LEVELS

KEYPLAN:  
N.T.S.



NOTES

- This drawing is to be read in conjunction with all relevant drawings documents & specifications.
- Dimensions not to be scaled.
- Any discrepancy between drawings of different scales, and between drawings and specification where appropriate to be notified to the Engineer for decision.
- For General Notes refer to drawing: 4200573-DUNM-2000.
- For Typical Sections refer to drawing: 4200573-DUNM-2400-Sheet 1 & 4200573-DUNM-2401-Sheet 2.
- All levels to be confirmed by Architect prior to commencement of works.
- For setting out information, refer to Architects / Civil Engineers drawings.
- For brick and blockwork setting out dimensions & location of services, refer to Architects drawings.

LEGENDS

	Span direction of beam and block floor
	450mm wide footing
	600mm wide footing
	750mm wide footing
	900mm wide footing
	Foundations Level separator (Tree influence)
	Step
	Single Door Garage
	Double Door Garage
	Triple Door Garage
	Beam & Block
	Chandler
	Quilter
	Goldsmith
	Carver
	Dunmow
	Silversmith
	Baker
	Thespian
	Halstead
	Tillman
	Philosopher
	Potter
	Jeweller
	Woodcarver
	Sculptor
	Apartment
	Cartographer
	Ploughwright
	Plot Number
	Finished Floor Level
	Top of Foundation Level
	Bottom of Foundation Level

T1	TENDER	FEB 21	JF
C1	APPROVED FOR CONSTRUCTION	APR 21	JF
C2	BFL MODIFIED (PLOT NO.370, 365, 359, 360, 361, 362, 363, 349)	MAY 21	JF
C3	LEVELS MODIFIED (PLOT NO. 364 & GARAGE NO. 357, 360)	MAY 21	JF
Rev.	Description	Date	Chkd

**Glanville**  
Cornerstone House  
62 Foxhall Road, Didcot  
Oxon, OX11 7AD  
Tel: (01235) 515550 Fax: (01235) 817799  
postbox@glanvillegroup.com www.glanvillegroup.com

Client : **Bellway**

Project :  
**LAND NORTH OF STORTFORD ROAD, GREAT DUNMOW**

Title : <b>Foundation General Arrangement Sheet 6 of 6</b>	
Project Engineer : EC	Scale : 1:250
Project Director : JF	Date : MAY 2021
Status : APPROVED FOR CONSTRUCTION	

Drawing No.4200573-DUNM-2006-Sheet 6

Rev C3

NOTES CONTINUED

- For finishes, DPC/DPM, insulation etc. refer to Architects details.
- All retaining structures where BFL is not marked are gravel boards to Civil Engineer/Architect details.
- Foundations must be deepened where tree roots are visible on the sides or bottom of trenches. Contractor to seek advice from S.E. regarding the foundation depth if the above situation is encountered.
- For retaining wall details refer to Standard Bellway drawings.