

DO NOT SCALE

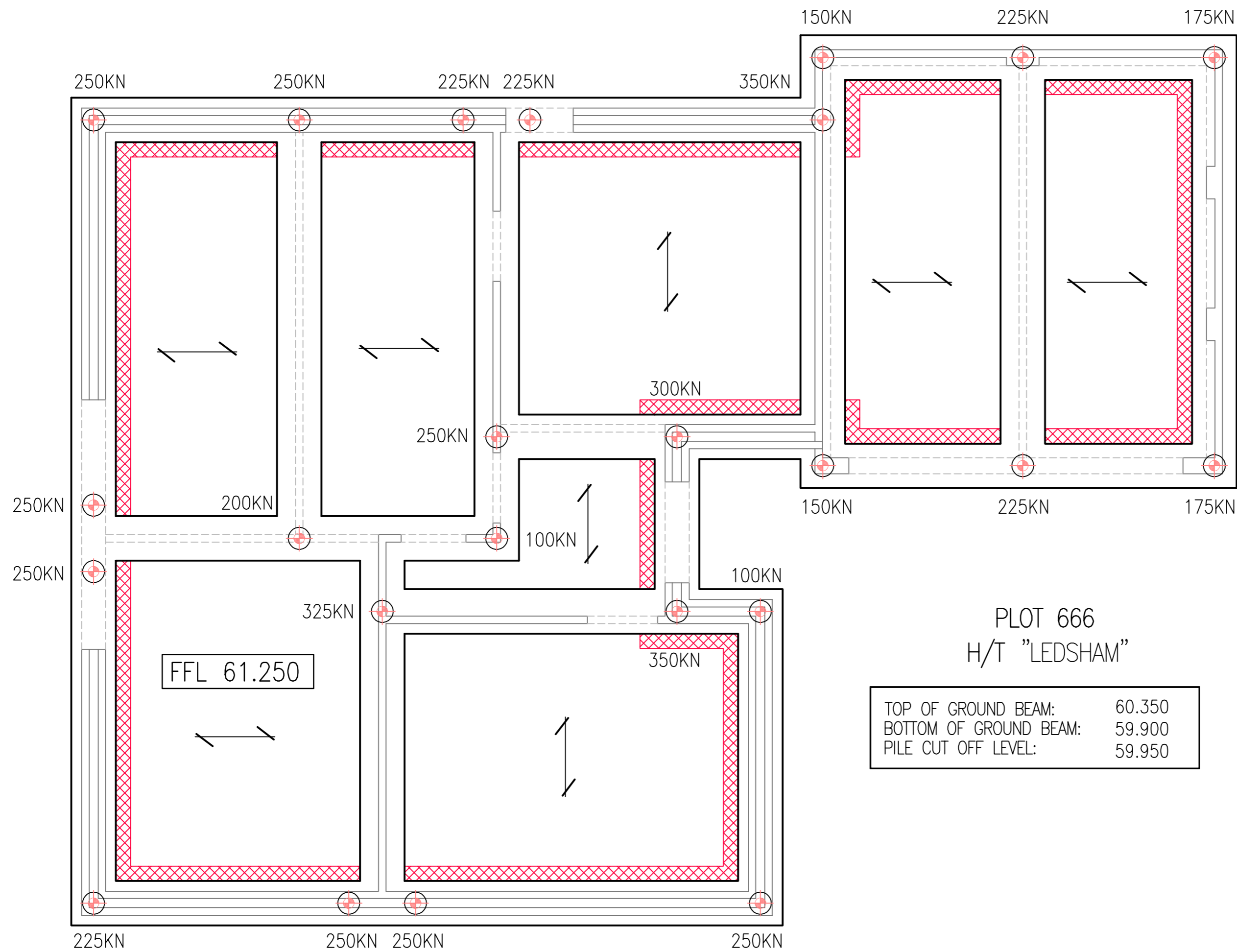

PLOT 666  
H/T "LEDHAM"

TOP OF GROUND BEAM:	60.350
BOTTOM OF GROUND BEAM:	59.900
PILE CUT OFF LEVEL:	59.950

PILE AND GROUND BEAM NOTES

- THIS DRAWING IS TO BE READ IN CONJUNCTION WITH ALL RELEVANT ARCHITECT'S, ENGINEER'S & SUB-CONTRACTORS DRAWINGS AND DETAILS AND THE PROJECT SPECIFICATION.
- SETTING OUT TO BE IN ACCORDANCE WITH THE ARCHITECT'S DRAWINGS AND RELEVANT DETAILS.
- GROUND BEAM CONCRETE TO BE MINIMUM GRADE RC28/35 (DS-3, AC-2s).
- ALL GROUND BEAMS TO BE SHUTTERED USING BRC PECAFILL OR EQUIVALENT PERMANENT FORMWORK, UNLESS GROUND CONDITIONS PROVIDE SUITABLE STABILITY OF TRENCH SIDES.
- EXCAVATIONS SHALL BE TRIMMED, LEVELED, PROTECTED AND KEPT FREE OF WATER.
- 50mm CONCRETE BLINDING TO BE PROVIDED BELOW ALL GROUND BEAMS.
- REINFORCED CONCRETE SHALL BE COMPACTED BY MEANS OF A MECHANICAL VIBRATING POKER AND THE WORKABILITY SHALL BE SUCH THAT, WHEN COMPACTED, A DENSE CONCRETE, FREE FROM VOIDS SHALL BE PRODUCED.
- THE CONTRACTOR IS RESPONSIBLE AND LIABLE FOR ENSURING THE STABILITY OF THE WORKS AT ALL STAGES OF CONSTRUCTION.
- THE CONTRACTOR IS RESPONSIBLE FOR LOCATING AND MAKING ALLOWANCE FOR ALL BELOW GROUND DRAINAGE AND SERVICES
- PILE CONCRETE GRADE TO BE DETERMINED BY THE PILE DESIGNER/SPECIALIST.
- PILE LOADS SHOWN ARE UN-FACTORED IN KILONEWTONS (KN).
- PILES TO BE DESIGNED BY A SPECIALIST TO ACCOMMODATE THE LOADS SHOWN, THE GROUND CONDITIONS RECORDED IN THE GI, ALONG WITH SUITABLE ALLOWANCE FOR GROUND HEAVE.
- PILES TO BE DESIGNED FOR A HORIZONTAL LOAD OF 10KN
- LOAD TESTING REGIME AND FACTOR OF SAFETY TO BE AGREED WITH THE ENGINEER AND BUILDING CONTROL. ALL PILES MUST BE 100% INTEGRITY TESTED.
- PILES MUST BE POSITIONED CENTRALLY BELOW GROUND BEAMS UNLESS NOTED OTHERWISE.
- ALL PILES MUST BE CAST MIN 300mm ABOVE THE CUT OFF LEVELS AND THEN BROKEN DOWN TO THE LEVELS INDICATED ON THE DRAWINGS
- PILES ARE TO BE LEFT IN A SOUND CONDITION WITH THE REINFORCEMENT PROJECTING MIN 40 X BAR DIAMETER ABOVE THE STATED CUT OFF LEVEL. PILE REINFORCEMENT TO BE TURNED INTO GROUND BEAMS CAGES AND LAPPED WITH TOP REINFORCEMENT.
- PILES HAVE BEEN DESIGNED ON A MAXIMUM DEVIATION POSITION OF 75mm ANY PILES OUT OF POSITION GREATER THAN 75mm TO BE REPORTED TO THE ENGINEER IMMEDIATELY.
- PILE HEAD TO HAVE A MINIMUM EMBEDMENT OF 50mm INTO GROUND BEAMS AND 75mm INTO PILE CAPS.
- THE MAXIMUM VERTICAL SETTLEMENT OF THE PILE IS NOT TO EXCEED 10mm.

T1	TENDER ISSUE	PB	02.06.23
MK	REVISION	BY	DATE

DRAWING STATUS

TENDER

DRAWING TITLE

PLOT 666 LEDSHAM  
(8688G\_LEDH\_DM.1) PILE  
& GROUND BEAM LAYOUT

PROJECT

NETHERMAYNE,  
PHASE 4B  
FOR  
REDROW HOMES



Unit B10  
Elmbridge Court Business Park  
Gloucester GL3 1JZ  
T: 01452 309 727  
E: mail@simpsoneng.com  
W: www.simpsoneng.com



London, Henley-on Thames, Gloucester and Exeter

Drawn PB	Ch'kd MH	Scales 1:50	Date JUN'23
Purpose of Issue TENDER ISSUE			
Project Number P21-508	Drawing Number P666	Revision T1	