

PLEASE CHECK ALL DIMENSIONS AND BEAM LENGTHS
DETAILED IN THE FLOOR SCHEDULE LOCATED ON THE
RIGHT HAND SIDE OF THE DRAWING. IF NO CHANGES
ARE REQUIRED PLEASE SIGN, PRINT AND DATE
BELOW.

SIGN
PRINT
DATE

Imposed Load
1.5 kN/m²
Lightweight Partitions
1.0 kN/m²

Finishes
Re-Inforced Concrete Topping 75mm 1.80 kN/m²

Floor Schedule

155 BEAM TP							
Bay	No	Typ	Loth	Bay	No	Typ	Loth
1	11	3	3600	2	11	3	2350
3	11	3	3700				

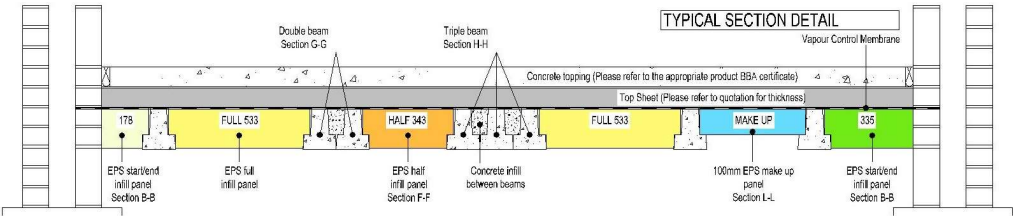
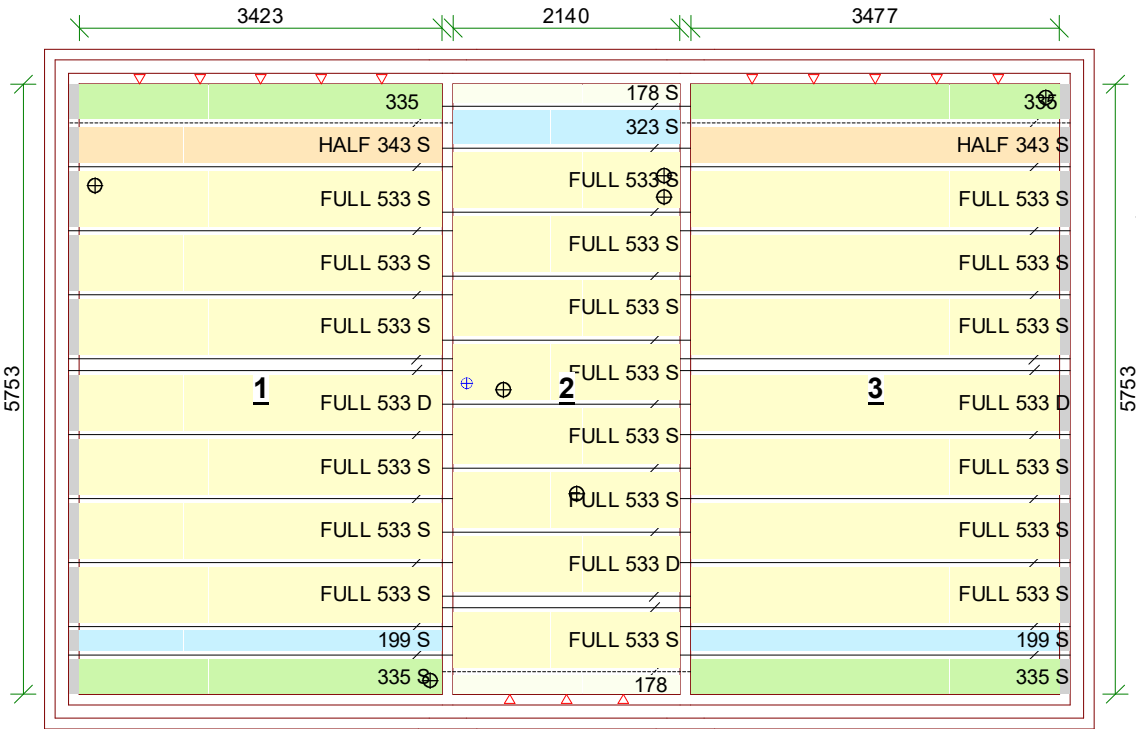

T-CLOSURE BLOCKS ALLOWED FOR IN AREAS DETAILED WITH GREY HATCHING ONLY. REMAINING WALLS ARE TO BE INFILLED/BUILT UP BY OTHERS.

DWELLING 530 x 100mm - 20
340 x 100mm - 2
530 x 140mm -
340 x 140mm -

GARAGE 440 x 100mm -
210 x 100mm -

Blocks
Jablite Structural Board 47m² nett

Floor Area	Floor Length	Floor Weight
52.50 m ²	106.15 m	3.27 tonnes

Client REDROW HOMES - G SERIES
Job Title AMBERLEY_JABLITE_EG_AMBY_DM_REV A
Site

Scale N/A
Drawn By PH
Date 31/07/2023

Address
UNIT A,RUDFORD INDUSTRIAL
ESTATE, FORD ROAD,
FORD, NR ARUNDEL,
WEST SUSSEX
BN16 9DQ



Drawing No Drawing JB- 2020 - 15 GF191.P03 -